

Leicester Planning Board

APPROVAL UNDER THE SUBDIVISION CONTROL LAW NOT REQUIRED
CH 41 S 81L.

DATE OF APPROVAL:

DATE OF ENDORSEMENT:

RESERVED FOR REGISTRY USE ONLY

ZONING DISTRICT: BUSINESS (B) / RESIDENTIAL 2 (R2)

	(B)	"R2"
MINIMUM AREA:	15,000	20,000 SF
MINIMUM FRONTAGE:	100'	125'
MINIMUM SET BACK		
FRONT:	25'	25'
SIDE:	10'	15'
REAR:	25'	25'
MAXIMUM HEIGHT:	35'	35'

PLAN NOTES:

- THIS PLAN IS PREPARED FOR THE DIVISION OF THE PROPERTY DESCRIBED IN DEED BK 66858 PAGE 260 RECORDED AT THE WORCESTER SOUTH DISTRICT REGISTRY OF DEEDS.
- HORIZONTAL DATUM IS MASSACHUSETTS STATE PLANE NAD83.
- THE STATUS OF FLINT WAY WAS UNKNOWN AT THE TIME OF THIS PLANS CREATION.

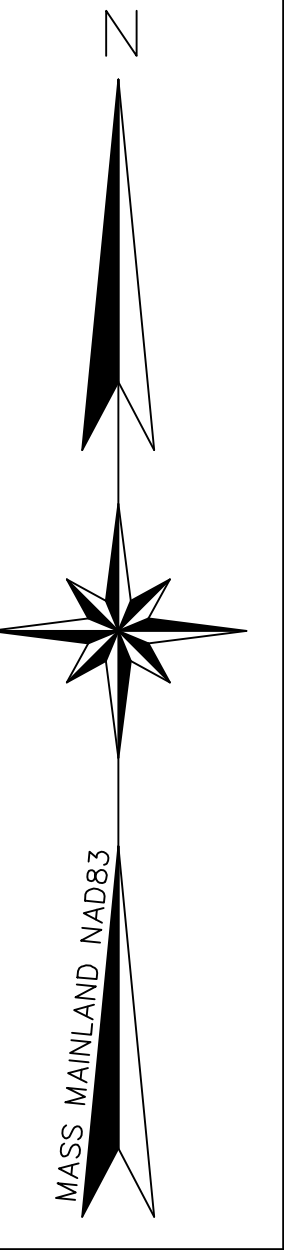
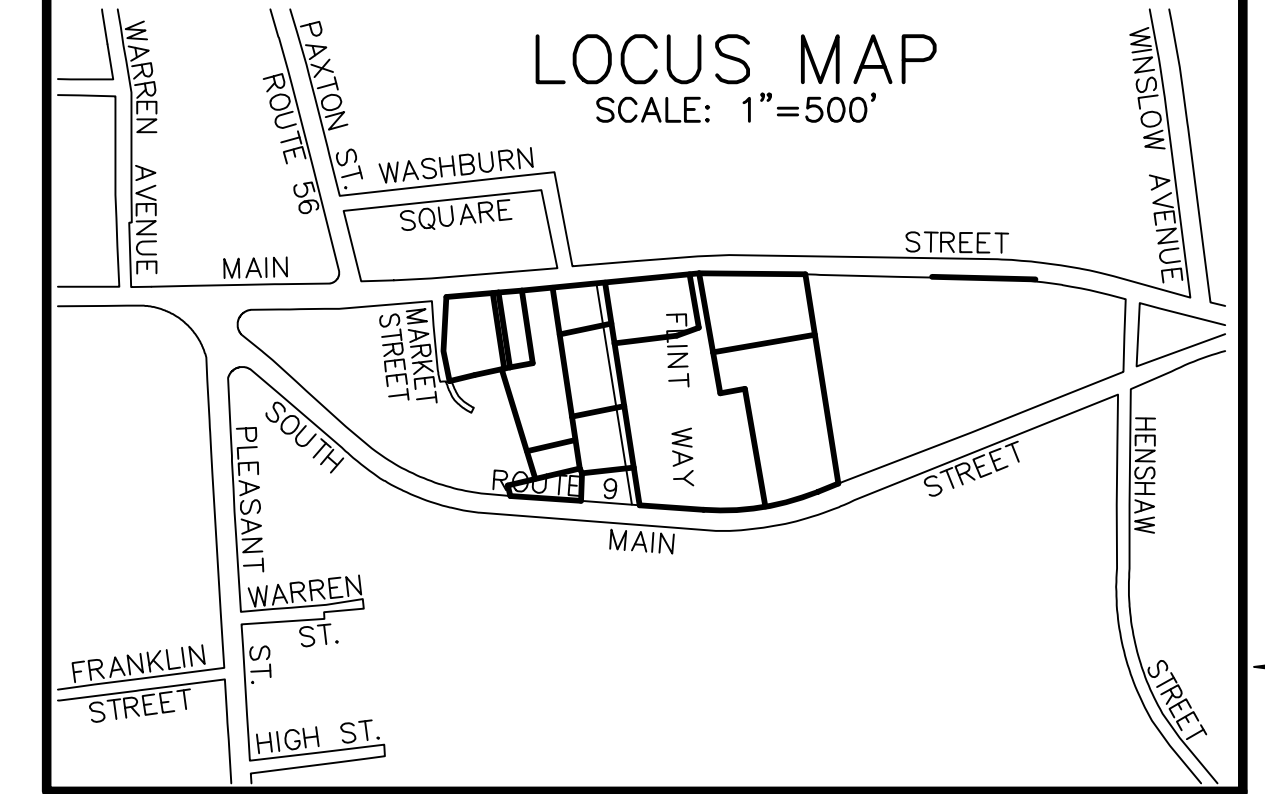

NO DETERMINATION AS TO THE COMPLIANCE WITH ZONING REQUIREMENTS HAS BEEN MADE OR IS INTENDED BY THIS ENDORSEMENT.



OWNER:
INHABITANTS OF THE TOWN OF LEICESTER
#3 WASHBURN SQUARE
LEICESTER, MA 01524
DEED BOOK 66858 PG. 260

I CERTIFY THAT THIS PLAN WAS PREPARED IN ACCORDANCE WITH THE RULES AND REGULATIONS OF THE REGISTRY OF DEEDS.

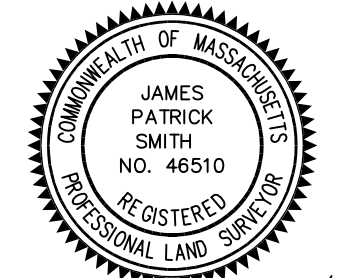

REGISTERED LAND SURVEYOR 9/8/2022
DATE

PLAN OF LAND AT
**South Main St., Main St.,
Market St., & Flint Way**
Leicester, MA

PREPARED FOR OWNER:
**Inhabitants of the
Town of Leicester**
SCALE: 1" = 40' DATE: SEPTEMBER 8, 2022
PREPARED BY

TAUPER LAND SURVEY INC.
710 MAIN STREET, OXFORD, MA 01537
TEL. 508-987-2266
DWG: 22-181_Town-of-Leicester_Becker.dwg
JOB NO. 22-181

LEGEND

- BOUND FOUND
- IRON PIPE OR PIN FOUND
- DRILL HOLE FOUND

MONUMENTS SHOWN ARE FOUND UNLESS OTHERWISE NOTED

SURV: J.P.S.	CALC: J.P.S.	DRAFTED: J.E.G.	CK'D: J.P.S.
--------------	--------------	-----------------	--------------

