

**LOT LOCUS:**  
SCALE: 1"=1000'

**TAX MAP REFERENCES:**  
LEICESTER ASSESSORS  
TAX MAP 14-A-4 (Lot 9)  
TAX MAP 14-A-4.2 (Lot 1)  
TAX MAP 14-A-4.3 (Lot 2)  
TAX MAP 14-A-4.5 (Lot 3)

**RECORD OWNER:**  
MULBERRY STREET REALTY, LLC  
350 LEICESTER STREET, AUBURN, MA 01501  
DB. 33207 PG. 144 (Lot 9)  
ASSESSORS REF: 14-A-4

DB. 56421 PG. 348 (Lot 1, Lot 2, and Lot 3)  
ASSESSORS REF: 14-A-4.2, 14-A-4.3, 14-A-4.5

**PLAN REFERENCES:**  
(WORCESTER COUNTY REGISTRY OF DEEDS)

PLAN BOOK 806 PLAN 70

**TOWN OF LEICESTER ZONING**  
ZONE - SA  
AREA - 80,000 S.F.  
FRONTAGE - 200 FT.  
FRONT - 40 FT.  
SIDE - 40 FT.  
REAR - 40 FT.

**GENERAL NOTES:**

1. BOUNDARIES SHOWN ARE THE RESULTS OF AN ACTUAL FIELD SURVEY BASED ON AVAILABLE MAPS, DEEDS OF RECORD AND PHYSICAL EVIDENCE, BUT ARE SUBJECT TO ALL EASEMENTS, RIGHT OF WAY AGREEMENTS, AND RIGHTS AND ENCUMBRANCES OF RECORD THAT AN ACCURATE AND THOROUGH TITLE SEARCH MAY DISCLOSE.

2. HORIZONTAL DATUM BASED ON NAD 83 MA11, VIA GLOBAL NAVIGATION SATELLITE SYSTEM (GNSS). THE GEOGRAPHIC AND STATE PLANE COORDINATES CONTAINED HEREON WERE THE RESULTS OF A SURVEY USING R.T.K. DUAL FREQUENCY C.P.S./G.N.S.S. RECEIVERS AND HAVING A POSITIONAL TOLERANCE LESS THAN 2 CM AT THE 95% CONFIDENCE LEVEL. REFERENCE MONUMENTS PROVIDED BY MULTIPLE KEYNET VIRTUAL BASE STATION OBSERVED IN MARCH, 2015.

3. VERTICAL DATUM BASED ON NAVD 88, GEOID 12A, ESTABLISHED VIA GPS

4. BY GEOGRAPHICAL PLOTTING ONLY THE SITE IS NOT LOCATED WITHIN A FLOOD HAZARD ZONE AS PER THE FLOOD INSURANCE RATE MAP, COMMUNITY-PANEL NO. # 25027C0595E WITH AN EFFECTIVE DATE OF JULY 4, 2011.

5. ABUTTERS NAMES ARE IN RESPECT TO THE LATEST ASSESSORS RECORDS AVAILABLE.

6. ALL WETLANDS ON SITE WERE DELINEATED BY ECOTEC INC. ON JUNE 15, 2018 AND SURVEY LOCATED BY BERTIN ENGINEERING.

7. TOPOGRAPHY AND TOPOGRAPHIC FEATURES PROVIDED VIA ELECTRONIC CAD FILE FROM EASTERN TOPOGRAPHICS WOLFBOURNE, MAPPING WAS COLLECTED FROM AERIAL PHOTOGRAPHY AS REFERENCED ABOVE - USING DIGITAL TERRAIN MODELING (DTM) METHODS WITH KLT ATLAS SOFTWARE. ANY USER SHOULD DETERMINE THE SUITABILITY OF THIS AERIAL MAPPING FOR HIS INTENDED USE AND ASSUME ALL RISK AND LIABILITY IN CONNECTION THEREWITH. NOTE: BUILDING CORNERS AS SHOWN REPRESENT ROOF LINES AS COLLECTED FROM AERIAL PHOTOGRAPHY.

**SYMBOL KEY**

|                              |                                |                       |                          |       |
|------------------------------|--------------------------------|-----------------------|--------------------------|-------|
| BOUND                        | WATER GATE                     | CHAIN LINK FENCE      | CONCRETE                 | CONC. |
| IRON PIPE / REBAR            | GAS GATE                       | WOOD / STOCKADE FENCE | INVERT                   | INV.  |
| SURVEY MARKER TO BE SET      | BOLLARD                        | WATER LINE            | REINFORCED CONCRETE PIPE | RCP   |
| DRAIN MANHOLE                | LIGHT DECORATIVE (15'± HEIGHT) | SEWER LINE            | POLYVINYL CHLORIDE PIPE  | PVC   |
| SEWER MANHOLE                | BENCH MARK                     | GAS LINE              | HDPPE                    | HDPPE |
| SEWER CLEANOUT               | SIGN                           | ELECTRIC LINE         | IRON PIPE                | I.P.  |
| ELECTRIC MANHOLE             | MASSHIGHWAY SIGNAL BOX         | OVERHEAD WIRES        | FOUND                    | FND.  |
| CATCH BASIN                  | MONITOR WELL                   | CONTOUR 5' INTERVAL   | BOLLARD                  | BOL.  |
| UTILITY POLE                 |                                | CONTOUR 1' INTERVAL   | SEWER MANHOLE            | SMH   |
| UTILITY POLE W/ STREET LIGHT |                                | X 69.33'              | DRAINAGE MANHOLE         | DMH   |
| GUY WIRE                     |                                | BITUMINOUS            | WATER GATE               | WG    |
| FIRE HYDRANT                 |                                |                       | HYDRANT                  | HYD.  |
|                              |                                |                       | UTILITY POLE             | UP    |
|                              |                                |                       | GUY WIRE                 | GUY   |

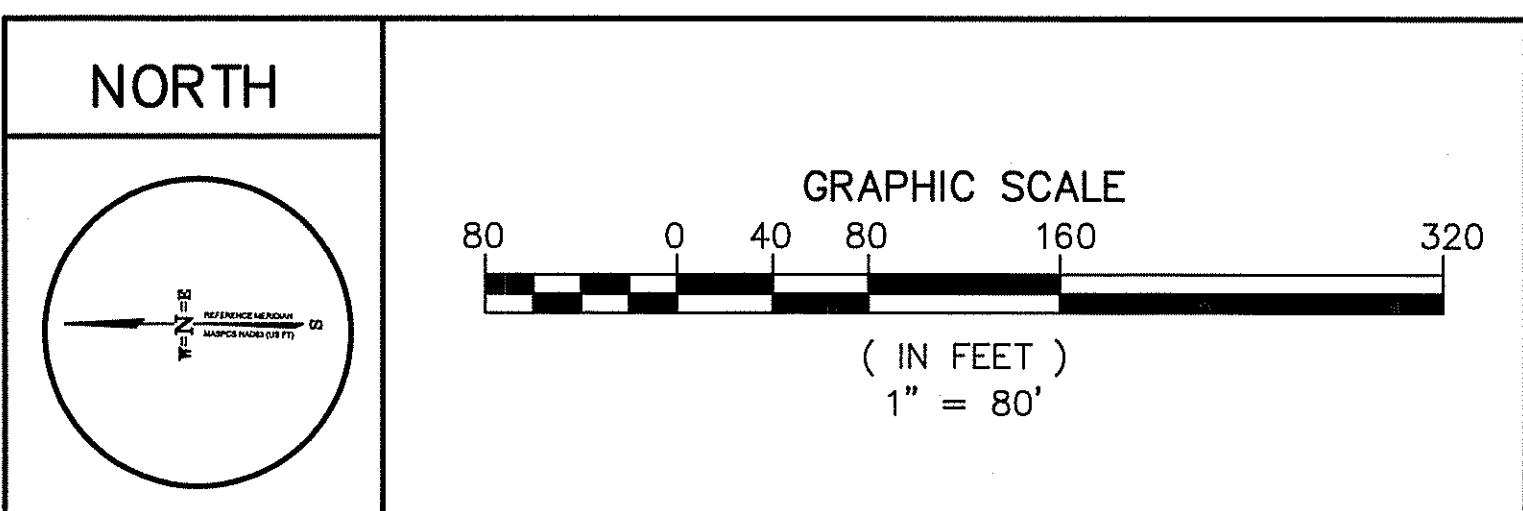

|     |      |          |    |       |  |  |  |
|-----|------|----------|----|-------|--|--|--|
| NO. | DATE | REVISION | BY | STAMP | DRAWN BY:  | CHECKED BY:  | CLIENT:  |
|     |      |          |    |       | AB   | BF   | SYNCRAPHA SOLAR, LLC<br>250 W 57TH STREET, SUITE 701<br>NEW YORK, NY 10107   |
|     |      |          |    |       | CALISTO J. BERTIN, P.E.<br>PROFESSIONAL ENGINEER<br>MA. LIC. NO.: 40595<br>CT. LIC. NO.: 12950<br>RI. LIC. NO.: 6694<br>NH. LIC. NO.: 9368 | FRANK W. BICCHIERI, P.E.<br>PROFESSIONAL ENGINEER<br>MA. LIC. NO.: 47597 | <b>EXISTING CONDITIONS</b><br>SITE ADDRESS:<br>MULBERRY STREET<br>LEICESTER, MA 01524  |
|     |      |          |    |       | BRUCE A. FITZBACK, P.L.S.<br>PROFESSIONAL LAND SURVEYOR<br>MA. LIC. NO.: 37731<br>CT. LIC. NO.: 16870                                      | PETER C. ENGLE, P.E.<br>PROFESSIONAL ENGINEER<br>MA. LIC. NO.: 53736     | <b>BERTIN ENGINEERING</b><br>39 ELM STREET<br>SOUTHBRIDGE, MA 01550<br>P 508.765.0195<br>F 508.765.0193<br>www.bertinengineering.com |
|     |      |          |    |       |  |  | DATE: 7.11.18<br>SCALE: 1"=80'<br>REV #:<br>PROJECT #:<br>DWS. NO.:<br>C-2   |

THIS DRAWING IS THE PROPERTY OF THE CLIENT AND BERTIN ENGINEERING ASSOCIATES, INC. AND IS NOT TO BE REPRODUCED OR USED FOR ANY OTHER PURPOSE WITHOUT THE WRITTEN CONSENT OF BERTIN ENGINEERING ASSOCIATES, INC. IS PROHIBITED. 2011



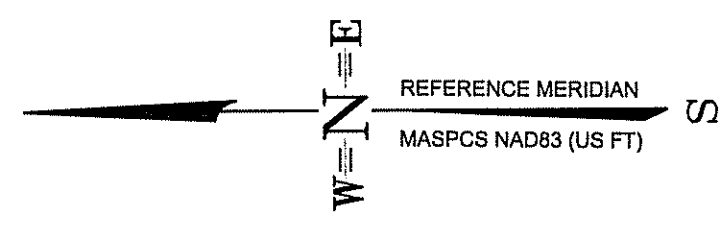
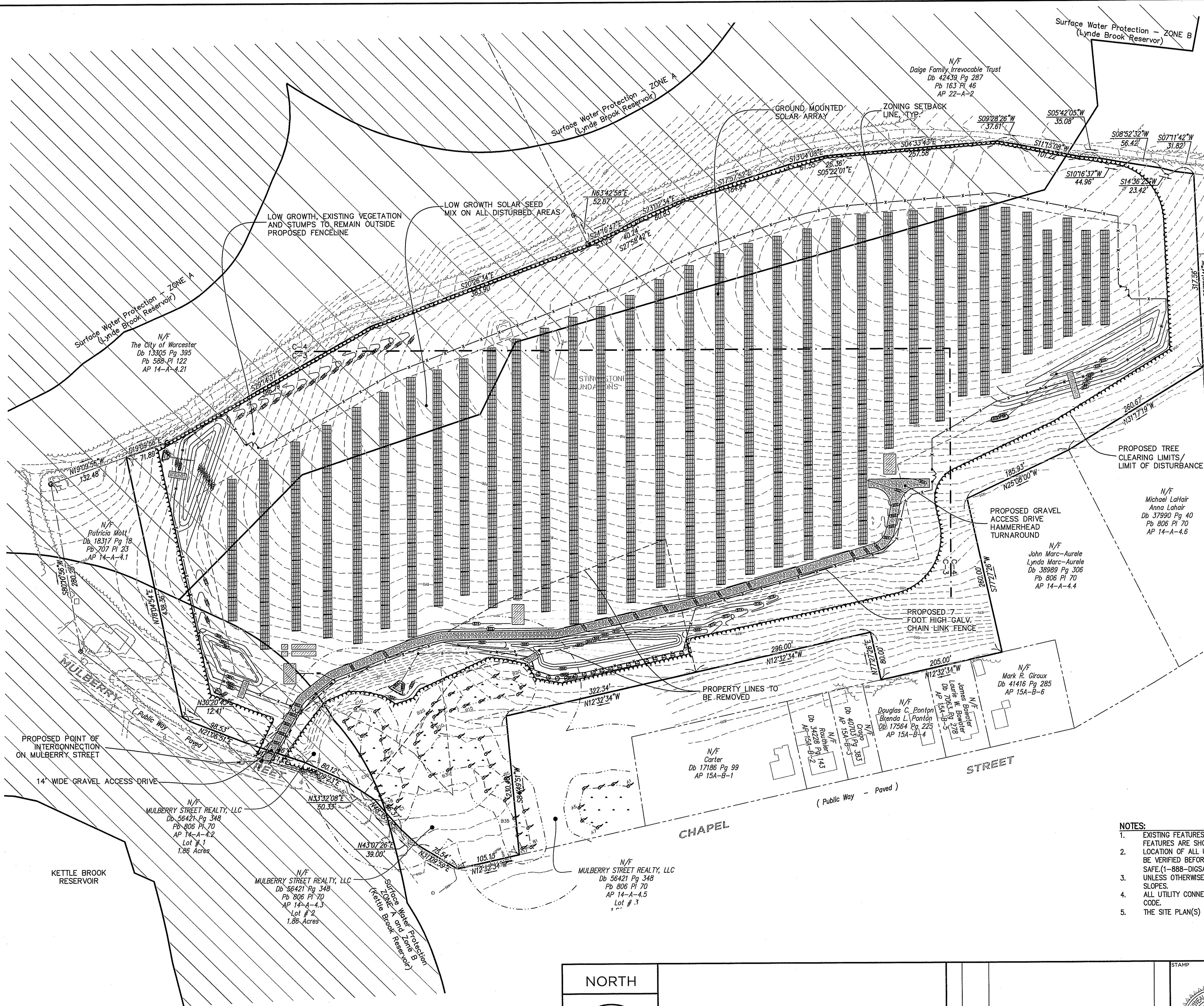

N/F Patricia Mott  
Db 18317 Pg 18  
Pb 806 Pl 70  
AP 14-A-4.1

N/F The City of Worcester  
Db 13305 Pg 395  
Pb 588 Pl 122  
AP 14-A-4.21

N/F MULBERRY STREET REALTY, LLC  
Db 56421 Pg 348  
Pb 806 Pl 70  
AP 14-A-4.2  
Lot # 1  
1.86 Acres

N/F MULBERRY STREET REALTY, LLC  
Db 56421 Pg 348  
Pb 806 Pl 70  
AP 14-A-4.3  
Lot # 2  
1.86 Acres

N/F MULBERRY STREET REALTY, LLC  
Db 56421 Pg 348  
Pb 806 Pl 70  
AP 14-A-4.5  
Lot # 3

N/F Douglas C. Ponton  
Brenda L. Ponton  
Db 17564 Pg 225  
AP 15A-B-4

N/F John Marc-Aurele  
Lynda Marc-Aurele  
Db 38989 Pg 306  
Pb 806 Pl 70  
AP 14-A-4.4

N/F Michael Lohair  
Anna Lohair  
Db 37990 Pg 40  
Pb 806 Pl 70  
AP 14-A-4.6

N/F Rachel C. Galasso  
Robert P. Galasso  
Db 36507 Pg 152  
Pb 806 Pl 70  
AP 14-A-4.8

N/F Armando Garcia  
Db 39282 Pg 1  
Pb 806 Pl 70  
AP 14-A-4.7

N/F Daige Family Irrevocable Trust  
Db 42439 Pg 287  
Pb 163 Pl 46  
AP 22-A-2

N/F Russell J. White  
Db 49961 Pg 184Pb 806 Pl 70  
AP 14-A-4.9

**SOLAR PANEL ARRAY SUMMARY CHART**

|                       |                          |
|-----------------------|--------------------------|
| ARRAY                 | TOTAL                    |
| RACKS                 | 341                      |
| MODULES (30 PER RACK) | 10,230                   |
| WATTS PER MODULE      | 350                      |
| TOTAL WATTS DC, STC   | 350 x 10,230 = 3,580,500 |

NUMBERS SUBJECT TO CHANGE BASED ON PANEL AVAILABILITY AND WILL BE UPDATED PRIOR TO APPLYING FOR BUILDING AND ELECTRICAL PERMIT

- NOTES:**
- EXISTING FEATURES ARE SHOWN IN HALF TONE PROPOSED FEATURES ARE SHOWN IN FULL TONE
  - LOCATION OF ALL UNDERGROUND UTILITIES IS APPROXIMATE AND SHOULD BE VERIFIED BEFORE EXCAVATION OR CONSTRUCTION BEGINS. CALL DIG SAFE (1-888-DIGSAFE)
  - UNLESS OTHERWISE NOTED, MAINTAIN EXISTING GRADES AND SLOPES.
  - ALL UTILITY CONNECTIONS ARE TO BE IN ACCORDANCE WITH LOCAL CODE.
  - THE SITE PLAN(S) SUPERSEDES ALL STANDARD DRAWINGS.

TOWN OF LEICESTER PLANNING BOARD

|  |
|--|
|  |
|  |
|  |
|  |
|  |
|  |
|  |
|  |
|  |
|  |

DATE: \_\_\_\_\_

NORTH

GRAPHIC SCALE

80 0 40 80 160 320

( IN FEET )

1" = 80'

|     |      |          |    |
|-----|------|----------|----|
| NO. | DATE | REVISION | BY |
|     |      |          |    |

STAMP

|               |                         |               |                          |
|---------------|-------------------------|---------------|--------------------------|
| DRAWN BY:     | CALISTO J. BERTIN, P.E. | CHECKED BY:   | FRANK W. BICCHIERI, P.E. |
| PE            | PROFESSIONAL ENGINEER   | FB            | PROFESSIONAL ENGINEER    |
| MA. LIC. NO.: | 40595                   | MA. LIC. NO.: | 47597                    |
| CT. LIC. NO.: | 12950                   |               |                          |
| RI. LIC. NO.: | 6694                    |               |                          |
| NH. LIC. NO.: | 9368                    |               |                          |

|                            |                       |
|----------------------------|-----------------------|
| BRUCE A. FITZBACK, P.L.S.  | PETER C. ENGLE, P.E.  |
| PROFESSIONAL LAND SURVEYOR | PROFESSIONAL ENGINEER |
| MA. LIC. NO.:              | MA. LIC. NO.:         |
| CT. LIC. NO.:              | MA. LIC. NO.:         |
| 16970                      | 53736                 |

|   |                              |                    |
|---|------------------------------|--------------------|
| CLIENT: SYNCARPHA SOLAR, LLC  | 250 W 57TH STREET, SUITE 701 | NEW YORK, NY 10107 |
| OVERALL SITE PLAN   |                              |                    |
| SITE ADDRESS: MULBERRY STREET LEICESTER, MA 01524   |                              |                    |
| 39 ELM STREET SOUTHBRIDGE, MA 01550 P 508.765.0195 F 508.765.0193 www.bertinengineering.com |                              |                    |
| DATE:   | SCALE:                       | REV #:             |
| 7.11.18   | 1"=80'                       | N/A                |
| PROJECT #:  | 18-120                       | DWG. NO.:          |
|   |                              | C-3                |

THIS DRAWING IS THE PROPERTY OF THE CLIENT AND BERTIN ENGINEERING ASSOCIATES, INC. AND WAS PREPARED FOR THE EXCLUSIVE USE BY THE CLIENT. REUSE FOR ANY OTHER PURPOSE, WITHOUT AUTHORIZATION BY WRITTEN CONSENT BY THE CLIENT AND BERTIN ENGINEERING ASSOCIATES, INC. IS PROHIBITED. 2017

ORIGINAL  
7-11-18







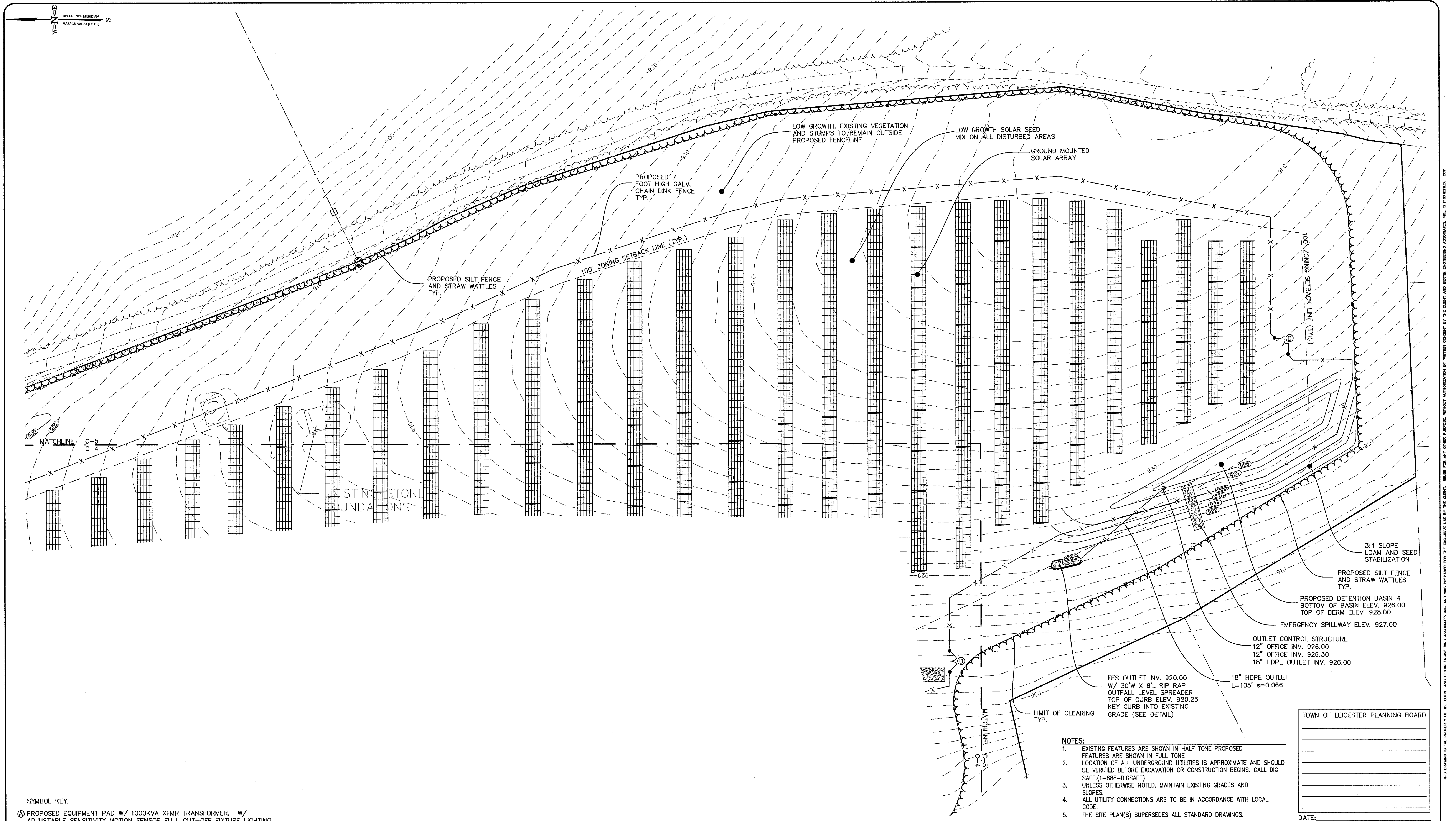

- SYMBOL KEY**
- Ⓐ PROPOSED EQUIPMENT PAD W/ 1000KVA XFMR TRANSFORMER, W/ ADJUSTABLE SENSITIVITY MOTION SENSOR FULL CUT-OFF FIXTURE LIGHTING.
  - Ⓑ PROPOSED EQUIPMENT PAD W/ 600KVA XFMR TRANSFORMER, W/ ADJUSTABLE SENSITIVITY MOTION SENSOR FULL CUT-OFF FIXTURE LIGHTING.
  - Ⓒ ENERGY STORAGE BATTERY CONTAINERS AND INVERTERS.
  - Ⓓ 20' DOUBLE SWING CHAIN LINK VEHICLE GATE W/ KNOX LOCK AND SIGNAGE WITH EMERGENCY CONTACT INFORMATION (TYP.).
  - Ⓔ PROPOSED CUSTOMER OWNED RISER AND RECLOSER POLE.
  - Ⓕ PROPOSED CUSTOMER OWNED LOAD BREAK POLE ACCESSIBLE TO NATIONAL GRID 24/7.
  - Ⓖ PROPOSED NATIONAL GRID BI-DIRECTIONAL METER POLE
  - Ⓗ PROPOSED NATIONAL GRID RECLOSER POLE
  - Ⓘ PROPOSED NATIONAL GRID LOAD BREAK POLE.
  - Ⓚ PROPOSED POINT OF INTERCONNECTION ON MULBERRY STREET.
  - Ⓛ PROPOSED UNDERGROUND WIRING WITHIN SOLAR ARRAY.
  - Ⓜ PROPOSED OVERHEAD WIRING FROM RISER POLE TO POINT OF INTERCONNECTION.

- NOTES:**
1. EXISTING FEATURES ARE SHOWN IN HALF TONE PROPOSED FEATURES ARE SHOWN IN FULL TONE
  2. LOCATION OF ALL UNDERGROUND UTILITIES IS APPROXIMATE AND SHOULD BE VERIFIED BEFORE EXCAVATION OR CONSTRUCTION BEGINS. CALL DIG SAFE.(1-888-DIGSAFE)
  3. UNLESS OTHERWISE NOTED, MAINTAIN EXISTING GRADES AND SLOPES.
  4. ALL UTILITY CONNECTIONS ARE TO BE IN ACCORDANCE WITH LOCAL CODE.
  5. THE SITE PLAN(S) SUPERSEDES ALL STANDARD DRAWINGS.

|                                  |  |
|----------------------------------|--|
| TOWN OF LEICESTER PLANNING BOARD |  |
|                                  |  |
|                                  |  |
|                                  |  |
|                                  |  |
|                                  |  |
|                                  |  |
| DATE: _____                      |  |

|                  |  |          |          |    |           |   |   |   |                   |               |
|------------------|--|----------|----------|----|-----------|---|---|---|-------------------|---------------|
| <b>NORTH</b><br> | <b>GRAPHIC SCALE</b><br>40 0 20 40 80 160<br>( IN FEET )<br>1" = 40' | NO. DATE | REVISION | BY | STAMP<br> | DRAWN BY:<br>PE<br>CALISTO J. BERTIN, P.E.<br>PROFESSIONAL ENGINEER<br>MA. LIC. NO.: 40595<br>CT. LIC. NO.: 12950<br>RI. LIC. NO.: 6694<br>NH. LIC. NO.: 9368 | CHECKED BY:<br>FB<br>FRANK W. BICCHIERI, P.E.<br>PROFESSIONAL ENGINEER<br>MA. LIC. NO.: 47597 | CLIENT: SYNCARPHA SOLAR, LLC<br>250 W 57TH STREET, SUITE 701<br>NEW YORK, NY 10107  |                   |               |
|                  |  |          |          |    |           | BRUCE A. FITZBACK, P.L.S.<br>PROFESSIONAL LAND SURVEYOR<br>MA. LIC. NO.: 37731<br>CT. LIC. NO.: 18920   | PETER C. ENGLE, P.E.<br>PROFESSIONAL ENGINEER<br>MA. LIC. NO.: 53736                          | <b>SITE PLAN (2/2)</b><br>SITE ADDRESS:<br>MULBERRY STREET<br>LEICESTER, MA 01524<br><br><b>BERTIN ENGINEERING</b><br>39 ELM STREET<br>SOUTHBRIDGE, MA 01550<br>P 508.765.0195<br>F 508.765.0193<br>www.bertinengineering.com |                   |               |
|                  |  |          |          |    |           | DATE: 7.11.18   | SCALE: 1"=40'   | REV #: N/A  | PROJECT #: 18-120 | DWG. NO.: C-5 |



W. ALL TREE CLEARING DEBRIS SHALL BE REMOVED FROM THE SITE. NO MATERIAL SHALL BE BURIED ON-SITE.

















TEMPORARY SEDIMENTATION  
BASIN FOR CONSTRUCTION USE  
ONLY. BOTTOM OF  
SEDIMENTATION BASIN TO BE  
ONE FOOT ABOVE PROPOSED  
BOTTOM OF DETENTION BASIN  
ONCE CONSTRUCTION PHASING  
IS COMPLETE. ALL SEDIMENT IS  
TO BE REMOVED & BASIN IS TO  
BE CONVERTED TO STORM  
WATER DETENTION BASIN AS  
SHOWN ON SITE PLANS

3. EXTRA EROSION CONTROL MATERIALS (HAYBALES, SILT FENCE) EQUAL TO 100 LF SHALL BE KEPT ON SITE FOR EMERGENCY REPAIRS. THESE MATERIALS SHALL BE KEPT COVERED.

NOTE: SEE SITE PLAN FOR  
EXISTING LEGEND SYMBOLS

1. A PRE-CONSTRUCTION MEETING SHOULD BE SCHEDULED BETWEEN BERTIN ENGINEERING AND CONSTRUCTION MANAGER. ALL ASPECTS OF EROSION CONTROLS AND CONSTRUCTION OF PROJECT ARE TO BE DISCUSSED
2. WATTLES AND SILTATION FENCE TO BE INSTALLED. INSTALL STABILIZED CONSTRUCTION ENTRANCE (SITE TRACKING PAD)
3. INSPECTIONS WILL BE CONDUCTED WEEKLY AND AFTER 0.5 INCH RAIN EVENTS. COPIES OF WEEKLY REPORTS AND RAIN EVENT REPORTS SHALL BE SUBMITTED TO THE CONSERVATION COMMISSION WITHIN SEVEN DAYS OF THE INSPECTION.

|                                |          |
|--------------------------------|----------|
| ACREAGE<br>SUMMARY<br>IN ACRES |          |
| SEEDED AREA                    | 17.2 AC± |
| TOTAL DISTURBED                | 22.9 AC± |

- # LEGEND
- |   |                                   |
|---|-----------------------------------|
|  | SOIL MATERIAL STOCKPILE AREA      |
|  | TEMPORARY PARKING AREA            |
|  | PERMANENT SEEDING/STABILIZATION   |
|  | ROCK CHECK DAM                    |
|  | TEMPORARY PARKING AND STORAGE     |
|  | TEMPORARY DIVERSION DITCH         |
|  | TEMPORARY DIVERSION DIKE          |
|  | TEMPORARY SEDIMENT TRAP           |
|  | TEMPORARY SEDIMENT BASIN          |
|  | FENCE                             |
|  | SILT FENCE AND STRAW WATTLES      |
|  | DIRECTION OF OVERLAND FLOW W/GRAD |
|  | TEMPORARY STONE CONSTRUCTION EXIT |
|  | INLET PROTECTION                  |
|  | DRAINAGE FLOW DIRECTION           |
|  | EROSION CONTROL BLANKET           |

TOWN OF LEICESTER PLANNING BOARD

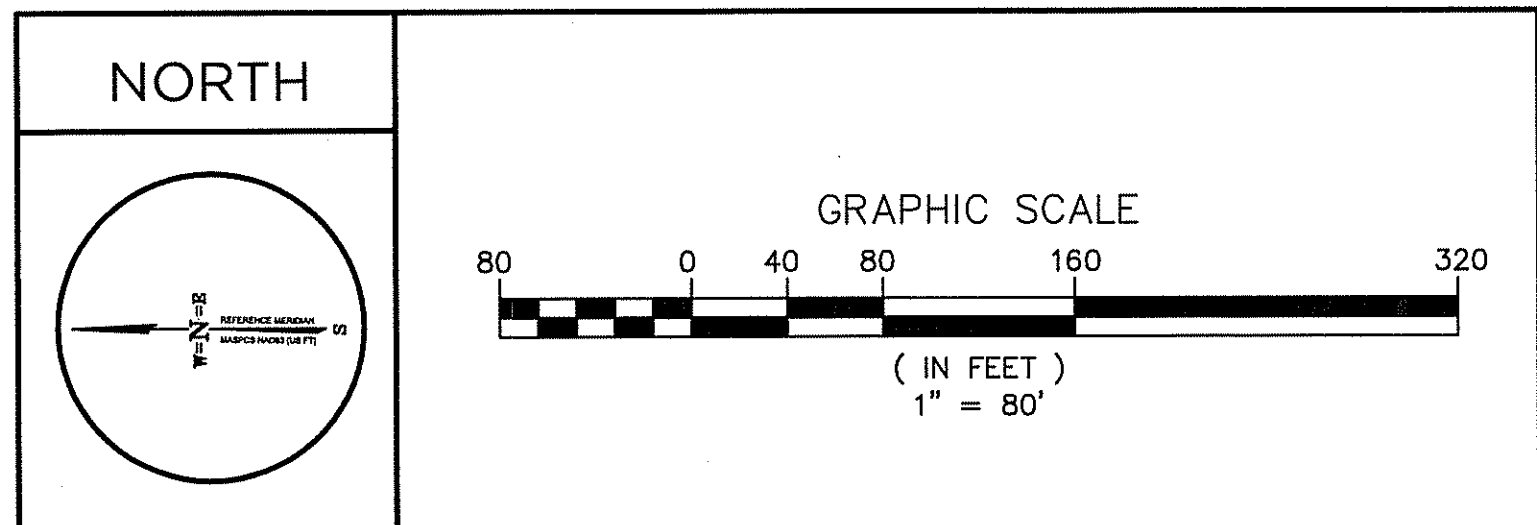
[illegible][illegible][illegible]



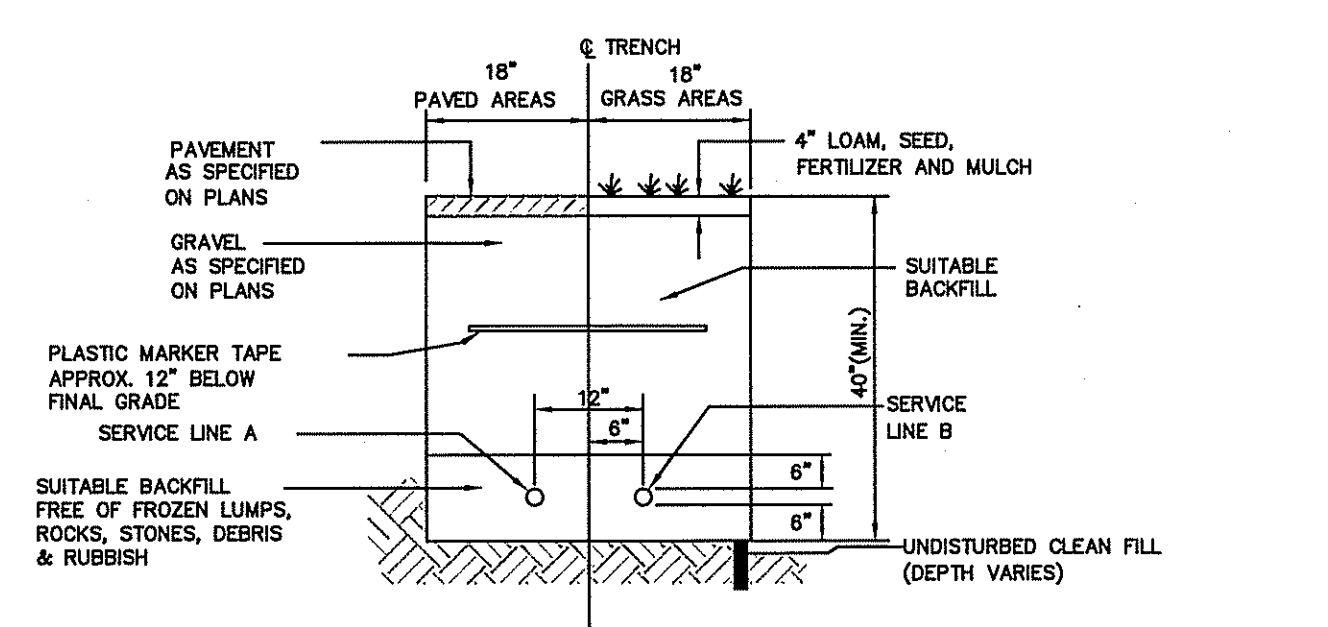
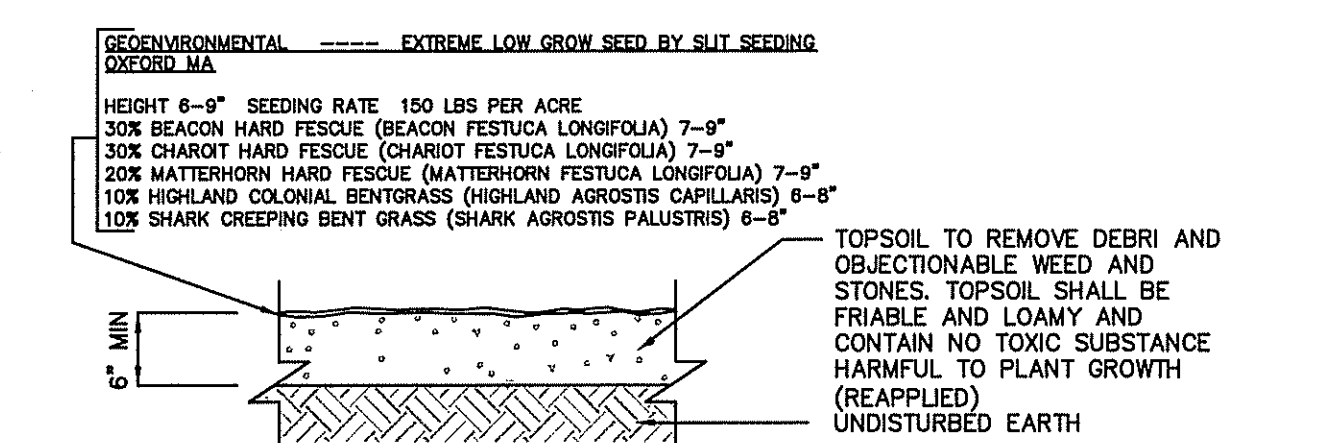
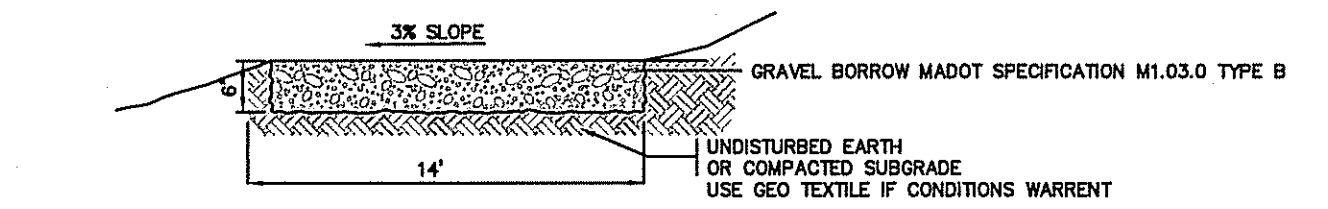
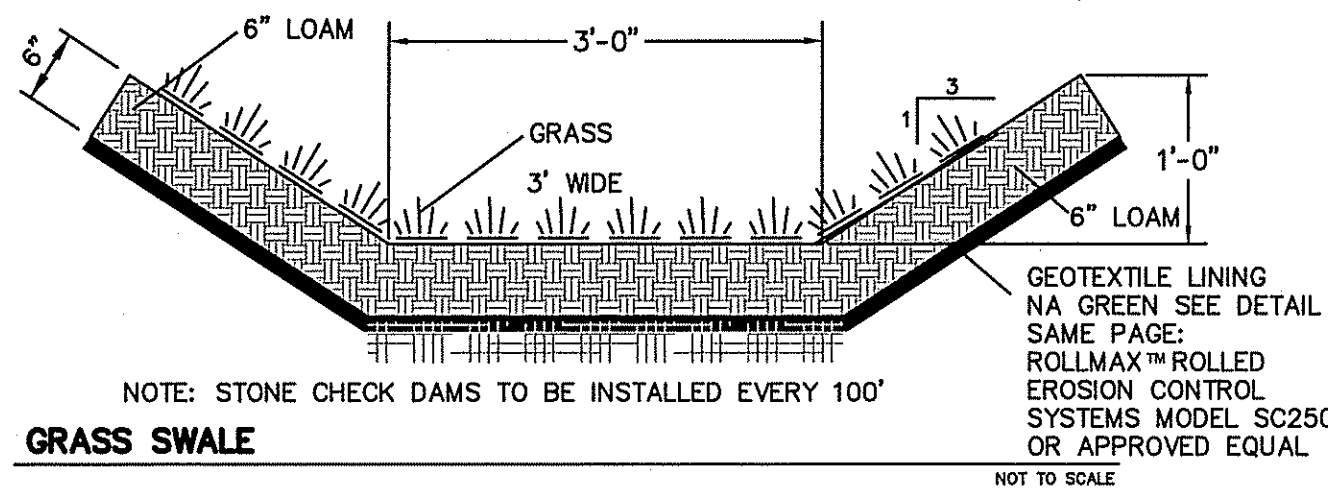

| CONDUIT TYPE |              |  |  |           |
|--------------|--------------|--|--|-----------|
| SERVICE      | CONDUIT SIZE | GRASS AREAS                                    | PAVED AREAS                                    | UTILITY   |
| A            | 4"           | RIGID GALVANIZED STEEL, ASTM A120 - SEE NOTE 1 | RIGID GALVANIZED STEEL, ASTM A120 - SEE NOTE 1 | POWER     |
| B            | 4"           | SCHEDULE 40 PVC                                | RIGID GALVANIZED STEEL, ASTM A120 - SEE NOTE 1 | TELEPHONE |

NOTE 1. PROVIDE GALVANIZED STEEL, 36" SWEEP AT RISER POLE. EXTEND 5' ONTO PROPERTY.

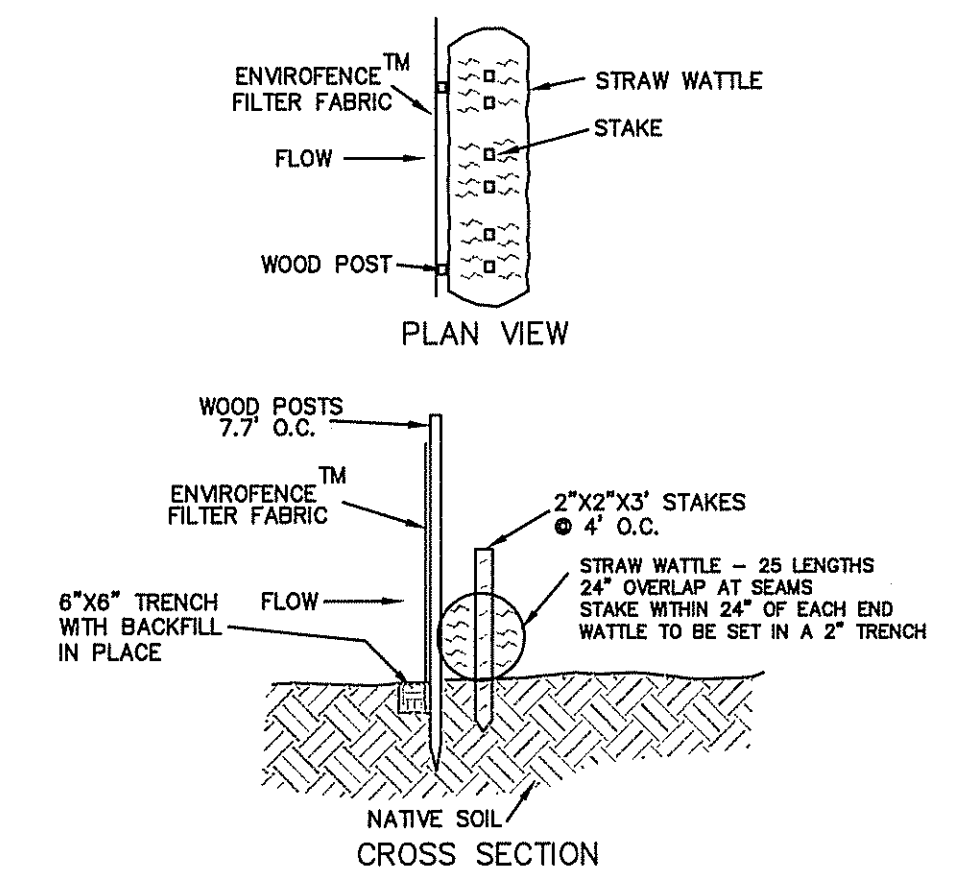
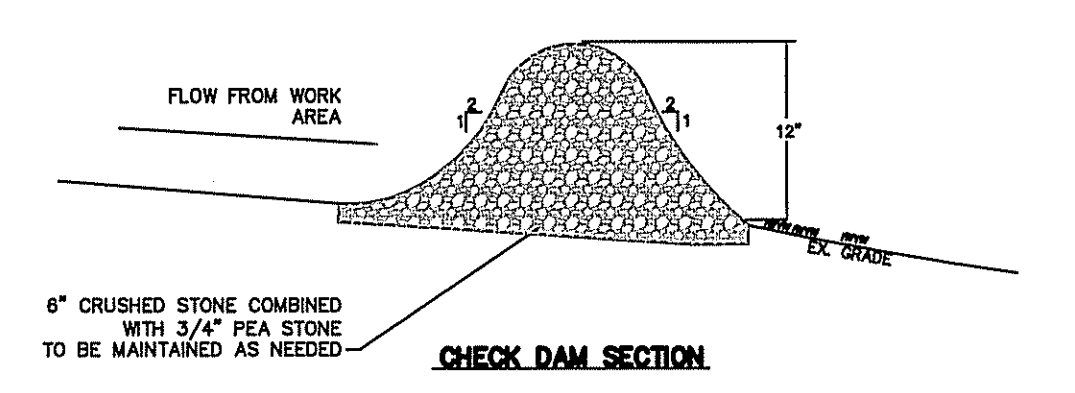
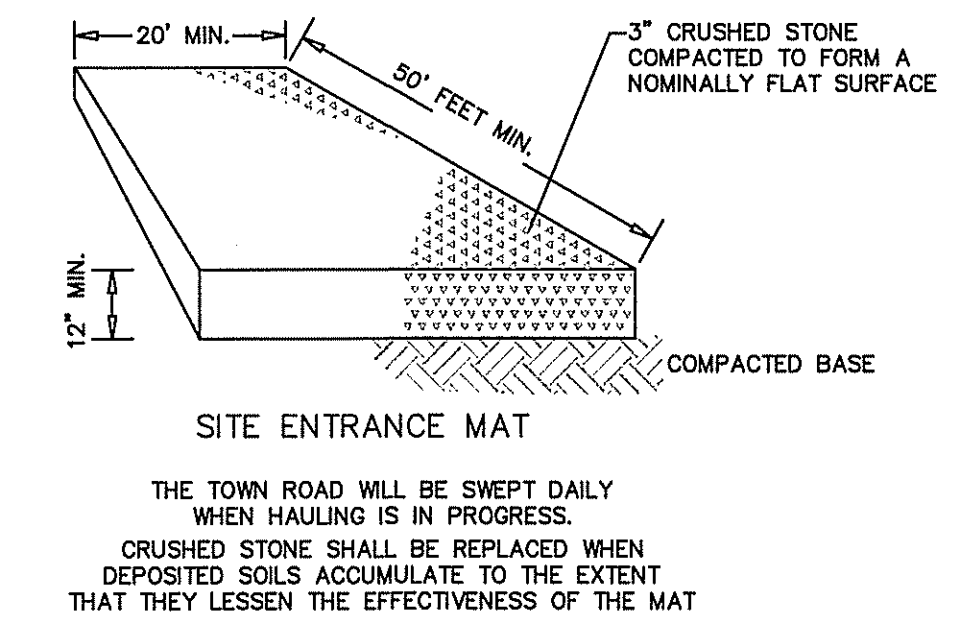
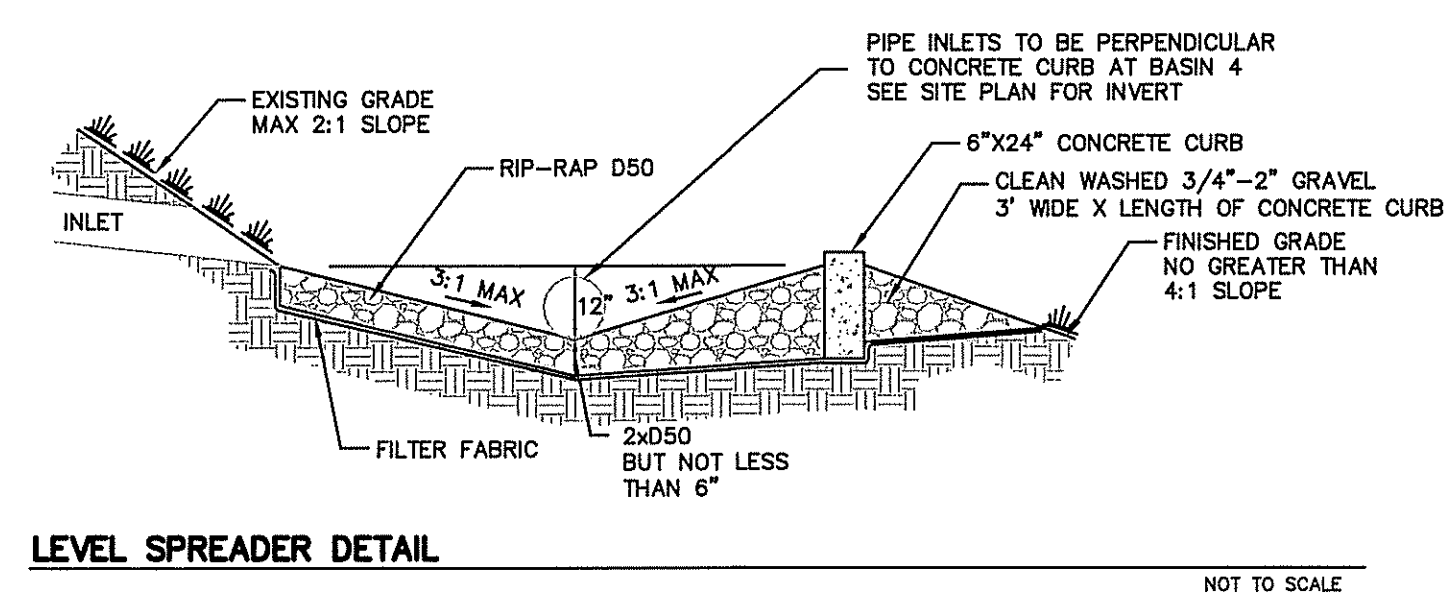
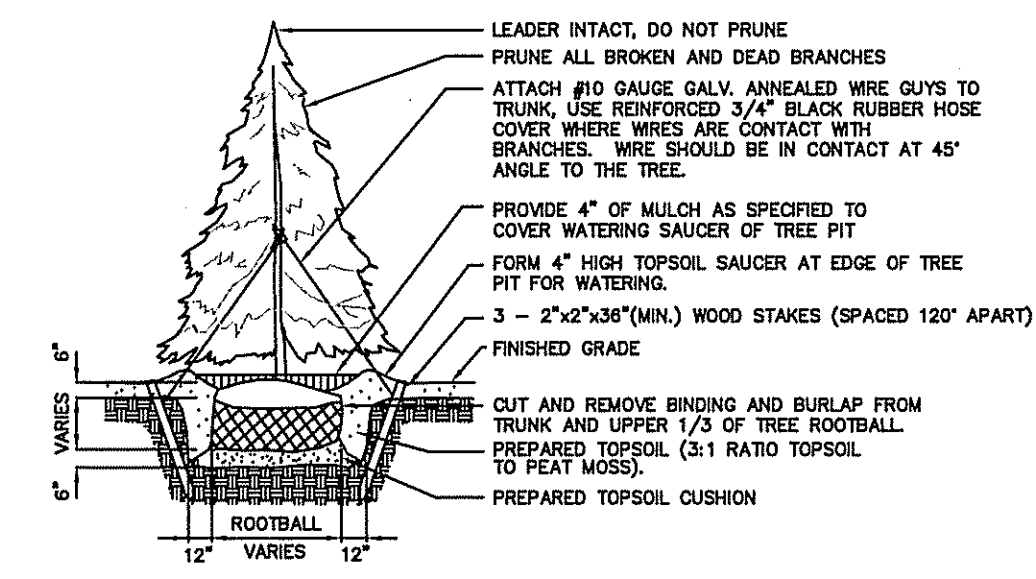
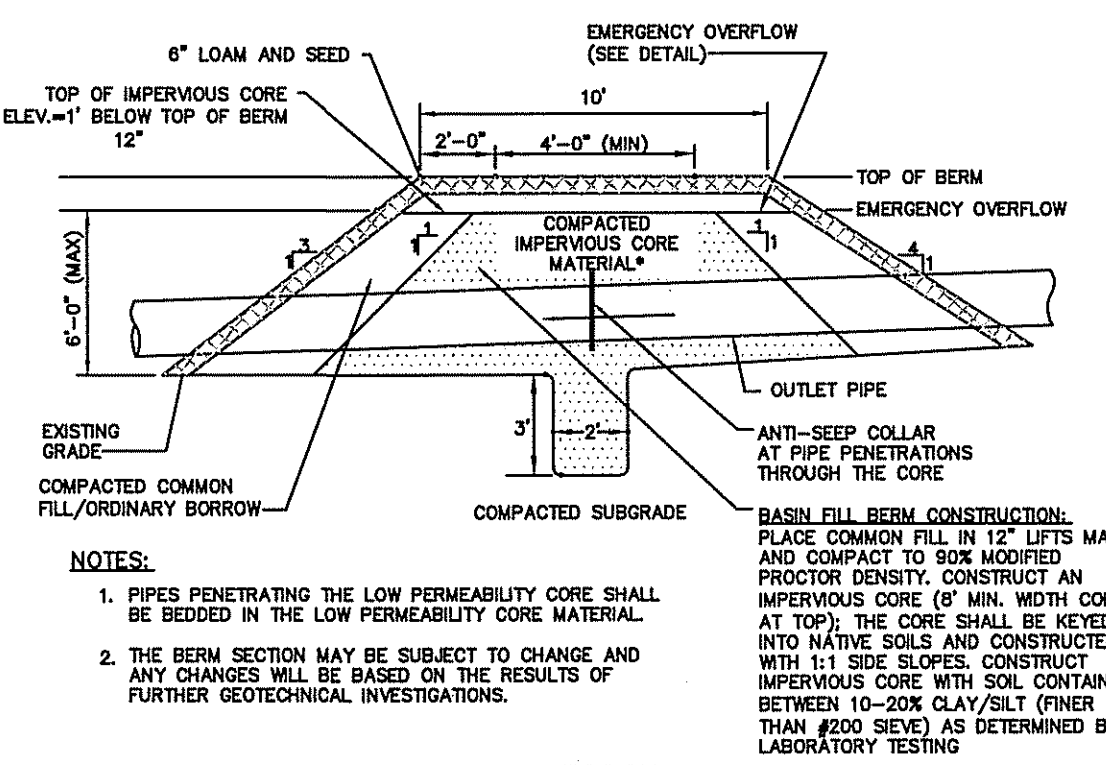
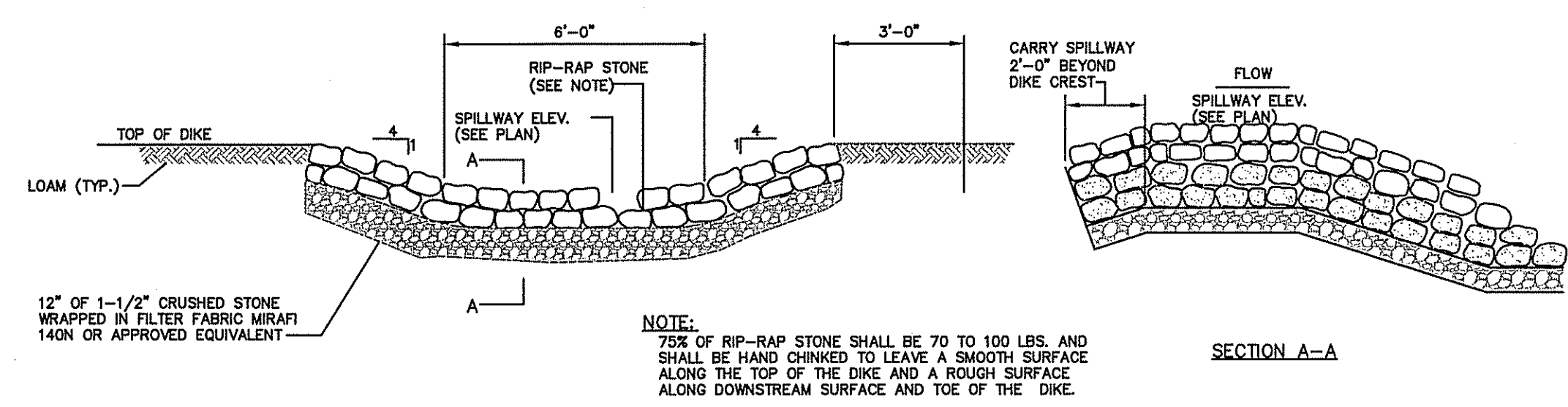
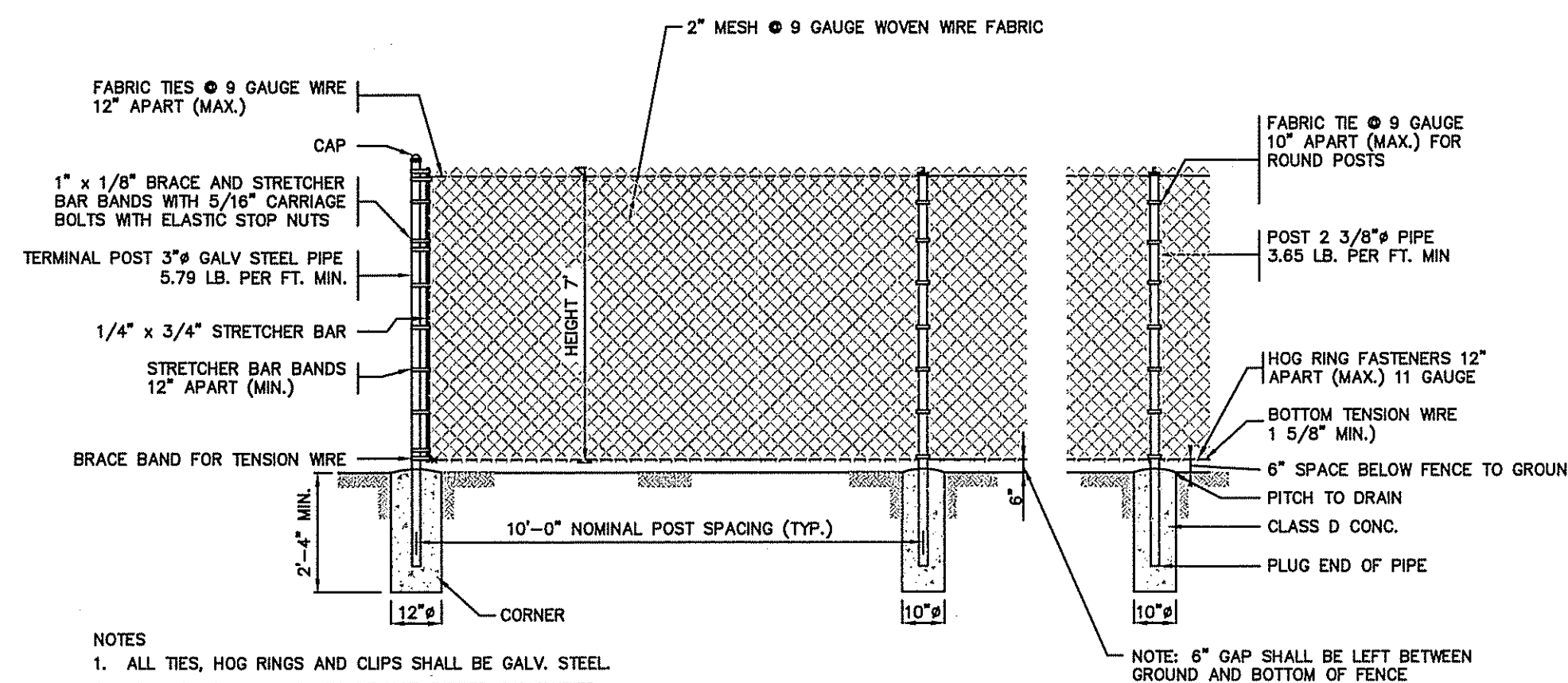

Authorized Personnel Only

Area Under Surveillance

**syncarpha capital**

(212) 419-4840  
info@syncarpha.com

Emergency 24/7 Contact Number  
844-645-0305  
www.syncarpha.com



TOWN OF LEICESTER PLANNING BOARD

DATE: \_\_\_\_\_

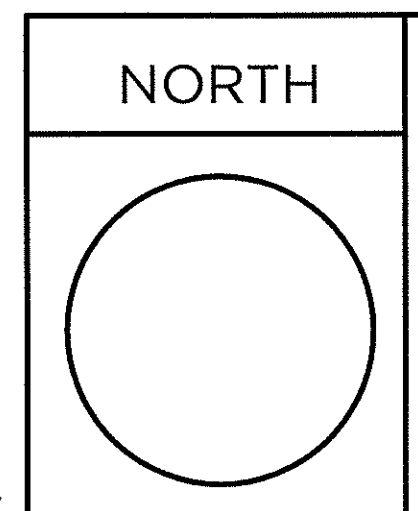

| NO. | DATE | REVISION | BY |
|-----|------|----------|----|
|     |      |          |    |
|     |      |          |    |
|     |      |          |    |

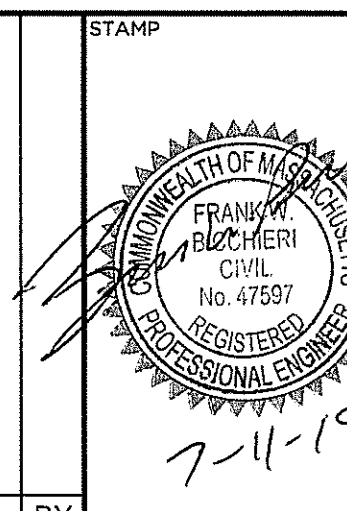

|   |   |   |   |
|---|---|---|---|
| DRAWN BY:<br>PE<br>CALISTO J. BERTIN, P.E.<br>PROFESSIONAL ENGINEER<br>MA. LIC. NO.: 40595<br>CT. LIC. NO.: 12850<br>RI. LIC. NO.: 6694<br>NH. LIC. NO.: 9368 | CHECKED BY:<br>FB<br>FRANK W. BICCHIERI, P.E.<br>PROFESSIONAL ENGINEER<br>MA. LIC. NO.: 47597 | CLIENT: SYNCARPHA SOLAR, LLC<br>250 W 57TH STREET, SUITE 701<br>NEW YORK, NY 10107<br>SITE ADDRESS:<br>MULBERRY STREET<br>LEICESTER, MA 01524 | 39 ELM STREET<br>SOUTHBRIDGE, MA 01550<br>P 508.765.0195<br>F 508.765.0193<br>www.bertinengineering.com |
| DRAWN BY:<br>P.L.S.<br>BRUCE A. FITZBACK, P.L.S.<br>PROFESSIONAL LAND SURVEYOR<br>MA. LIC. NO.: 37731<br>CT. LIC. NO.: 16970                                  | CHECKED BY:<br>P.E.<br>PETER C. ENGLE, P.E.<br>PROFESSIONAL ENGINEER<br>MA. LIC. NO.: 53736   | DATE:<br>7.11.18  | SCALE:<br>AS NOTED  |
| REV #:  | N/A   | PROJECT #:  | 18-120  |
| DWG. NO.:   | C-7   |   |   |





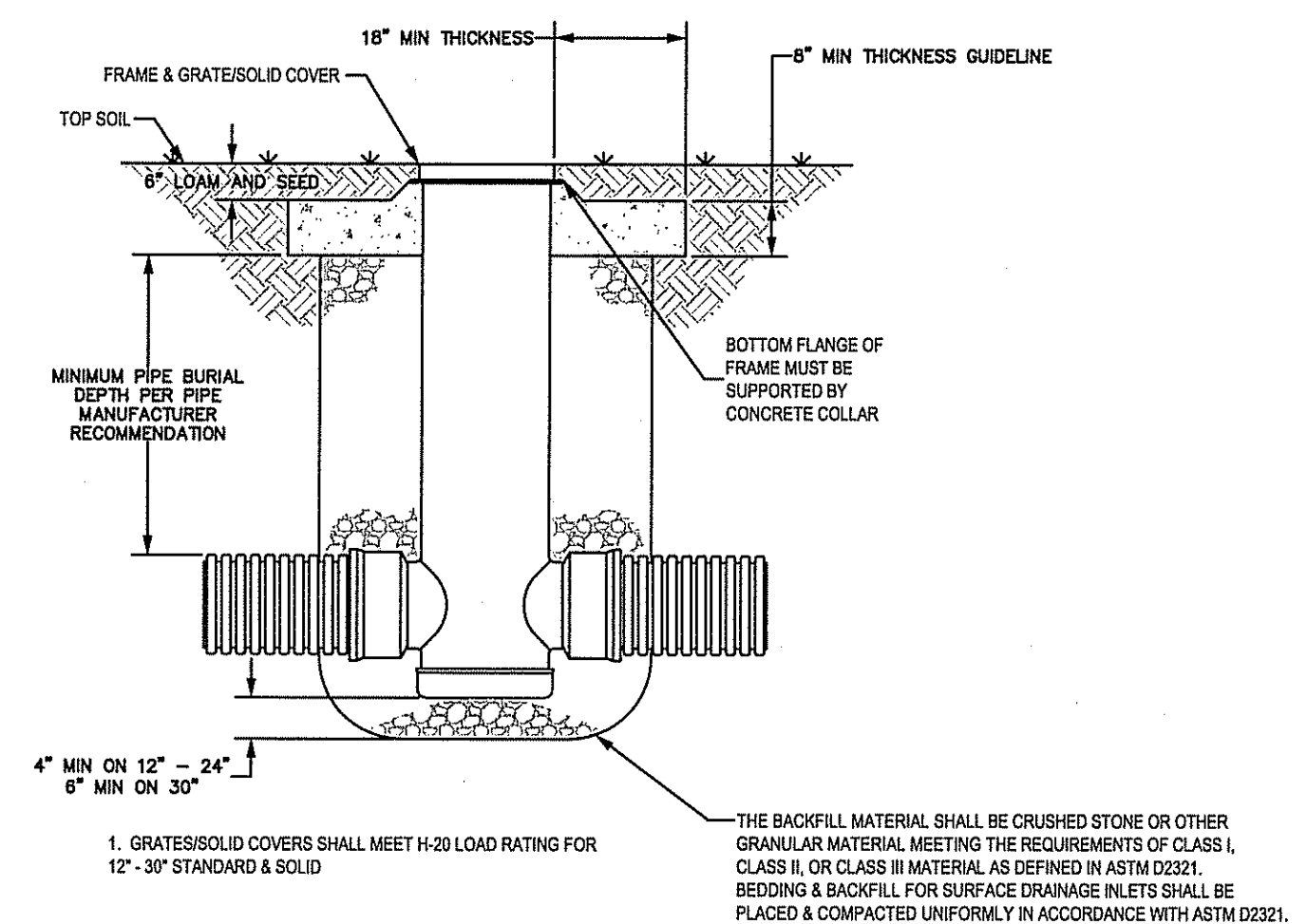
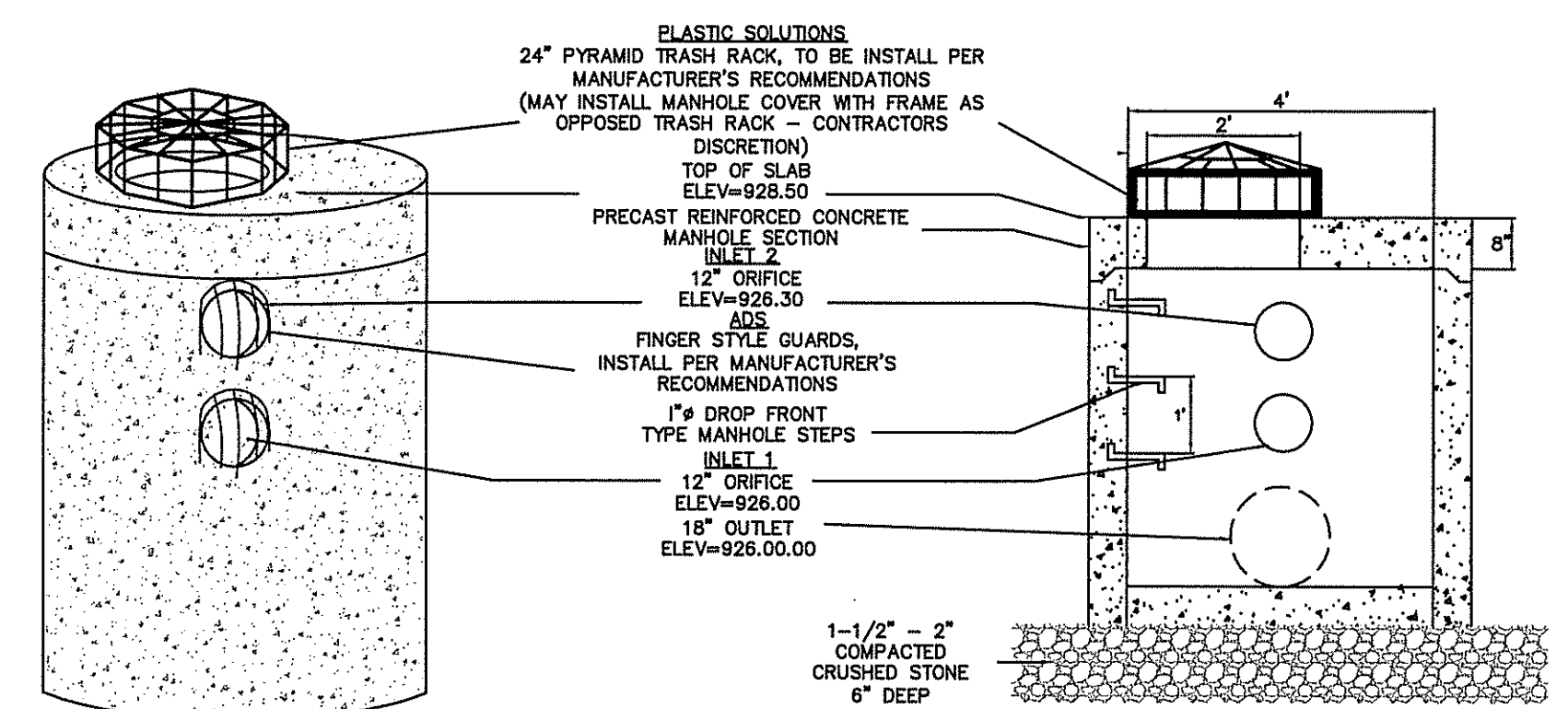
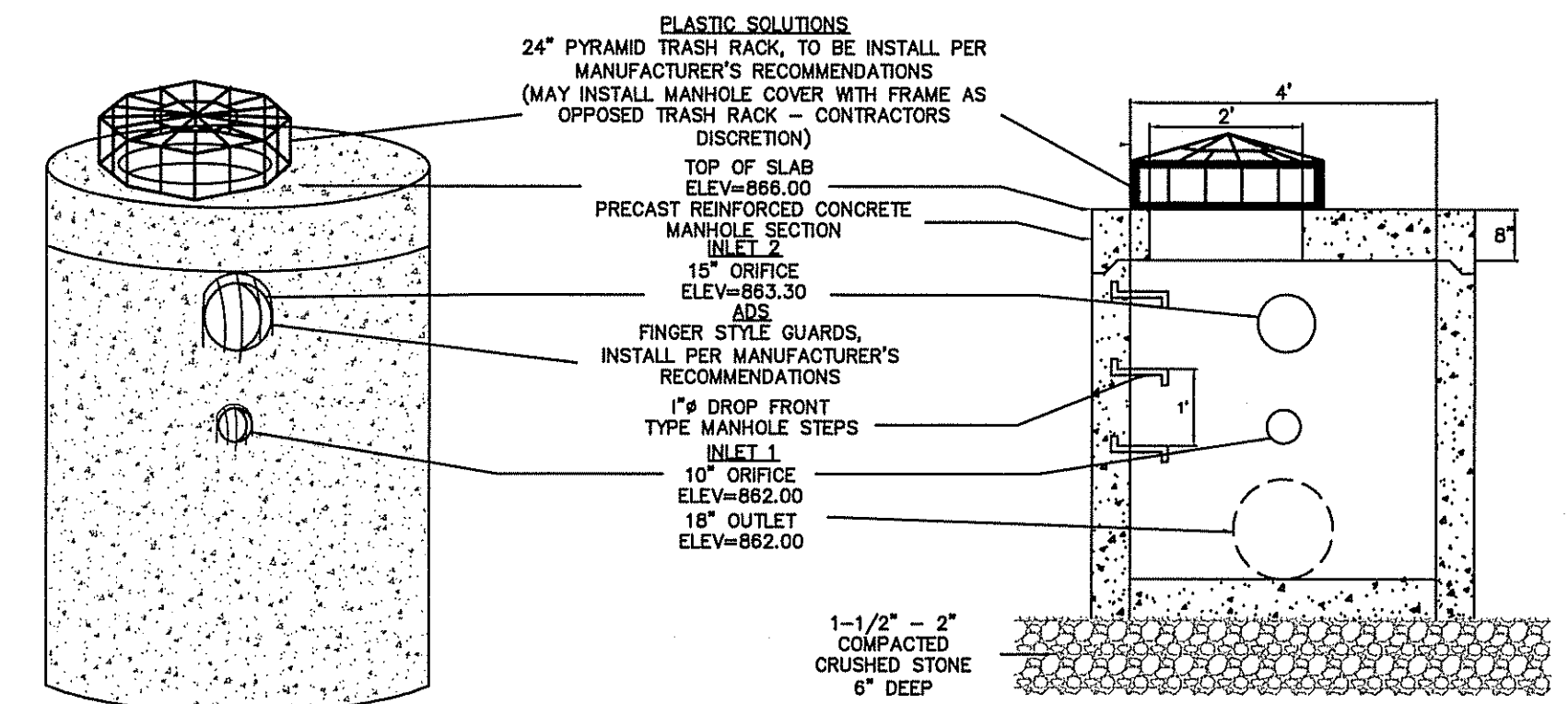
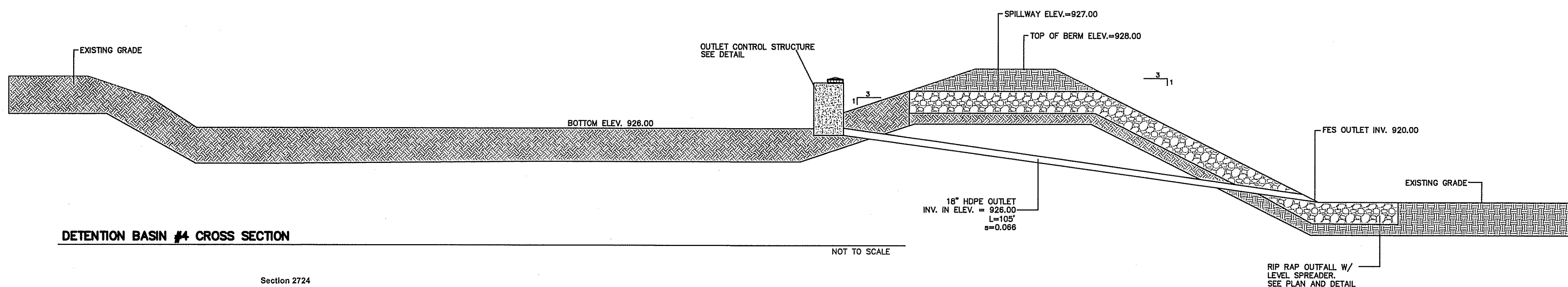
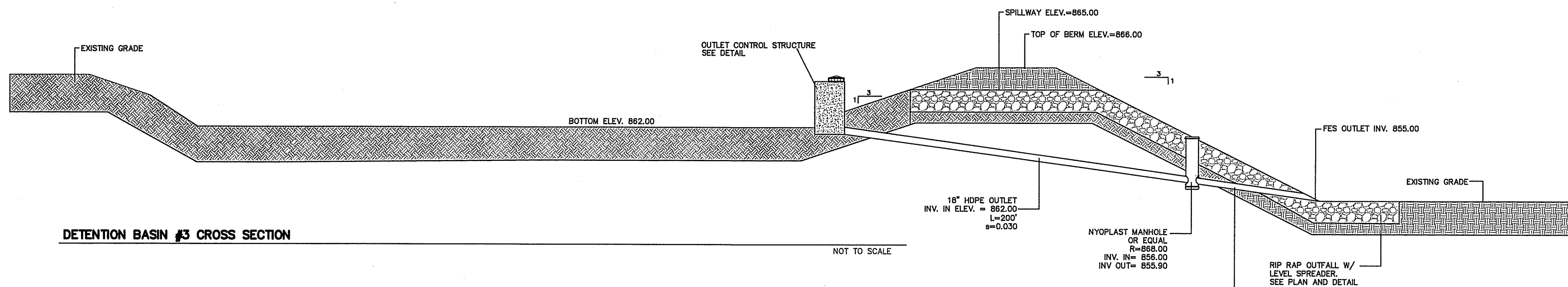
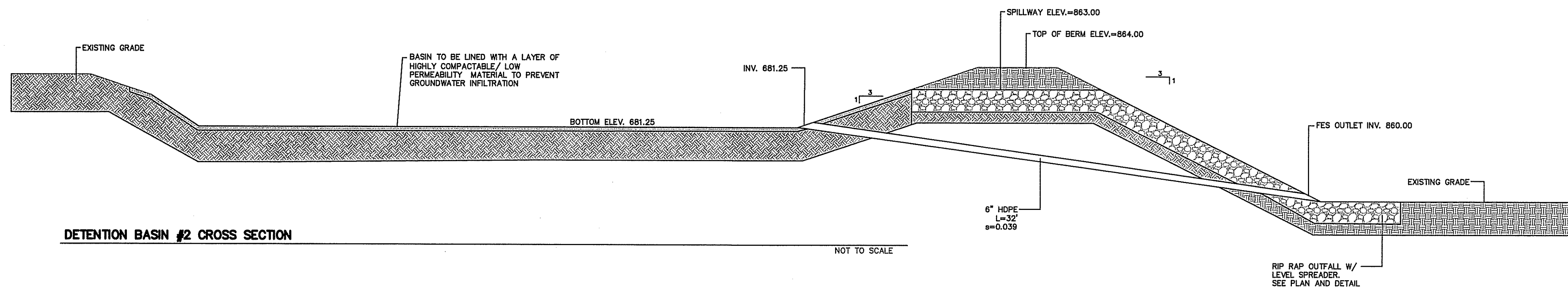
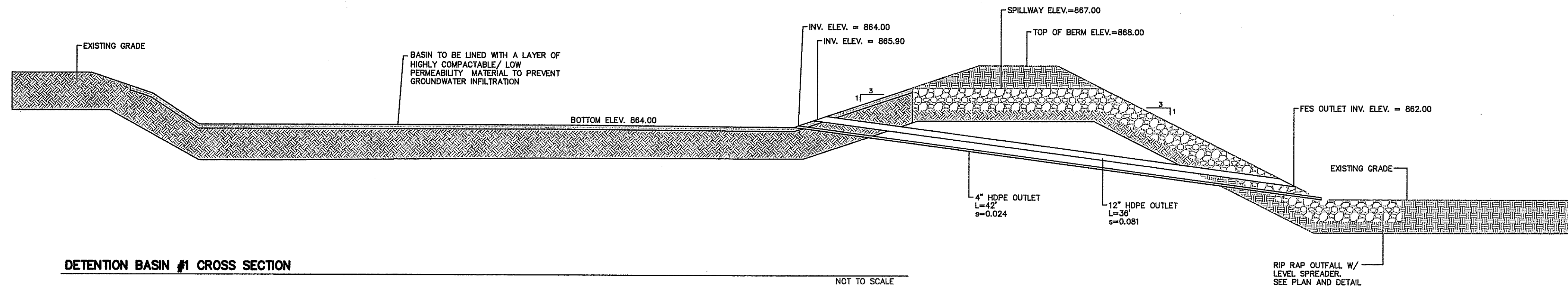

**GENERAL**  
PVC surface drainage inlets shall be of the road and highway structure type as indicated on the contract drawings and referenced within the contract specifications. The ductile iron frame and grate for each of these structures is to be considered an integral part of the surface drainage inlet and shall be furnished by the same manufacturer. The road and highway structure shall be as manufactured by Nyloplast a division of Advanced Drainage Systems, Inc. or prior approved equal.

**MATERIALS**  
The road and highways structure required for this contract shall be manufactured from PVC pipe stock, utilizing a thermo-molding process to reform the pipe stock to the specified configuration. The drainage pipe connection stubs shall be manufactured from PVC pipe stock and formed to provide a watertight connection with the specified pipe system. This joint tightness shall conform to ASTM D3212 for joints for drain and sewer pipe using flexible elastomeric seals. The flexible elastomeric seals shall conform to ASTM F477. The pipe bell spigot shall be joined to the main body of the structure. The raw material used to manufacture the pipe stock that is used to manufacture the main body and pipe stubs of the surface drainage inlets shall conform to ASTM D1784 cell class 12454.

The grate and frame for all road and highway structures shall be ductile iron and shall be made specifically for each so as to provide a round bottom flange that closely matches the diameter of the PVC basin body. The grate and frame shall be capable of supporting H-20 wheel loading for traffic areas. The metal used in the manufacture of the castings shall conform to ASTM A536 grade 70-50-05 for ductile iron.

### INSTALLATION

The specified PVC road and highway structure shall be installed using conventional flexible pipe backfill materials and procedures. The backfill shall be crushed stone or other granular material meeting the requirements of class 1, class 2, or class 5 material as defined in *ASTM D2321*. Bedding and backfill for the road and highway structure shall be placed and compacted uniformly in accordance with *ASTM D2321*. The road and highway structure body will be cut at the time of the final grade. No brick, stone or concrete block will be required to set the grate to the final grade height. For H-20 load rated installations, a concrete ring will be poured under and around the grate and frame. The concrete slab must be designed taking into consideration local soil conditions, traffic loading, and other applicable design factors. For other installation considerations such as migration of fines, ground water, and soil foundations refer to *ASTM D2321* guidelines.

TOWN OF LEICESTER PLANNING BOARD

DATE:

NORTH

|  |      |
|--|------|
|  | STAN |
|--|------|

DRAWN BY:

CKED BY:

CLIENT: SYNCARPHA SOLAR, LLC  
250 W 57TH STREET, SUITE 70  
NEW YORK, NY 10107

DETAILS SHEET (2/2)  
SITE ADDRESS:  
MULBERRY STREET  
LEICESTER, MA 01524



**BERTIN**  
ENGINEERING

39 ELM STREET  
SOUTHBRIDGE, MA 01550  
P 508.765.0195  
F 508.765.0193  
[www.bertinengineering.com](http://www.bertinengineering.com)

|               |       |
|---------------|-------|
| MA. LIC. NO.: | 40595 |
| CT. LIC. NO.: | 12950 |
| RI. LIC. NO.: | 6694  |
| NH. LIC. NO.: | 9368  |

**BRUCE A.  
FITZBACK, P.L.S.**  
PROFESSIONAL  
LAND SURVEYOR  
MA. LIC. NO.: 37731  
CT. LIC. NO.: 16970

PROFESSIONAL ENGINEER  
MA. LIC. NO.: 47597

PETER C.  
ENGLE, P.E.  
PROFESSIONAL ENGINEER  
MA LIC NO: 53736

DATE \_\_\_\_\_

SCAL

REV 1

PROJECT #:

DWG NO:

ORIGINAL  
7-11-18