

F:\21813 Leicester MS - Finegold Alexander\Graphics\Revit\2019-11-18 99% Revit\2019.11.17_Leicester Model_R19.rvt
11/18/2019 9:51:12 AM

NOTES:
PEAK PARKING COUNT OBSERVED: 160

TOWN OF LEICESTER PLANNING BOARD
LANDSCAPING REGULATIONS (20 JUNE,
2017) STATE:
1.) LANDSCAPE ISLANDS MUST BE 5'-0"
WIDE MINIMUM
2.) 10 SF OF LANDSCAPING MUST BE
PROVIDED FOR EVERY 200 SF OF
PARKING SPACE
3.) TREES WITHIN LANDSCAPE ISLANDS
MUST BE A MAXIMUM OF 35' APART
4.) TREE SPECIES TO BE SELECTED
FROM THE SUGGESTED PLANTING LIST
FOR THE ALB QUARANTINE ZONE

PARKING ANALYSIS			
PARKING COUNTS		EXISTING	REQUIRED
TOTAL PARKING COUNT		176	270
ACCESSIBLE PARKING SPACES		7	6
ELECTRIC VEHICLE CHARGING ACCESS		4	4
LEED REQUIREMENT (2%)		10	10
GREEN VEHICLE SPACES (LEED REQUIREMENT)		10	10
AREA		AREA	
TOTAL PARKING LOT		107635 SF	
PARKING SPACES		30780 SF	
LANDSCAPE		13146 SF	
MANEUVERING SPACE		13725 SF	
OTHER (SIDEWALKS)		3079 SF	
ZONING REQUIREMENT		REQUIRED	PROPOSED
PARKING SPACE SIZE		10'x20'	9'x18'
ONE SHADE TREE PER 15 PARKING SPACES		6	21
TOTAL AMOUNT OF LANDSCAPE AREA WITHIN PARKING LOT IS EQUAL TO MINIMUM OF 5% AREA OF PARKING SPACE PROVIDED		5%	42.7%

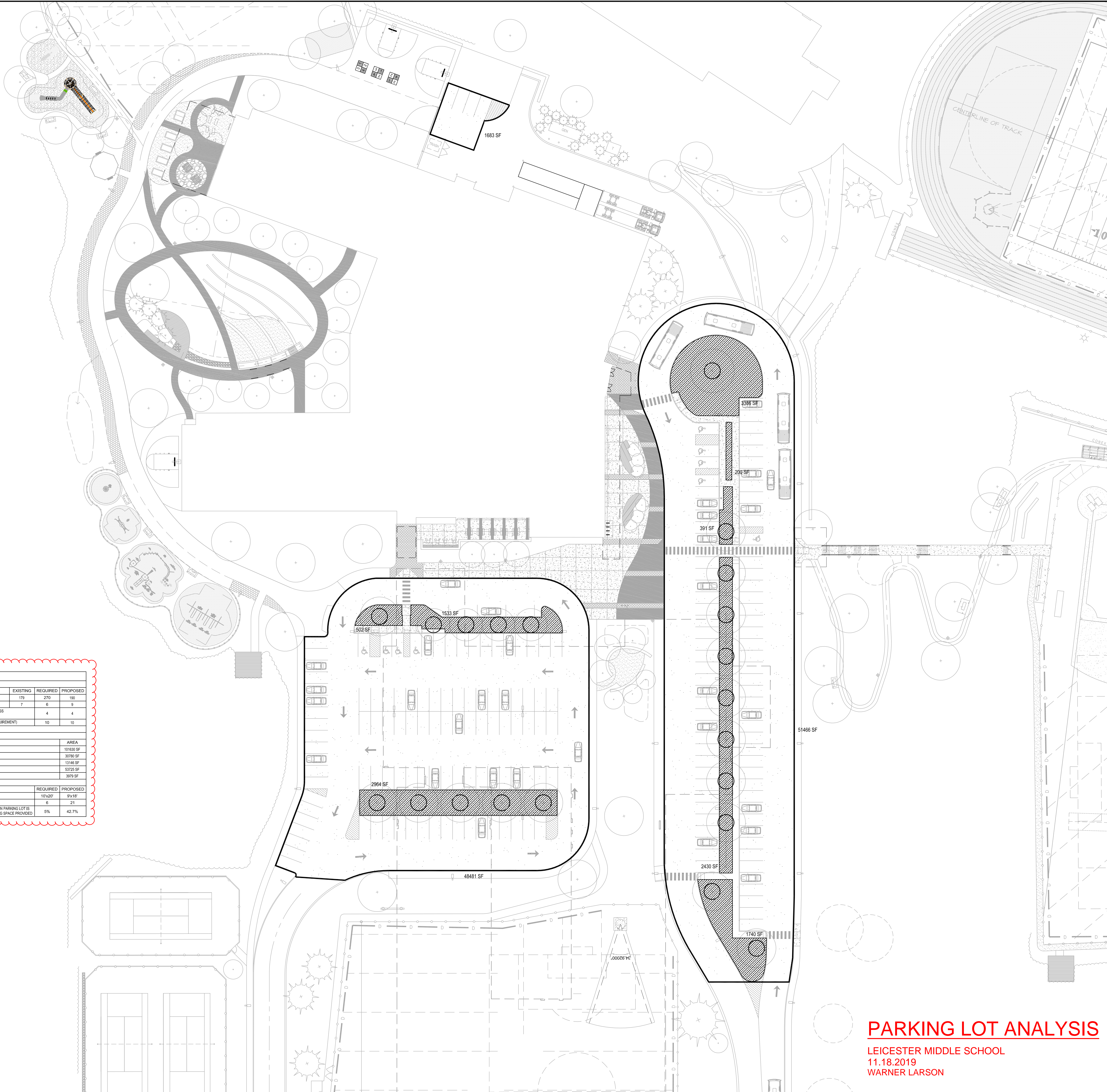

PARKING LOT ANALYSIS
LEICESTER MIDDLE SCHOOL
11.18.2019
WARNER LARSON

Finegold Alexander Architects

PROJECT TEAM:

OWNER:

KEY PLAN:

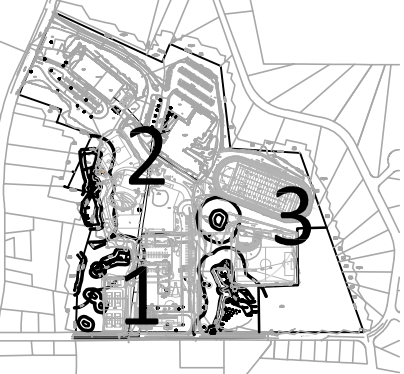

NORTH

SEAL:

PROJECT INFORMATION:
5C - Wings PreK-8

PROJECT #:
PROJECT ISSUE DATE:
PROJECT STATUS:
SHEET NAME:

DRAWING HISTORY:
NO. DATE DESCRIPTION

SHEET #:

PAXTON STREET

HYLAND AVENUE

ELEMENTARY
SCHOOL

HIGH
SCHOOL

NEW
SCHOOL

SENIOR
CENTER

WINSLOW AVENUE

SLEDDING

PERGOLA

GARAGE

FIRELANE DOCK #2

RETAINING WALL

STAIRS

CURB STEPS IN LAWN SEATING

ACCESSIBLE PATH

CANOPY

FLAGPOLE

80

106

DISCUS

U-12 FIELD

EXISTING BUILDING

15

14

13

2

4

1

3

5

6

12

11

7

8

9

10