

SUNCONNECT  
PROPOSED SOLAR ARRAY

LOCATED AT :  
9 MCNEIL HIGHWAY  
LEICESTER, MA 01524

TOWN OF LEICESTER ZONING

ZONE - HB-1  
AREA - 60,000 S.F.  
FRONTAGE - 200'  
FRONT - 50 FT.  
SIDE - 50 FT.  
REAR - 50 FT.

RECORD OWNER (S):

ANTANAVICA 2012 REALTY TRUST  
DB. 51038 PG. 108  
ASSESSORS REF. MAP 17, BLOCK A, PARCEL 8.4

TAX MAP REFERENCES:

ASSESSORS REF. MAP 17, BLOCK A, PARCEL 8.4

PLAN REFERENCES:

(WORCESTER COUNTY REGISTRY OF DEEDS)

PLAN BOOK 710 PLAN 122  
PLAN BOOK 721 PLAN 108

DEVELOPER

SUNCONNECT  
3021 AIRPORT PULLING ROAD SUITE 201  
NAPLES, FL 34105



SITE LOCUS  
SCALE: 1"=1000'

DRAWING LIST	
SYM	NAME
CVR	COVER SHEET
E	EXISTING PLAN
S-1	PROPOSED SITE PLAN
G-1	PROPOSED GRADING & DRAINAGE PLAN
EC-1	SWPPP/ EROSION CONTROL PLAN
D-1	DETAIL SHEET

RESERVED FOR USE BY LEICESTER PLANNING BOARD

SYMBOL KEY

MONUMENT	□	BITUMINOUS	BIT.
IRON PIPE	●	CONCRETE	CONC.
DRAIN MANHOLE	○	INVERT	INV.
ELECTRIC MANHOLE	⊙	REINFORCED CONCRETE PIPE	RCP
CATCH BASIN	■	POLYVINYL CHLORIDE PIPE	PVC
UTILITY POLE	⊕	HIGH DENSITY PLASTIC	HDPE
GUY WIRE	—	IRON PIPE	I.P.
BENCH MARK	⊙	FOUND	FND.
CHAIN LINK FENCE	—x—	BOLLARD	BOL.
WOOD / STOCKADE FENCE	—o—	SEWER MANHOLE	SMH
DRAIN LINE	—d—	DRAINAGE MANHOLE	DMH
OVERHEAD WIRES	—ow—	WATER GATE	WG
CONTOUR 5' INTERVAL	—5'—	HYDRANT	HYD.
CONTOUR 1' INTERVAL	—1'—	UTILITY POLE	UP
X 69.33'	—	GUY WIRE	GUY
	SPOT GRADE		



NORTH	3 12/13/16 RESUBMISSION DUE TO PERMIT EXPIRATION PE	2 10/6/15 PER FIRE DEPARTMENT LLW	1 10/1/15 PER REVIEW ENGINEER AND PLANNINGBOARD LLW	NO. DATE REVISION BY	DRAWN BY: PCE CALISTO J. BERTIN, P.E. PROFESSIONAL ENGINEER CT. LIC. NO.: 12950 MA. LIC. NO.: 40595 N.H. LIC. NO.: 9368 N.J. LIC. NO.: 28845 N.Y. LIC. NO.: 60022 R.I. LIC. NO.: 6694	CHECKED BY: MFL FRANK W. BICCHIERI, P.E. PROFESSIONAL ENGINEER MA. LIC. NO.: 47597 BRUCE A. FITZBACK, P.L.S. PROFESSIONAL LAND SURVEYOR MA. LIC. NO.: 37731 CT. LIC. NO.: 16970	CLIENT: SunConnect 3021 Airport Pulling Rd. Suite 201 Naples, FL 34105
					COVER SHEET SITE ADDRESS: 9 McNeil Highway Leicester, MA 01524	39 ELM STREET SOUTHBRIDGE, MA 01550 P 508.765.0195 F 508.765.0193 www.bertinengineering.com	
DATE: 3.18.15		SCALE: As-Noted	REV #: 3	PROJECT #: 15-642	DWG. NO.: CVR		



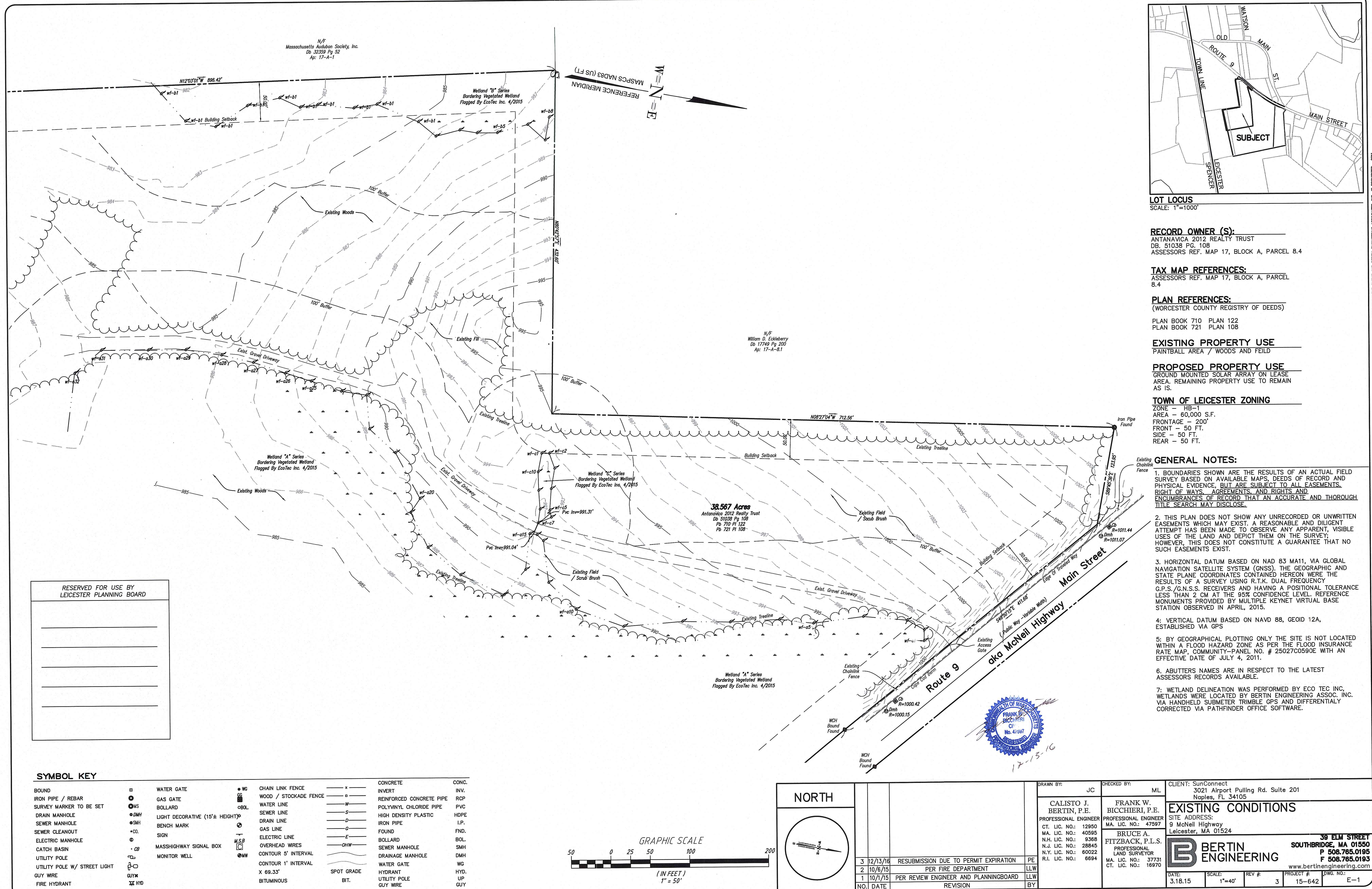



3:1 SLOPE TO BE STABILIZED  
WITH GEOTEXTILE LINING  
LOAM AND SEED DISTURBED AREAS

N/F  
Massachusetts Audubon Society, Inc.  
Dd 32359 Pg 52  
Apr 17-A-1

Wetland "D" Series  
Bordering Vegetated Wetland  
Flagged By EcoTec Inc. 4/2015

N/F  
William D. Eckinberry  
Dd 17749 Pg 200  
Apr 17-A-8.1

#### SOLAR PANEL ARRAY SUMMARY CHART

ARRAY	TOTAL
Panels	4,128
Watts Per Module	315
Total Watts DC, STC	315 x 4,128=1,300,320
SITE TOTAL 1.3 MW	

LANDSCAPE TABLE	QTY.
● MOUNTAIN LAUREL BUSHES (2'-3")	8
● LOW GROWTH LILAC BUSHES 3 GAL. BUCKETS (3 PER AREA)	16
● SPRUCE TREES (3.5" CALIPER)	6
● HONEY LOCUST (3.5" CALIPER)	7

#### GRAPHIC SCALE

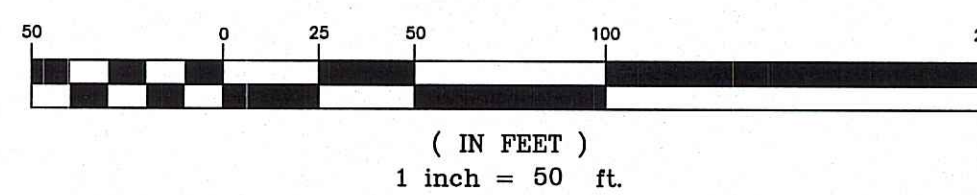

NORTH

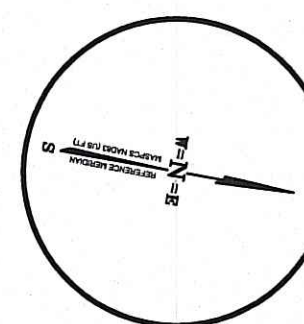

DRAWN BY: PE	CHECKED BY: ML	CLIENT: SunConnect 3021 Airport Pulling Rd. Suite 201 Naples, FL 34105
CALISTO J. BERTIN, P.E. PROFESSIONAL ENGINEER CT. LIC. NO.: 12950 MA. LIC. NO.: 40595 N.H. LIC. NO.: 9368 N.J. LIC. NO.: 28845 N.Y. LIC. NO.: 60022 R.I. LIC. NO.: 6694	FRANK W. BICCHIERI, P.E. PROFESSIONAL ENGINEER MA. LIC. NO.: 47597 BRUCE A. FITZBACK, P.L.S. PROFESSIONAL LAND SURVEYOR MA. LIC. NO.: 37731 CT. LIC. NO.: 16970	<b>OVERALL SITE LAYOUT</b> SITE ADDRESS: 9 McNeil Highway Leicester, MA 01524 <b>B BERTIN ENGINEERING</b> 39 ELM STREET SOUTHBRIDGE, MA 01550 P 508.765.0195 F 508.765.0193 www.bertinengineering.com
DATE: 3.18.15	SCALE: 1"=50'	REV #: 3
PROJECT #: 15-642	DWG. NO.: S-1	

NO.	DATE	REVISION	BY
3	12/13/16	RESUBMISSION DUE TO PERMIT EXPIRATION	PE
2	10/6/15	PER FIRE DEPARTMENT	LLW
1	10/1/15	PER REVIEW ENGINEER AND PLANNING BOARD	LLW

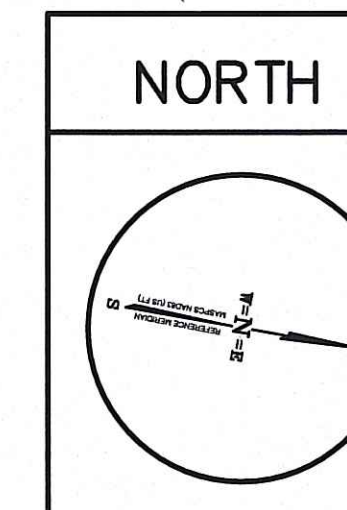

[illegible]



3:1 SLOPE TO BE STABILIZED  
WITH GEOTEXTILE LINING  
LOAM AND SEED DISTURBED AREAS

N/F  
Massachusetts Audubon Society, Inc.  
Db 32359 Pg 52  
Ap: 17-A-1

Wetland "B" Series  
Bordering Vegetated Wetland  
Flagged By EcoTec Inc. 4/2015

#### GENERAL EROSION NOTES:

- THE STORM WATER POLLUTION PREVENTION PLAN IS COMPRISED OF THIS DRAWING ("SITE MAP"), THE STANDARD DETAILS, THE PLAN NARRATIVE.
- ALL CONTRACTORS AND SUBCONTRACTORS INVOLVED WITH STORM WATER POLLUTION PREVENTION SHALL OBTAIN A COPY OF THE STORM WATER POLLUTION PREVENTION PLAN AND THE STATE OF MASSACHUSETTS NATIONAL POLLUTANT DISCHARGE ELIMINATION SYSTEM GENERAL PERMIT (NPDES PERMIT) AND BECOME FAMILIAR WITH THEIR CONTENT.
- CONTRACTOR SHALL IMPLEMENT BEST MANAGEMENT PRACTICES (BMP's) AS REQUIRED BY THE SWPPP. ADDITIONAL BEST MANAGEMENT PRACTICES SHALL BE IMPLEMENTED AS DIRECTED BY CONDITIONS AT NO ADDITIONAL COST OF OWNER THROUGHOUT ALL PHASES OF CONSTRUCTION.
- BMP's AND CONTROLS SHALL CONFORM TO FEDERAL, STATE OR LOCAL REQUIREMENTS OR MANUAL OF PRACTICE, AS APPLICABLE. CONTRACTOR SHALL IMPLEMENT ADDITIONAL CONTROLS AS DIRECTED BY PERMITTING AGENCY OR OWNER.
- SITE MAP MUST CLEARLY DELINEATE ALL STATE WATERS, PERMITS FOR ANY CONSTRUCTION ACTIVITY IMPACTING STATE WATERS OR REGULATED WETLANDS MUST BE MAINTAINED ON SITE AT ALL TIMES.
- CONTRACTOR SHALL MINIMIZE CLEARING TO THE MAXIMUM EXTENT PRACTICAL OR AS REQUIRED BY THE GENERAL PERMIT.
- GENERAL CONTRACTOR SHALL DENOTE ON PLAN THE TEMPORARY PARKING AND STORAGE AREA WHICH SHALL ALSO BE USED AS THE EQUIPMENT MAINTENANCE AND CLEANING AREA, EMPLOYEE PARKING AREA AND AREA FOR LOCATING PORTABLE FACILITIES, OFFICE TRAILERS, AND TOILET FACILITIES.
- ALL WASH WATER (CONCRETE TRUCKS, VEHICLE CLEANING, EQUIPMENT CLEANING, ETC.) SHALL BE DETAINED AND PROPERLY TREATED OR DISPOSED.
- SUFFICIENT OIL AND GREASE ABSORBING MATERIALS AND FLotation BOOMS SHALL BE MAINTAINED ON SITE OR READILY AVAILABLE TO CONTAIN AND CLEANUP FUEL OR CHEMICAL SPILLS AND LEAKS.
- DUST ON THE SITE SHALL BE CONTROLLED. THE USE OF MOTOR OILS AND OTHER PETROLEUM BASED OR TOXIC LIQUIDS FOR DUST SUPPRESSION OPERATIONS IS PROHIBITED.
- RUBBISH, TRASH, GARBAGE, LITTER, OR OTHER SUCH MATERIALS SHALL BE DEPOSITED INTO SEALED CONTAINERS. MATERIALS SHALL BE PREVENTED FROM LEAVING THE PREMISES THROUGH THE ACTION OF WIND OR STORM WATER DISCHARGE INTO DRAINAGE DITCHES OR WATER OF THE STATE.
- ALL STORM WATER POLLUTION PREVENTION MEASURES PRESENTED ON THIS PLAN, AND IN THE STORM WATER POLLUTION PREVENTION PLAN, SHALL BE INITIATED AS SOON AS PRACTICABLE.

- DISTURBED PORTIONS OF THE SITE WHERE CONSTRUCTION ACTIVITY HAS STOPPED FOR AT LEAST 21 DAYS, SHALL BE TEMPORARILY SEED. THESE AREAS SHALL BE SEED NO LATER THAN 14 DAYS FROM THE LAST CONSTRUCTION ACTIVITY OCCURRING IN THESE AREAS.
- DISTURBED PORTIONS OF THE SITE WHERE CONSTRUCTION ACTIVITY HAS PERMANENTLY STOPPED SHALL BE PERMANENTLY SEED. THESE AREAS SHALL BE SEED NO LATER THAN 14 DAYS FROM THE LAST CONSTRUCTION ACTIVITY OCCURRING IN THESE AREAS. REFER TO THE GRADING PLAN AND/OR LANDSCAPE PLAN.
- IF THE ACTION OF VEHICLES TRAVELING OVER THE GRAVEL CONSTRUCTION ENTRANCES IS NOT SUFFICIENT TO REMOVE THE MAJORITY OF DIRT OF MUD, THEN THE TIRES MUST BE WASHED BEFORE THE VEHICLES ENTER A PUBLIC ROAD. IF WASHING IS USED, PROVISIONS MUST BE MADE TO INTERCEPT THE WASH WATER AND TRAP THE SEDIMENT BEFORE IT IS CARRIED OFF THE SITE.
- ALL MATERIALS SPILLED, DROPPED, WASHED OR TRACKED FROM VEHICLES ONTO ROADWAYS, OR INTO STORM DRAINS MUST BE REMOVED IMMEDIATELY.
- CONTRACTORS OR SUBCONTRACTORS WILL BE RESPONSIBLE FOR REMOVING SEDIMENTS IN THE INFILTRATION POND AND ANY SEDIMENT THAT MAY HAVE COLLECTED IN THE STORM SEWER DRAINAGE SYSTEMS IN CONJUNCTION WITH THE STABILIZATION OF THE SITE.
- ON-SITE & OFF-SITE SOIL STOCKPILE AND BORROW AREAS SHALL BE PROTECTED FROM EROSION AND SEDIMENTATION THROUGH IMPLEMENTATION OF BMP's. STOCKPILE AND BORROW AREA LOCATION SHALL BE NOTED ON THE SITE MAP AND PERMITTED IN ACCORDANCE WITH GENERAL PERMIT REQUIREMENTS.
- SLOPES SHALL BE LEFT IN A ROUGHENED CONDITION DURING THE GRADING PHASE TO REDUCE RUNOFF VELOCITIES AND EROSION.
- DUE TO THE GRADE CHANGES DURING THE DEVELOPMENT OF THE PROJECT, THE CONTRACTOR SHALL BE RESPONSIBLE FOR ADJUSTING THE EROSION CONTROL MEASURES (SILT FENCES, STRAW BALES, ETC) TO PREVENT EROSION.
- ALL CONSTRUCTION SHALL BE STABILIZED AT THE END OF EACH WORKING DAY, THIS INCLUDES BACK FILLING OF TRENCHES FOR UTILITY CONSTRUCTION AND PLACEMENT OF GRAVEL OR BITUMINOUS PAVING FOR ROAD CONSTRUCTION.

N/F  
William D. Eckleberry  
Db 17749 Pg 200  
Ap: 17-A-6.1

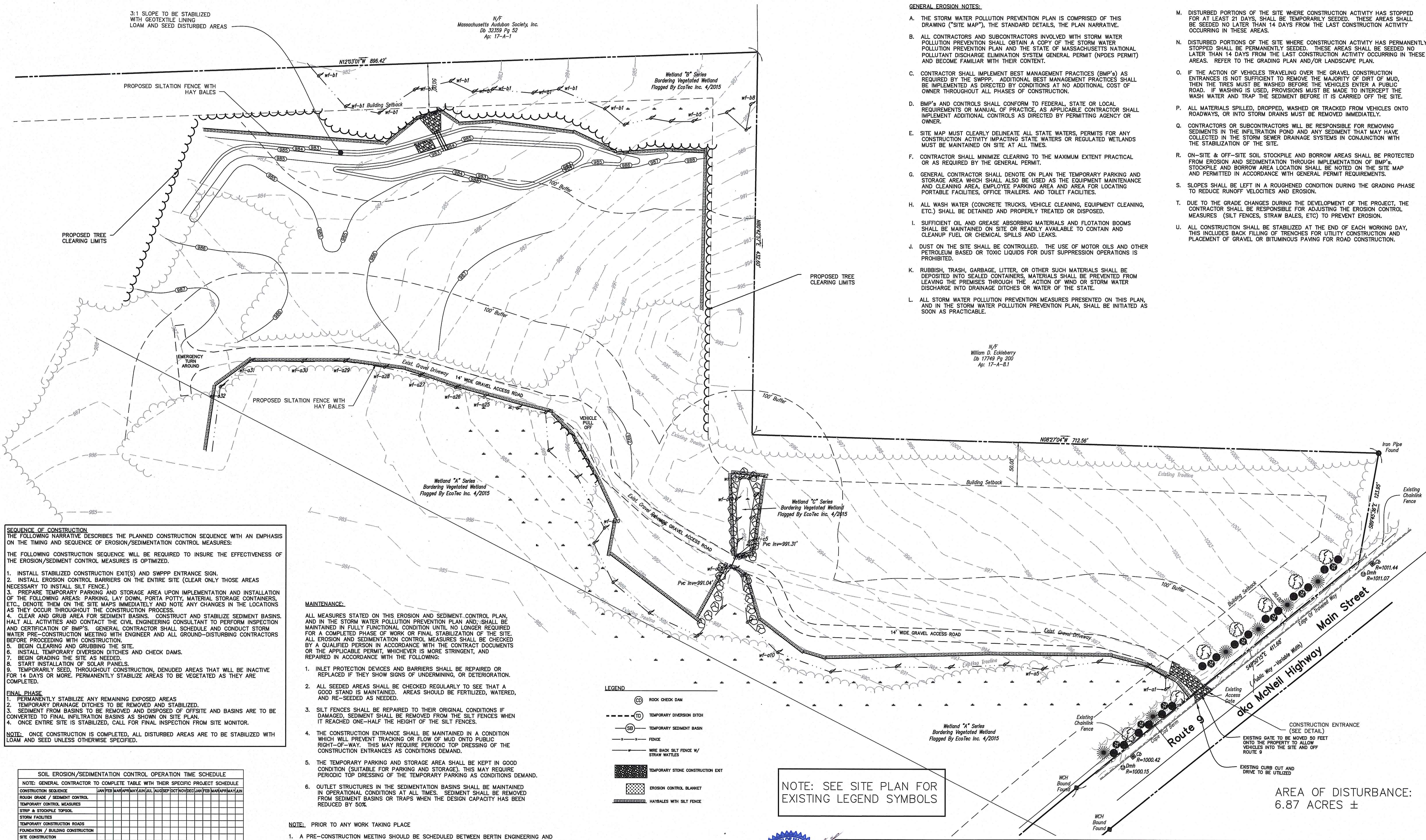

#### SEQUENCE OF CONSTRUCTION

THE FOLLOWING NARRATIVE DESCRIBES THE PLANNED CONSTRUCTION SEQUENCE WITH AN EMPHASIS ON THE TIMING AND SEQUENCE OF EROSION/SEDIMENTATION CONTROL MEASURES:

THE FOLLOWING CONSTRUCTION SEQUENCE WILL BE REQUIRED TO INSURE THE EFFECTIVENESS OF THE EROSION/SEDIMENTATION CONTROL MEASURES IS OPTIMIZED.

- INSTALL STABILIZED CONSTRUCTION EXITS(S) AND SWPPP ENTRANCE SIGN.
- INSTALL EROSION CONTROL BARRIERS ON THE ENTIRE SITE (CLEAR ONLY THOSE AREAS NECESSARY TO INSTALL SILT FENCE).
- PREPARE TEMPORARY PARKING AND STORAGE AREA UPON INSTALLATION AND INSTALLATION OF THE FOLLOWING AREAS: PARKING, LAY DOWN, PORTA POTT, MATERIAL STORAGE CONTAINERS, ETC., DENOTE THEM ON THE SITE MAPS IMMEDIATELY AND NOTE ANY CHANGES IN THE LOCATIONS AS THEY OCCUR THROUGHOUT THE CONSTRUCTION PROCESS.
- CLEAR AND GRUB AREA FOR SEDIMENT BASINS. CONSTRUCT AND STABILIZE SEDIMENT BASINS. HALT ALL ACTIVITIES AND CONTACT THE CIVIL ENGINEERING CONSULTANT TO PERFORM INSPECTION AND CERTIFICATION OF BMP'S. GENERAL CONTRACTOR SHALL SCHEDULE AND CONDUCT STORM WATER PRE-CONSTRUCTION MEETING WITH ENGINEER AND ALL GROUND-DISTURBING CONTRACTORS BEFORE PROCEEDING WITH CONSTRUCTION.
- BEGIN CLEARING AND GRUBBING THE SITE.
- INSTALL TEMPORARY DIVERSION DITCHES AND CHECK DAMS.
- BEGIN GRADING THE SITE AS NEEDED.
- START INSTALLATION OF SOLAR PANELS.
- TEMPORARILY SEED, THROUGHOUT CONSTRUCTION, DENUDED AREAS THAT WILL BE INACTIVE FOR 14 DAYS OR MORE. PERMANENTLY STABILIZE AREAS TO BE VEGETATED AS THEY ARE COMPLETED.

#### FINAL PHASE

- PERMANENTLY STABILIZE ANY REMAINING EXPOSED AREAS.
- TEMPORARY DRAINAGE DITCHES TO BE REMOVED AND STABILIZED.
- SEDIMENT FROM BASINS TO BE REMOVED AND DISPOSED OF OFFSITE AND BASINS ARE TO BE CONVERTED TO FINAL INFILTRATION BASINS AS SHOWN ON SITE PLAN.
- ONCE ENTIRE SITE IS STABILIZED, CALL FOR FINAL INSPECTION FROM SITE MONITOR.

NOTE: ONCE CONSTRUCTION IS COMPLETED, ALL DISTURBED AREAS ARE TO BE STABILIZED WITH LOAM AND SEED UNLESS OTHERWISE SPECIFIED.

#### MAINTENANCE:

ALL MEASURES STATED ON THIS EROSION AND SEDIMENT CONTROL PLAN, AND IN THE STORM WATER POLLUTION PREVENTION PLAN AND, SHALL BE MAINTAINED IN FULLY FUNCTIONAL CONDITION UNTIL NO LONGER REQUIRED FOR A COMPLETED PHASE OF WORK OR FINAL STABILIZATION OF THE SITE. ALL EROSION AND SEDIMENTATION CONTROL MEASURES SHALL BE CHECKED BY A QUALIFIED PERSON IN ACCORDANCE WITH THE CONTRACT DOCUMENTS OR THE APPLICABLE PERMIT, WHICHEVER IS MORE STRINGENT, AND REPAIRED IN ACCORDANCE WITH THE FOLLOWING:

- INLET PROTECTION DEVICES AND BARRIERS SHALL BE REPAIRED OR REPLACED IF THEY SHOW SIGNS OF UNDERMINING, OR DETERIORATION.
- ALL SEEDS AREAS SHALL BE CHECKED REGULARLY TO SEE THAT A GOOD STAND IS MAINTAINED. AREAS SHOULD BE FERTILIZED, WATERED, AND RE-SEED AS NEEDED.
- SILT FENCES SHALL BE REPAIRED TO THEIR ORIGINAL CONDITIONS IF DAMAGED. SEDIMENT SHALL BE REMOVED FROM THE SILT FENCES WHEN IT REACHED ONE-HALF THE HEIGHT OF THE SILT FENCES.
- THE CONSTRUCTION ENTRANCE SHALL BE MAINTAINED IN A CONDITION WHICH WILL PREVENT TRACKING OR FLOW OF MUD ONTO PUBLIC RIGHT-OF-WAY. THIS MAY REQUIRE PERIODIC TOP DRESSING OF THE CONSTRUCTION ENTRANCES AS CONDITIONS DEMAND.
- THE TEMPORARY PARKING AND STORAGE AREA SHALL BE KEPT IN GOOD CONDITION (SUITABLE FOR PARKING AND STORAGE). THIS MAY REQUIRE PERIODIC TOP DRESSING OF THE TEMPORARY PARKING AS CONDITIONS DEMAND.
- OUTLET STRUCTURES IN THE SEDIMENTATION BASINS SHALL BE MAINTAINED IN OPERATIONAL CONDITIONS AT ALL TIMES. SEDIMENT SHALL BE REMOVED FROM SEDIMENT BASINS OR TRAPS WHEN THE DESIGN CAPACITY HAS BEEN REDUCED BY 50%.

#### NOTE: PRIOR TO ANY WORK TAKING PLACE

- A PRE-CONSTRUCTION MEETING SHOULD BE SCHEDULED BETWEEN BERTIN ENGINEERING AND CONSTRUCTION MANAGER. ALL ASPECTS OF EROSION CONTROLS AND CONSTRUCTION OF PROJECT ARE TO BE DISCUSSED.
- STRAW WATTLE AND SILTATION FENCE TO BE INSTALLED. INSTALL STABILIZED CONSTRUCTION ENTRANCE (SITE TRACKING PAD).
- WEEKLY INSPECTIONS AND AFTER ALL HEAVY RAINFALL ARE TO BE CONDUCTED BY SITE MONITOR AND LOGS ARE TO BE FILLED OUT. ANY REPAIR TO EROSION CONTROL DEVICES ARE TO BE MADE AS NEEDED.

#### LEGEND

- ROCK CHECK DAM
- TEMPORARY DIVERSION DITCH
- TEMPORARY SEDIMENT BASIN
- FENCE
- WIRE BACK SILT FENCE W/ STRAW WATTLES
- TEMPORARY STONE CONSTRUCTION EXIT
- EROSION CONTROL BLANKET
- HAYBALES WITH SILT FENCE

NOTE: SEE SITE PLAN FOR EXISTING LEGEND SYMBOLS

#### GRAPHIC SCALE

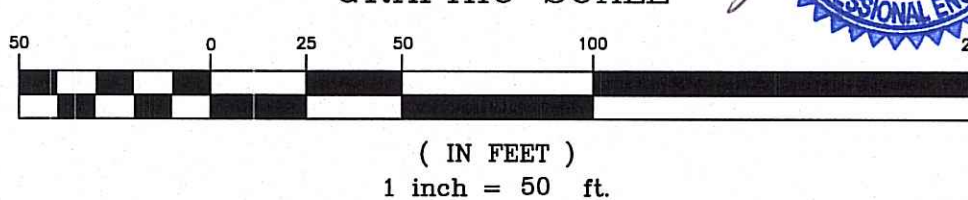

#### NORTH

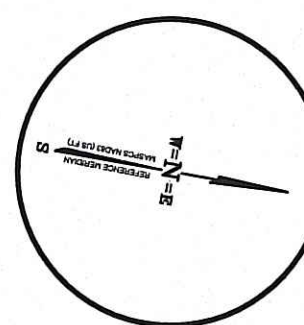

SOIL EROSION/SEDIMENTATION CONTROL OPERATION TIME SCHEDULE	
NOTE: GENERAL CONTRACTOR TO COMPLETE TABLE WITH THEIR SPECIFIC PROJECT SCHEDULE	
CONSTRUCTION SEQUENCE	JAN FEB MAR APR MAY JUN JUL AUG SEP OCT NOV DEC JAN FEB MAR APR MAY JUN
ROUGH GRADE / SEDIMENT CONTROL	
TEMPORARY CONTROL MEASURES	
STRIP & STOCKPILE TOPSOIL	
STORM FACILITIES	
TEMPORARY CONSTRUCTION ROADS	
FOUNDATION / BUILDING CONSTRUCTION	
SITE CONSTRUCTION	
PERMANENT CONTROL STRUCTURES	
FINISH GRADING	
LANDSCAPING/SEED/FINAL STABILIZATION	

3/12/16	RESUBMISSION DUE TO PERMIT EXPIRATION	PE
2/10/6/15	PER FIRE DEPARTMENT	LLW
1/10/1/15	PER REVIEW ENGINEER AND PLANNINGBOARD	LLW
NO. DATE	REVISION	BY

DRAWN BY: PE	CHECKED BY: ML	CLIENT: SunConnect 3021 Airport Pulling Rd. Suite 201 Naples, FL 34105
CALISTO J. BERTIN, P.E. PROFESSIONAL ENGINEER CT. LIC. NO.: 12950 MA. LIC. NO.: 40595 N.H. LIC. NO.: 9368 N.J. LIC. NO.: 28845 N.Y. LIC. NO.: 60022 R.I. LIC. NO.: 6694	FRANK W. BICCHIERI, P.E. PROFESSIONAL ENGINEER MA. LIC. NO.: 47597 BRUCE A. FITZBACK, P.L.S. PROFESSIONAL LAND SURVEYOR MA. LIC. NO.: 37731 CT. LIC. NO.: 16970	<b>SWPP PLAN</b> SITE ADDRESS: 9 McNeil Highway Leicester, MA 01524
<b>BERTIN ENGINEERING</b> www.bertinengineering.com		<b>39 ELM STREET</b> SOUTHBRIDGE, MA 01550 P 508.765.0195 F 508.765.0193
DATE: 3.18.15	SCALE: 1"=50'	REV #: 3
PROJECT #: 15-642	DWS. NO.: EC-1	



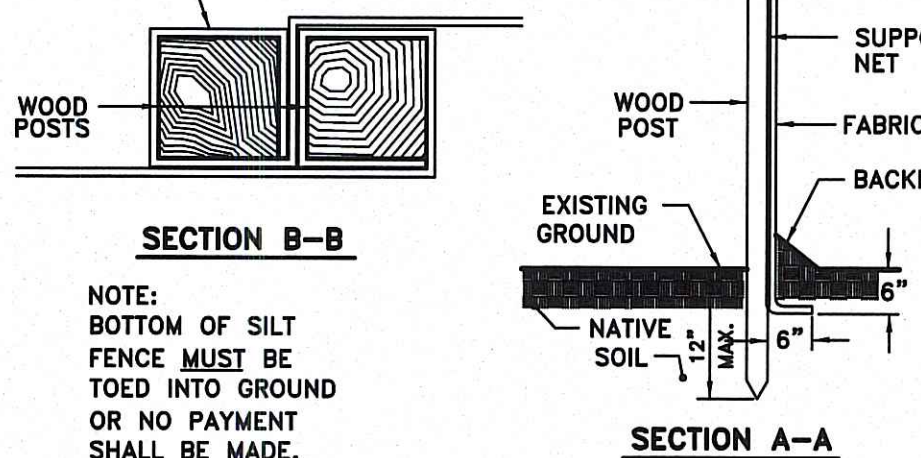
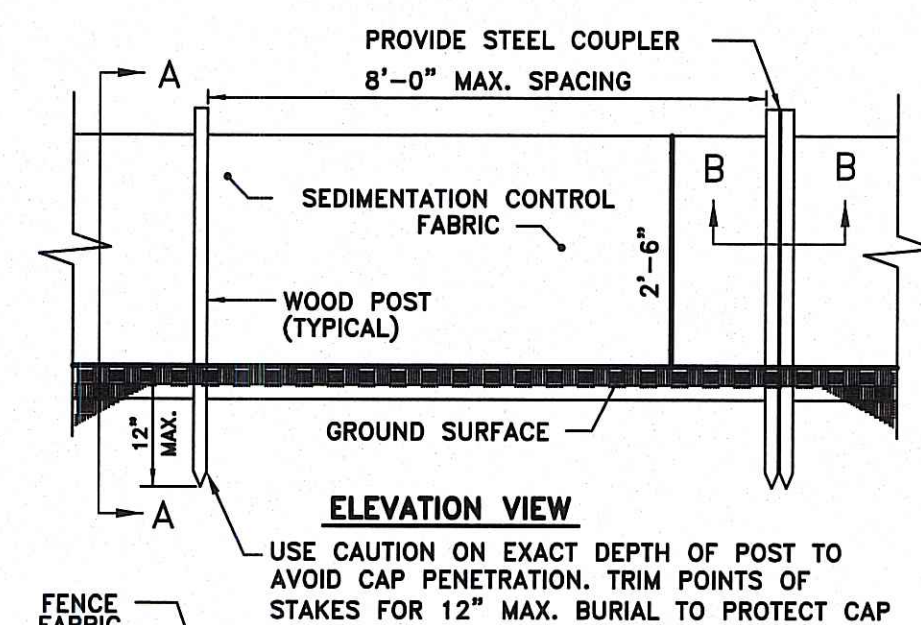
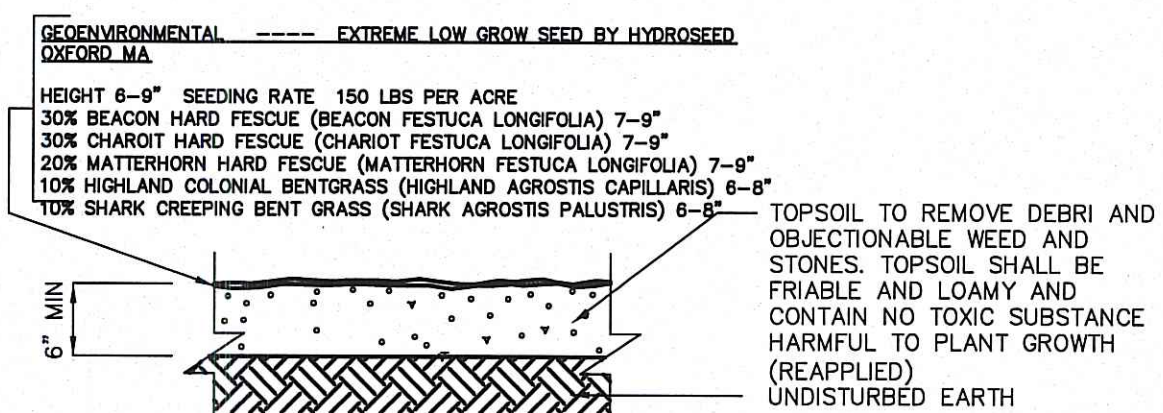
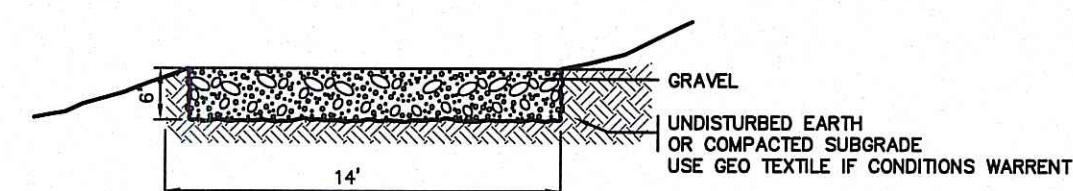
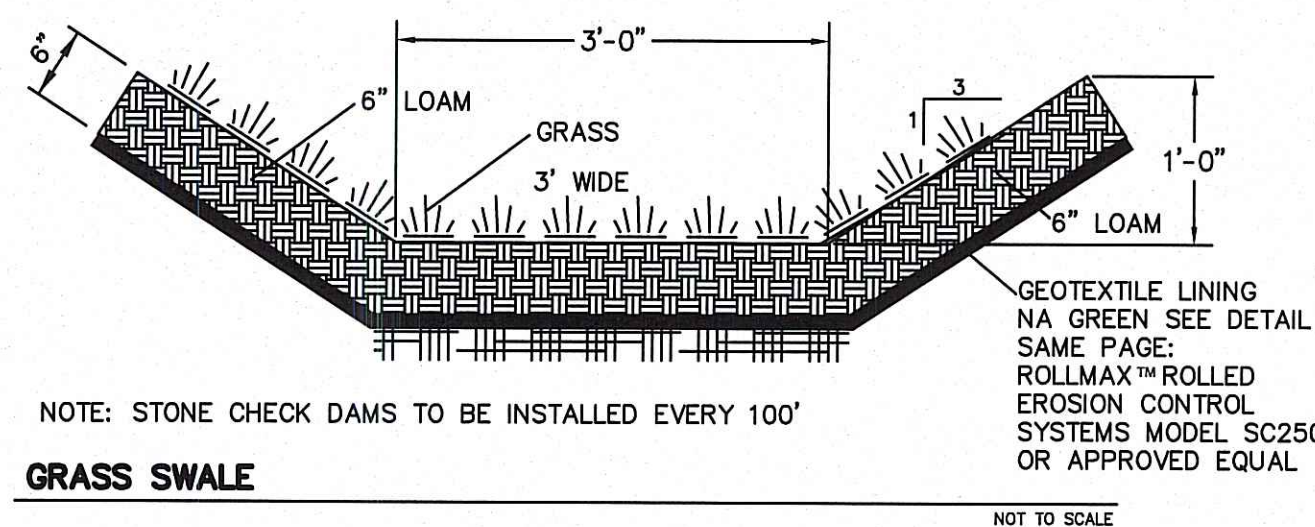

**SILTATION FENCE DETAIL**  
N.T.S.

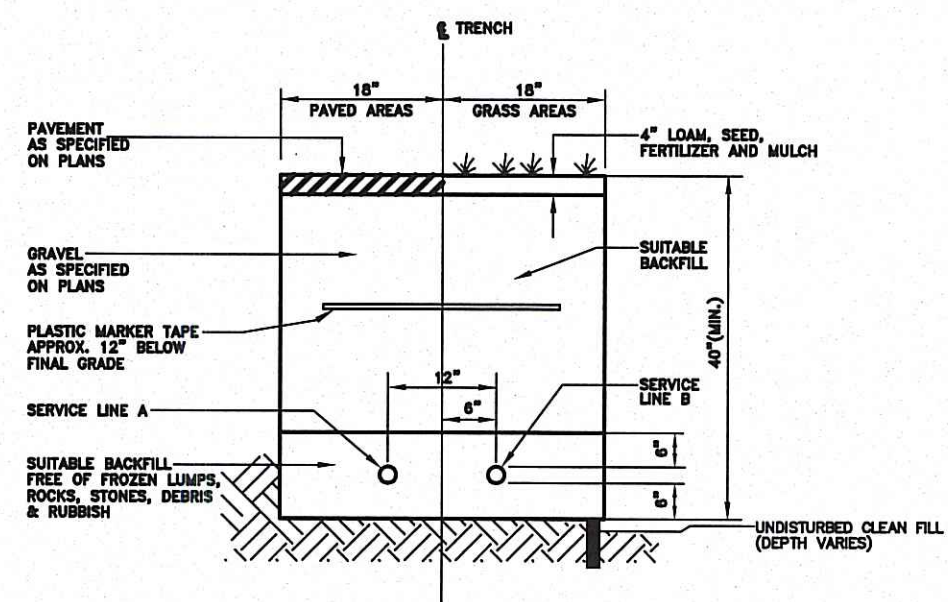

SERVICE	CONDUIT SIZE	CONDUIT TYPE	PAVED AREAS	UTILITY	NOTES
A	4"	RIGID GALVANIZED STEEL, ASTM A120 - SEE NOTE 1	RIGID GALVANIZED STEEL, ASTM A120 - SEE NOTE 1	POWER	PROVIDE PULL WIRE
B	4"	SCHEDULE 40 PVC	RIGID GALVANIZED STEEL, ASTM A120 - SEE NOTE 1	TELEPHONE	PROVIDE PULL WIRE

**UTILITY TRENCH PRIMARY  
ELECTRIC AND TELEPHONE**  
N.T.S.

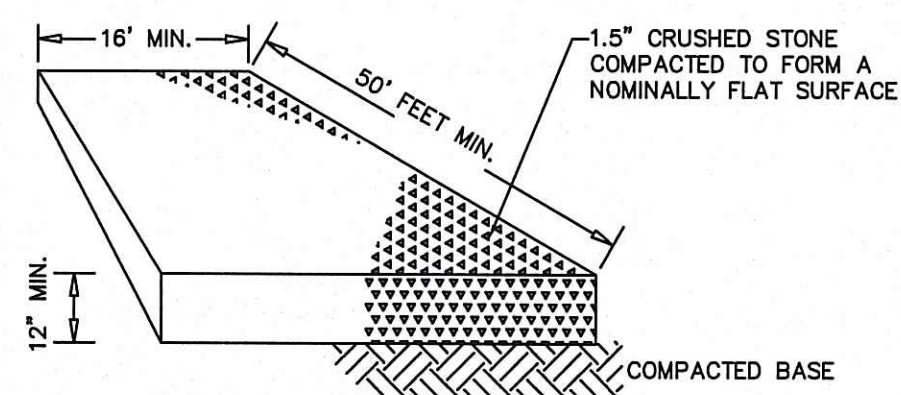

**TRACKING PAD DETAIL**  
NOT TO SCALE

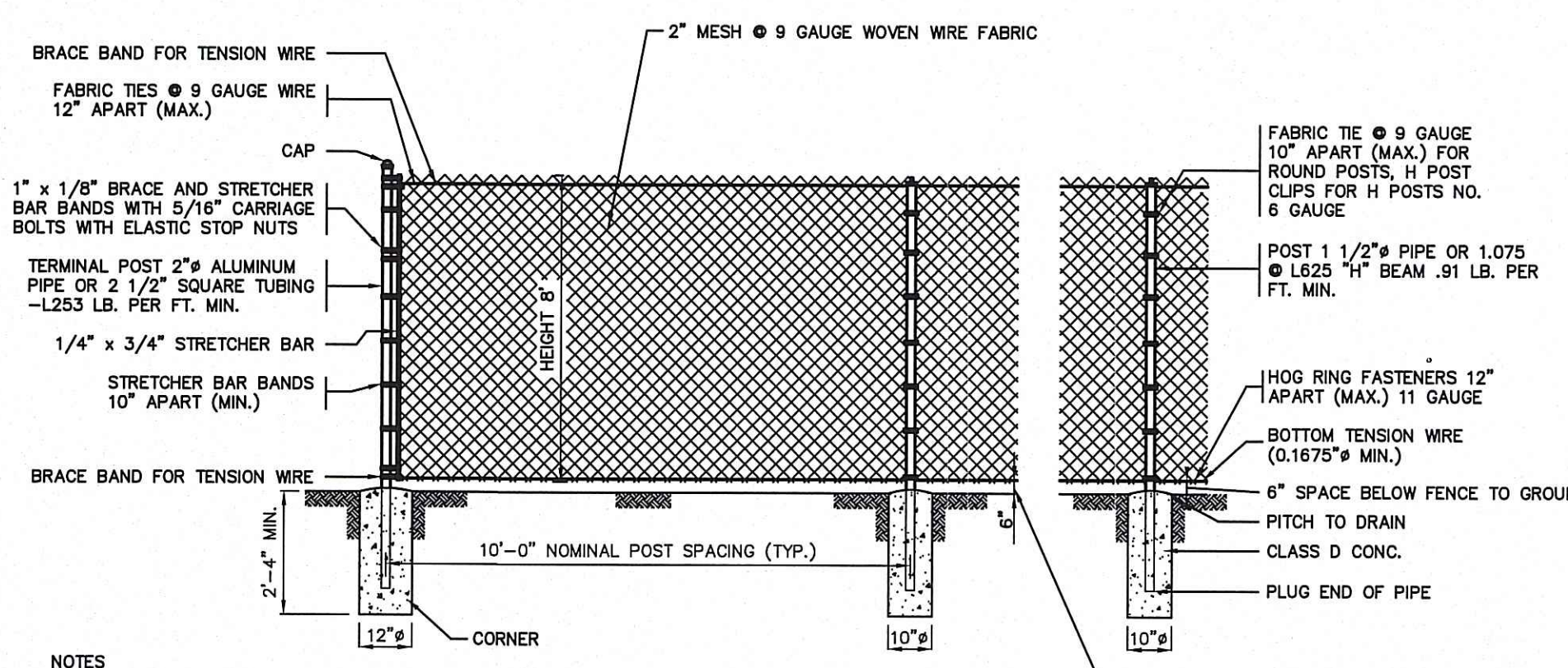

- NOTES
1. ALL ALUMINUM TIES, HOG RINGS AND CLIPS SHALL BE ALLOY 6061-T8
  2. CAP NOT REQUIRED FOR "H" BEAMS
  3. FABRIC SHALL BE ALUMINUM ALLOY, ALL PIPE TO CONFORM TO CURRENT ASTM DESIGNATION B 429, SCHEDULE 40, PLAIN END.
  4. BRACE RAIL AND ROD AT CORNER AND END SECTION ONLY.
  5. ALL REFERENCES TO PIPE DIAMETER ARE ASTM NOMINAL SIZE.
  6. WITH THE APPROVAL OF THE ENGINEER, IN SOFT MARSHY GROUND, POSTS MAY BE DRIVEN, THE CONCRETE FOOTING DELETED AND APPROVED DRIVE ANCHORS USED.

**CHAIN LINK FENCE DETAIL**  
NOT TO SCALE

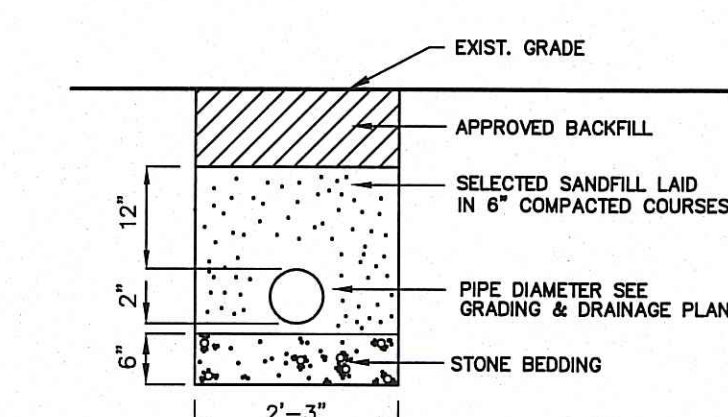

**DRAINAGE PIPE IN TRENCH**  
NOT TO SCALE

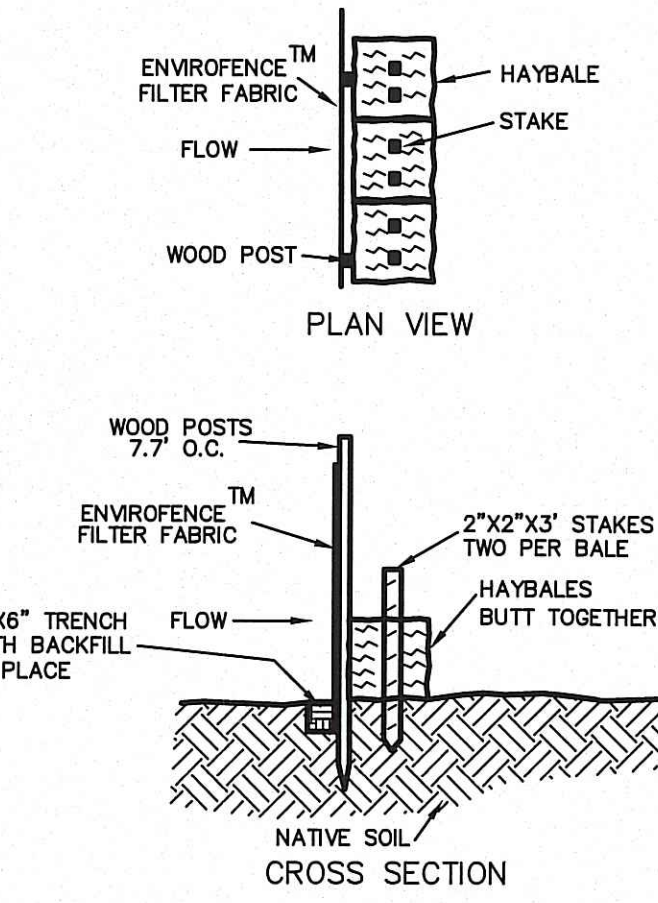

**SEDIMENTATION CONTROL BARRIER**  
(NOT TO SCALE)

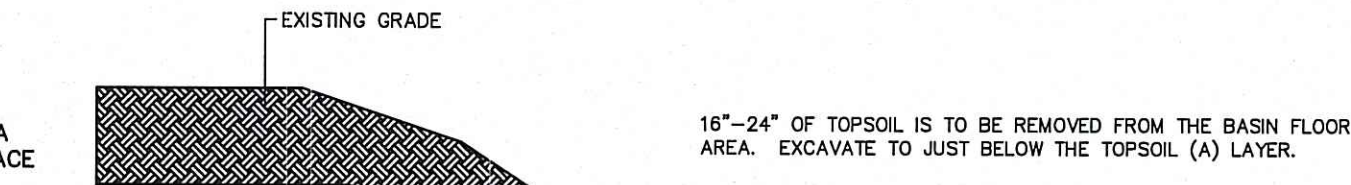

**DETENTION BASIN #1 CROSS SECTION**

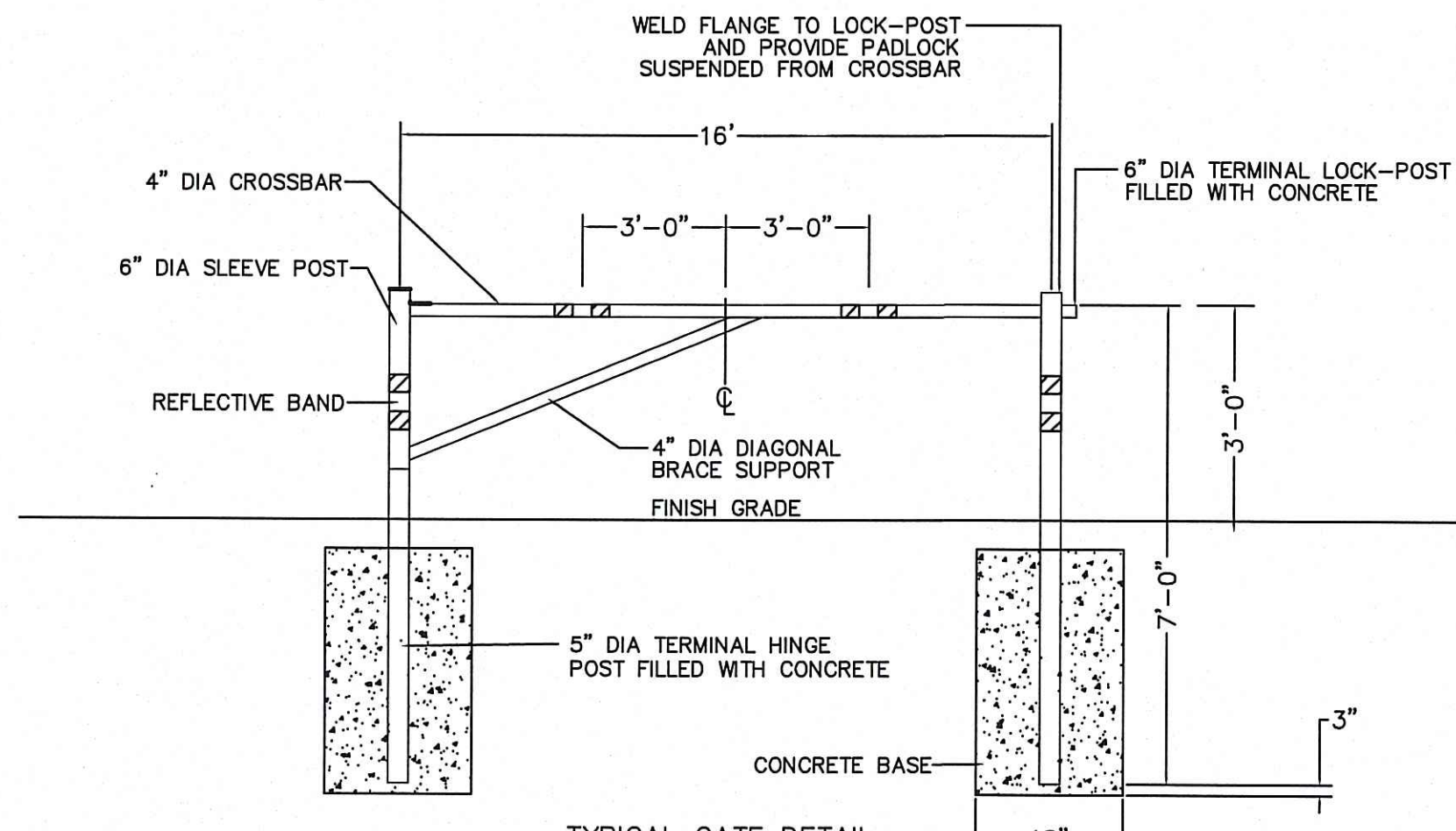

**TYPICAL GATE DETAIL**  
SCALE: NONE

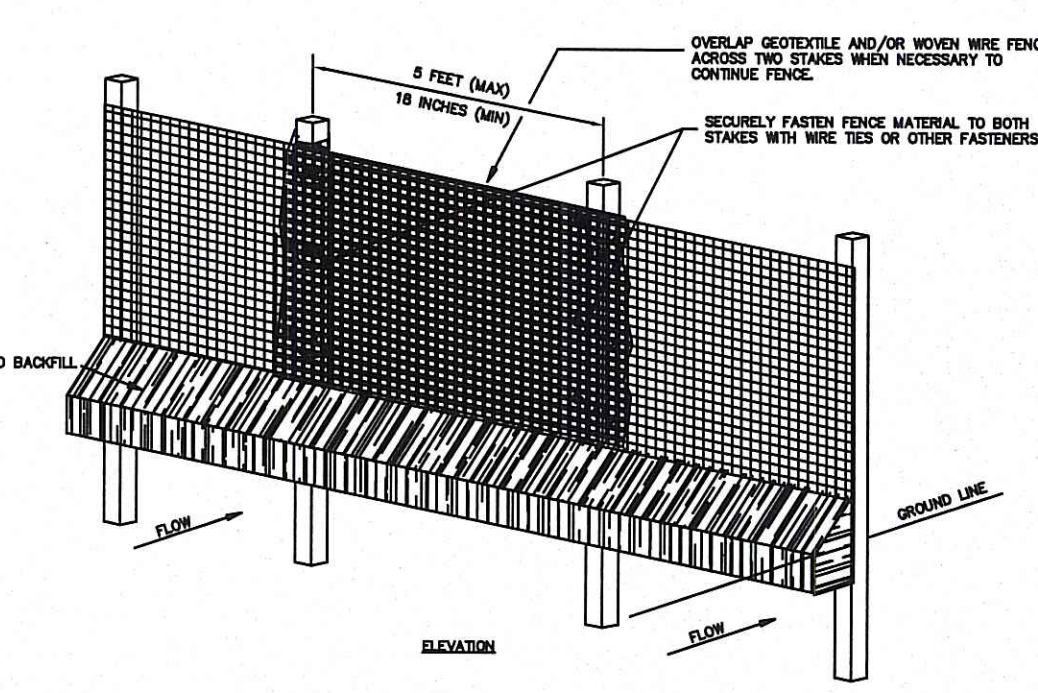
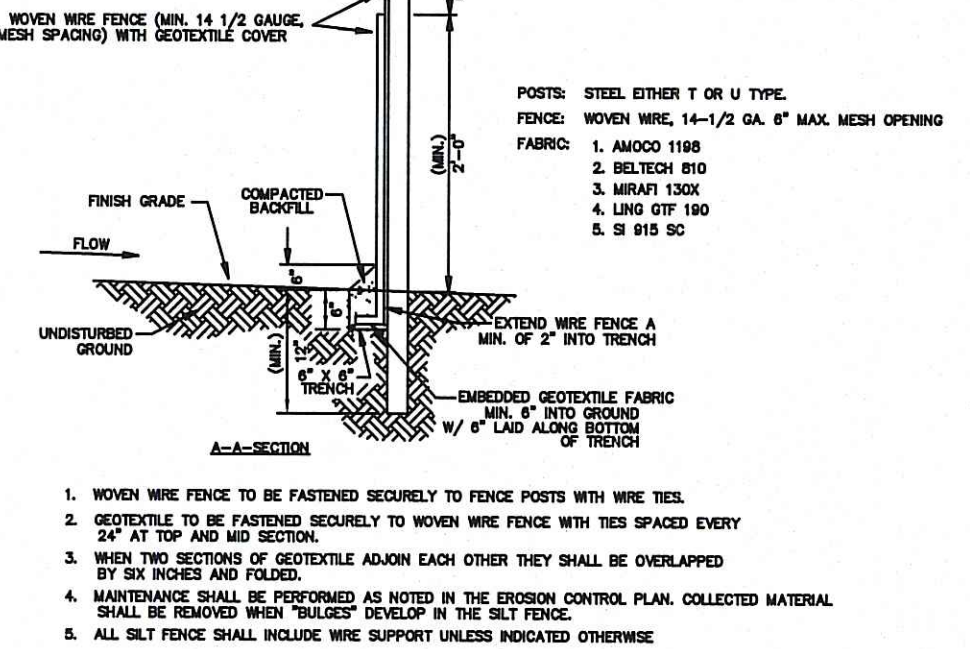
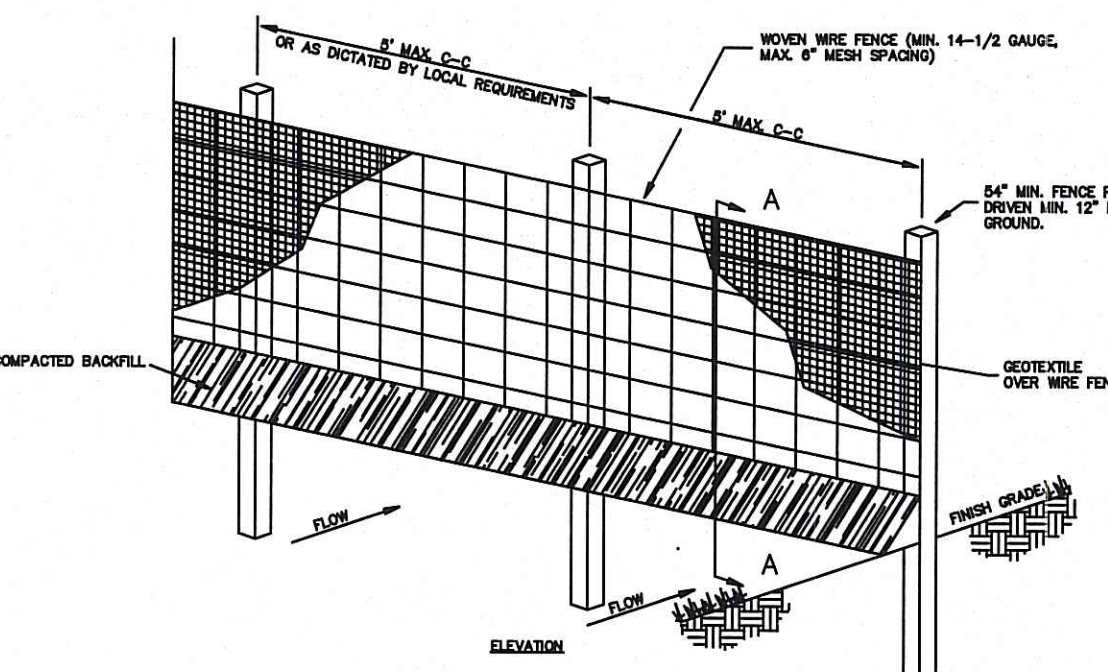

**OVERLAP OF  
SEDIMENTATION/SILT FENCE**  
N.T.S.

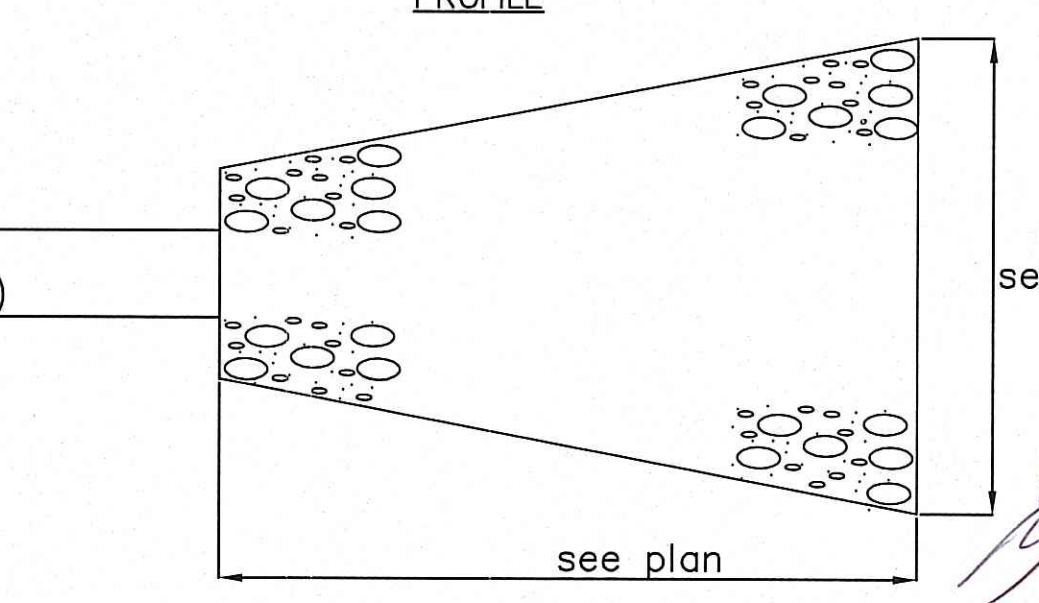
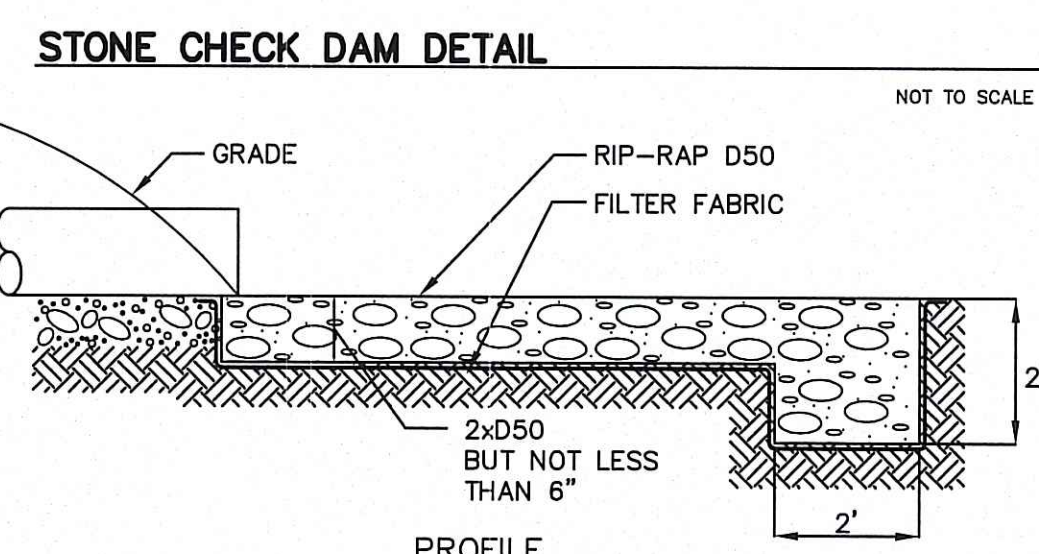

**RIP RAP APRON DETAIL**  
NOT TO SCALE

RESERVED FOR USE BY  
LEICESTER PLANNING BOARD

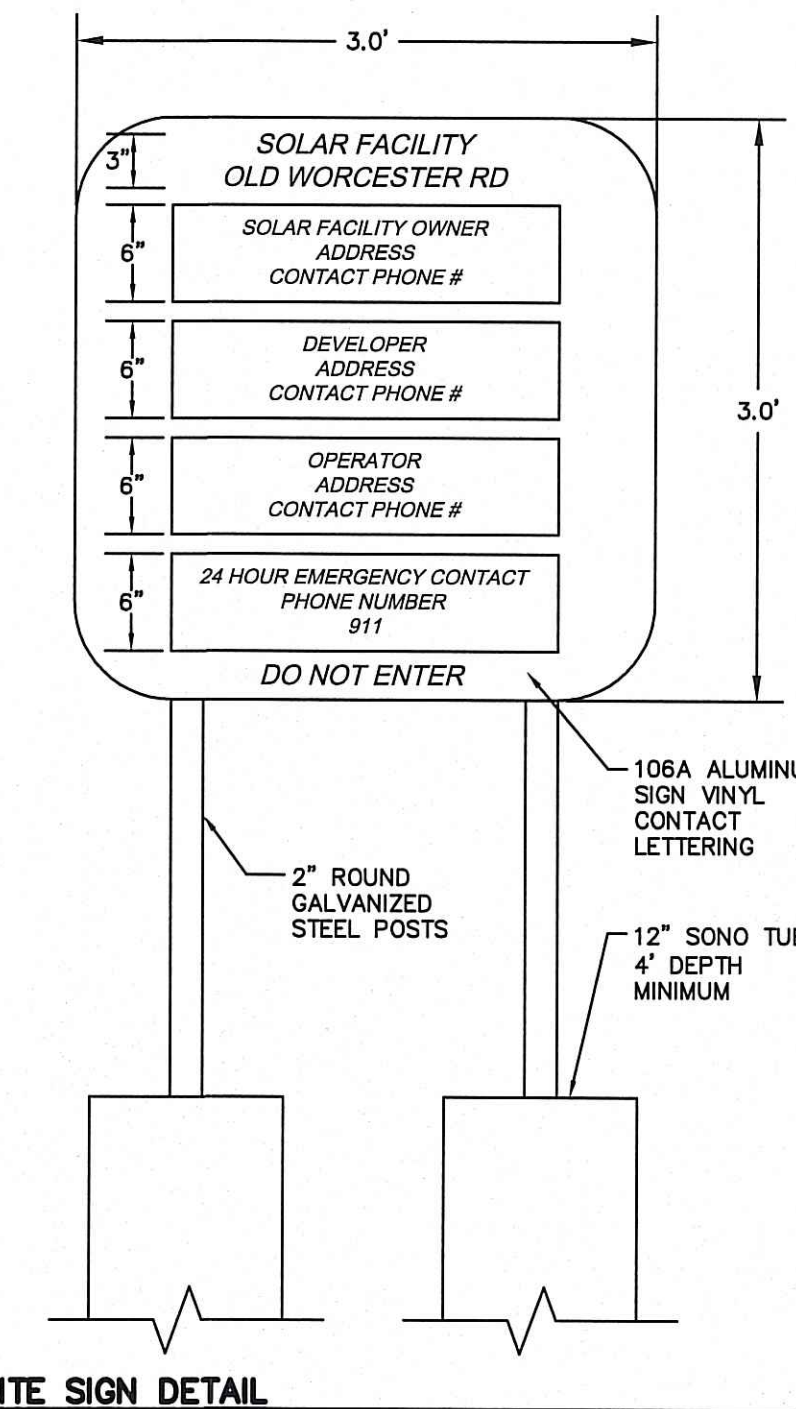

**SITE SIGN DETAIL**  
NOT TO SCALE

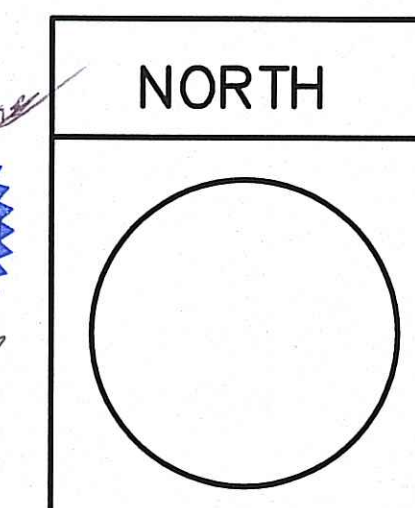

NO.	DATE	REVISION	BY
3	12/13/16	RESUBMISSION DUE TO PERMIT EXPIRATION	PE
2	10/6/15	PER FIRE DEPARTMENT	LLW
1	10/1/15	PER REVIEW ENGINEER AND PLANNING BOARD	LLW

DRAWN BY:	CHECKED BY:
CALLISTO J. BERTIN, P.E. PROFESSIONAL ENGINEER CT. LIC. NO.: 12950 MA. LIC. NO.: 40595 N.H. LIC. NO.: 9368 N.J. LIC. NO.: 28845 N.Y. LIC. NO.: 60022 R.I. LIC. NO.: 6694	FRANK W. BICCHIERI, P.E. PROFESSIONAL ENGINEER MA. LIC. NO.: 47597 BRUCE A. FITZBACK, P.L.S. PROFESSIONAL LAND SURVEYOR MA. LIC. NO.: 37731 CT. LIC. NO.: 16970

CLIENT: SunConnect 3021 Airport Pulling Rd. Suite 201 Naples, FL 34105	DATE: 3.18.15	SCALE: AS NOTED	REV # 3	PROJECT # 15-642	DWG. NO. D-1
<b>DETAILS SHEET</b> SITE ADDRESS: 9 McNeil Highway Leicester, MA 01524	<b>B BERTIN ENGINEERING</b> 39 ELM STREET SOUTHBRIDGE, MA 01550 P 508.785.0195 F 508.785.0193 www.bertinengineering.com				



N/F  
Massachusetts Audubon Society, Inc.  
Db 32359 Pg 52  
Ap: 17-A-1

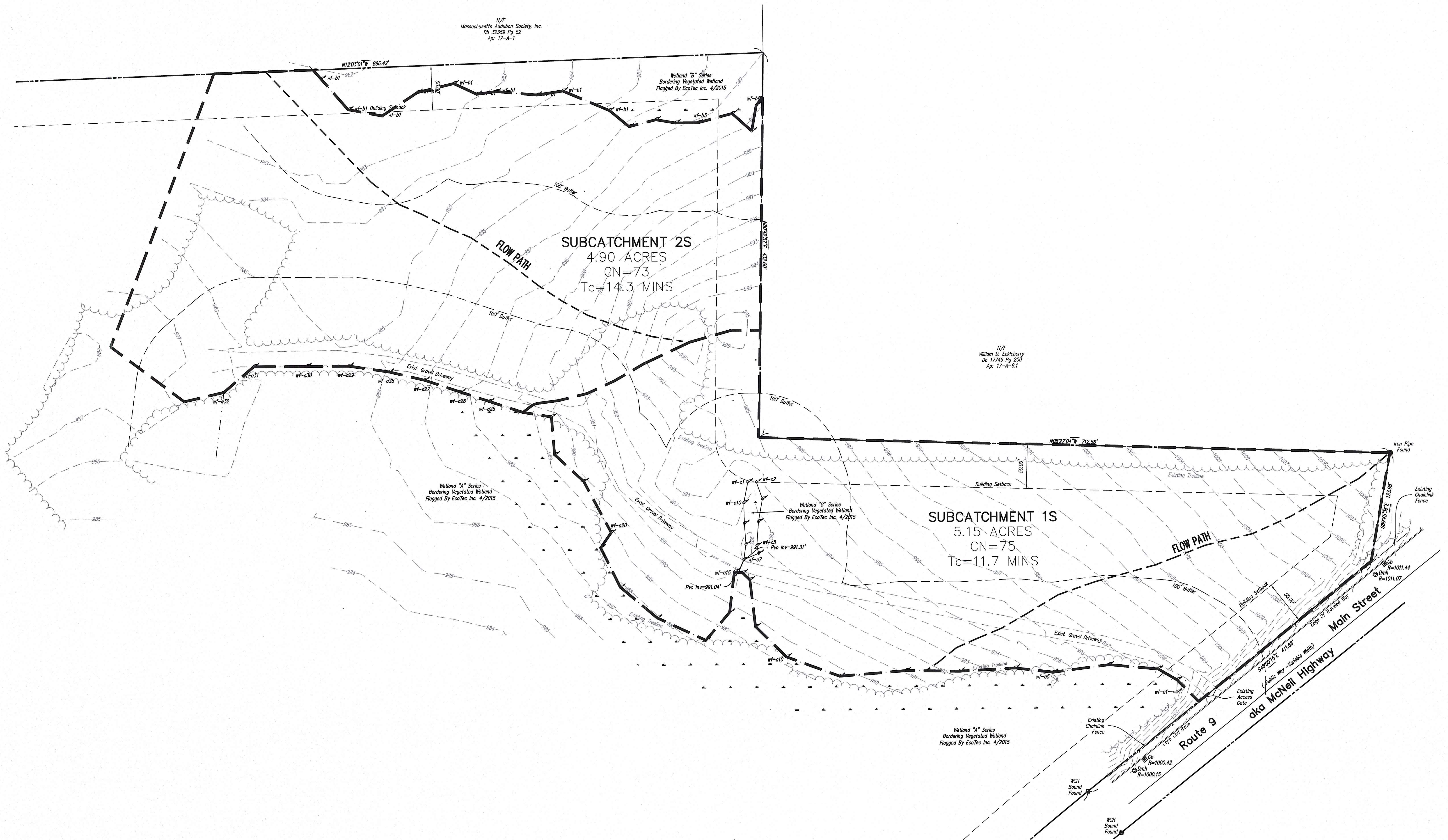

GRAPHIC SCALE

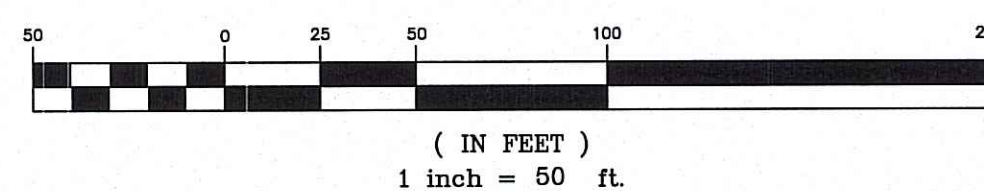

NORTH

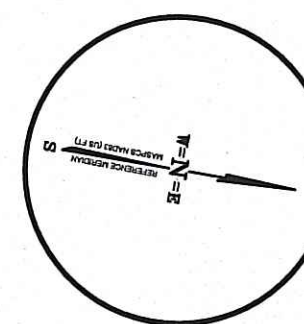

3	12/13/16	RESUBMISSION DUE TO PERMIT EXPIRATION	PE
2	10/6/15	PER FIRE DEPARTMENT	LLW
1	10/1/15	PER REVIEW ENGINEER AND PLANNING BOARD	LLW
NO.	DATE	REVISION	BY

DRAWN BY: PE  
CALISTO J. BERTIN, P.E.  
PROFESSIONAL ENGINEER  
CT. LIC. NO.: 12350  
MA. LIC. NO.: 40895  
N.H. LIC. NO.: 9368  
N.J. LIC. NO.: 28845  
N.Y. LIC. NO.: 60022  
R.I. LIC. NO.: 6694

CHECKED BY: ML  
FRANK W. BICCHIERI, P.E.  
PROFESSIONAL ENGINEER  
MA. LIC. NO.: 47597  
BRUCE A. FITZBACK, P.L.S.  
PROFESSIONAL LAND SURVEYOR  
MA. LIC. NO.: 37731  
CT. LIC. NO.: 16970

CLIENT: SunConnect  
3021 Airport Pulling Rd. Suite 201  
Naples, FL 34105

EXISTING DRAINAGE

SITE ADDRESS:  
9 McNeil Highway  
Leicester, MA 01524

**B BERTIN ENGINEERING**

39 ELM STREET  
SOUTHBRIDGE, MA 01550  
P 508.765.0195  
F 508.765.0193  
www.bertinengineering.com

DATE:	SCALE:	REV #:	PROJECT #:	DWG. NO.:
3.18.15	1"=50'	3	15-642	DA-1



N/F  
Massachusetts Audubon Society, Inc.  
Db. 32359 Pg. 52  
Ap: 17-A-1

SUBCATCHMENT 3S  
1.03 ACRES  
CN=72  
Tc=9.7 MINS

SUBCATCHMENT 2S  
3.88 ACRES  
CN=74  
Tc=15.7 MINS

SUBCATCHMENT 1S  
5.15 ACRES  
CN=75  
Tc=11.7 MINS

N/F  
William D. Eckleberry  
Db. 17749 Pg. 203  
Ap: 17-A-2.1

Wetland "A" Series  
Bordering Vegetated Wetland  
Flagged By EcoTec Inc. 4/2015

Wetland "C" Series  
Bordering Vegetated Wetland  
Flagged By EcoTec Inc. 4/2015

Wetland "A" Series  
Bordering Vegetated Wetland  
Flagged By EcoTec Inc. 4/2015

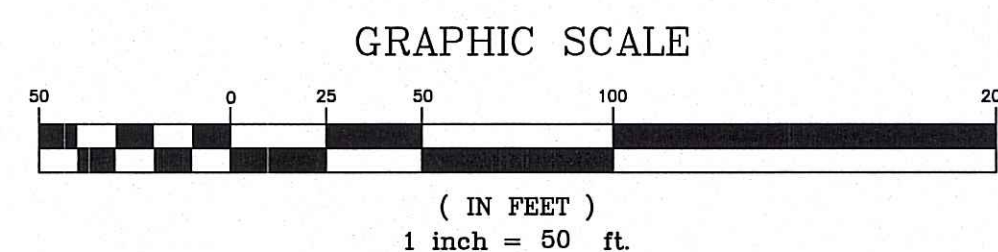

NORTH

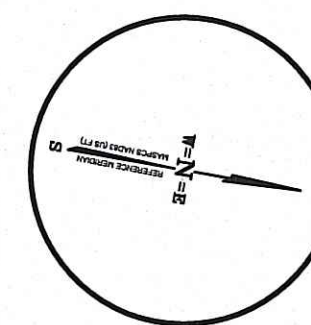

NO.	DATE	REVISION	BY
3	12/13/16	RESUBMISSION DUE TO PERMIT EXPIRATION	PE
2	10/6/15	PER FIRE DEPARTMENT	LLW
1	10/1/15	PER REVIEW ENGINEER AND PLANNINGBOARD	LLW

DRAWN BY: PE  
CALISTO J. BERTIN, P.E.  
PROFESSIONAL ENGINEER  
CT. LIC. NO.: 12950  
MA. LIC. NO.: 40595  
N.J. LIC. NO.: 9368  
N.Y. LIC. NO.: 28845  
R.I. LIC. NO.: 60022

CHECKED BY: ML  
FRANK W. BICCHIERI, P.E.  
PROFESSIONAL ENGINEER  
MA. LIC. NO.: 47597  
BRUCE A. FITZBACK, P.L.S.  
PROFESSIONAL LAND SURVEYOR  
MA. LIC. NO.: 37731  
CT. LIC. NO.: 16970

CLIENT: SunConnect  
3021 Airport Pulling Rd. Suite 201  
Naples, FL 34105

PROPOSED DRAINAGE

SITE ADDRESS:  
9 McNeil Highway  
Leicester, MA 01524

**B BERTIN ENGINEERING**

39 ELM STREET  
SOUTHBRIDGE, MA 01550  
P 508.765.0195  
F 508.765.0193  
www.bertinengineering.com

DATE: 3.18.15 SCALE: 1"=50' REV #: 3 PROJECT #: 15-642 DWG. NO.: DA-2

THIS DRAWING IS THE PROPERTY OF THE CLIENT AND BERTIN ENGINEERING ASSOCIATES INC. AND WAS PREPARED FOR THE EXCLUSIVE USE OF THE CLIENT. REUSE FOR ANY OTHER PURPOSE WITHOUT AUTHORIZATION BY BERTIN ENGINEERING ASSOCIATES INC. IS PROHIBITED. 2017

ORIGINAL  
13 DEC 2016