

Massachusetts Department of Environmental Protection  
Bureau of Resource Protection - Wetlands

# WPA Form 3 – Notice of Intent

Massachusetts Wetlands Protection Act M.G.L. c. 131, §40

Provided by MassDEP

MassDEP File Number

Document Transaction Number

Leicester

City/Town

**Important:**  
When filling out forms on the computer, use only the tab key to move your cursor - do not use the return key.



**Note:**  
Before completing this form consult your local Conservation Commission regarding any municipal bylaw or ordinance.

## A. General Information

1. Project Location (**Note:** electronic filers will click on button to locate project site):

25 Lakeview Drive

a. Street Address

Leicester

b. City/Town

01524

c. Zip Code

Latitude and Longitude:

28B

f. Assessors Map/Plat Number

42.227068

d. Latitude

71.936602

e. Longitude

A20

g. Parcel /Lot Number

2. Applicant:

William & Pamela

a. First Name

Keyes

b. Last Name

c. Organization

8 Sherry Lane

d. Street Address

Spencer

e. City/Town

MA

f. State

01562

g. Zip Code

508.864.9708

h. Phone Number

i. Fax Number

pavebk@charter.net

j. Email Address

3. Property owner (required if different from applicant): ☐ Check if more than one owner

a. First Name

b. Last Name

c. Organization

d. Street Address

e. City/Town

f. State

g. Zip Code

h. Phone Number

i. Fax Number

j. Email address

Town of Leicester  
Development & Inspectional Services

4. Representative (if any):

Jason

a. First Name

Dubois

b. Last Name

DC Engineering & Survey, Inc.

c. Company

32 Cranberry Meadow Road

d. Street Address

Charlton

e. City/Town

MA

f. State

01507

g. Zip Code

508.769.6659

h. Phone Number

i. Fax Number

jdub862001@yahoo.com

j. Email address

5. Total WPA Fee Paid (from NOI Wetland Fee Transmittal Form):

\$220.00

a. Total Fee Paid

\$97.50

b. State Fee Paid

\$122.50

c. City/Town Fee Paid



Massachusetts Department of Environmental Protection  
Bureau of Resource Protection - Wetlands

**WPA Form 3 – Notice of Intent**

Massachusetts Wetlands Protection Act M.G.L. c. 131, §40

Provided by MassDEP

MassDEP File Number

Document Transaction Number

Leicester

City/Town

**A. General Information (continued)**

6. General Project Description:

Demo of portions of an existing house with construction of additions/renovations. Construction of a retaining wall with a patio. Demo of an existing boat house to be converted to a boat ramp. Tree removal. All within the 100-ft buffer zone of Cedar Meadow Lake.

7a. Project Type Checklist: (Limited Project Types see Section A. 7b.)

- |   |   |
|---|---|
| 1. <input checked="" type="checkbox"/> Single Family Home             | 2. <input type="checkbox"/> Residential Subdivision       |
| 3. <input type="checkbox"/> Commercial/Industrial                     | 4. <input type="checkbox"/> Dock/Pier                     |
| 5. <input type="checkbox"/> Utilities                                 | 6. <input type="checkbox"/> Coastal engineering Structure |
| 7. <input type="checkbox"/> Agriculture (e.g., cranberries, forestry) | 8. <input type="checkbox"/> Transportation                |
| 9. <input type="checkbox"/> Other                                     |   |

7b. Is any portion of the proposed activity eligible to be treated as a limited project (including Ecological Restoration Limited Project) subject to 310 CMR 10.24 (coastal) or 310 CMR 10.53 (inland)?

1. ☐ Yes ☒ No If yes, describe which limited project applies to this project. (See 310 CMR 10.24 and 10.53 for a complete list and description of limited project types)

2. Limited Project Type

If the proposed activity is eligible to be treated as an Ecological Restoration Limited Project (310 CMR 10.24(8), 310 CMR 10.53(4)), complete and attach Appendix A: Ecological Restoration Limited Project Checklist and Signed Certification.

8. Property recorded at the Registry of Deeds for:

Worcester

a. County

51460

c. Book

b. Certificate # (if registered land)

372

d. Page Number

**B. Buffer Zone & Resource Area Impacts (temporary & permanent)**

1. ☒ Buffer Zone Only – Check if the project is located only in the Buffer Zone of a Bordering Vegetated Wetland, Inland Bank, or Coastal Resource Area.
2. ☐ Inland Resource Areas (see 310 CMR 10.54-10.58; if not applicable, go to Section B.3, Coastal Resource Areas).

Check all that apply below. Attach narrative and any supporting documentation describing how the project will meet all performance standards for each of the resource areas altered, including standards requiring consideration of alternative project design or location.



Massachusetts Department of Environmental Protection  
Bureau of Resource Protection - Wetlands

**WPA Form 3 – Notice of Intent**

Massachusetts Wetlands Protection Act M.G.L. c. 131, §40

Provided by MassDEP

MassDEP File Number

Document Transaction Number

Leicester

City/Town

**B. Buffer Zone & Resource Area Impacts (temporary & permanent) (cont'd)**

For all projects affecting other Resource Areas, please attach a narrative explaining how the resource area was delineated.

Resource Area	Size of Proposed Alteration	Proposed Replacement (if any)
a. <input type="checkbox"/> Bank	1. linear feet	2. linear feet
b. <input type="checkbox"/> Bordering Vegetated Wetland	1. square feet	2. square feet
c. <input type="checkbox"/> Land Under Waterbodies and Waterways	1. square feet 3. cubic yards dredged	2. square feet

Resource Area	Size of Proposed Alteration	Proposed Replacement (if any)
d. <input type="checkbox"/> Bordering Land Subject to Flooding	1. square feet 3. cubic feet of flood storage lost	2. square feet 4. cubic feet replaced
e. <input type="checkbox"/> Isolated Land Subject to Flooding	1. square feet 2. cubic feet of flood storage lost	3. cubic feet replaced

f. ☐ Riverfront Area

1. Name of Waterway (if available) - specify coastal or inland

2. Width of Riverfront Area (check one):

☐ 25 ft. - Designated Densely Developed Areas only

☐ 100 ft. - New agricultural projects only

☐ 200 ft. - All other projects

3. Total area of Riverfront Area on the site of the proposed project: \_\_\_\_\_ square feet

4. Proposed alteration of the Riverfront Area:

a. total square feet \_\_\_\_\_ b. square feet within 100 ft. \_\_\_\_\_ c. square feet between 100 ft. and 200 ft. \_\_\_\_\_

5. Has an alternatives analysis been done and is it attached to this NOI? ☐ Yes ☐ No

6. Was the lot where the activity is proposed created prior to August 1, 1996? ☐ Yes ☐ No

3. ☐ Coastal Resource Areas: (See 310 CMR 10.25-10.35)

**Note:** for coastal riverfront areas, please complete **Section B.2.f.** above.

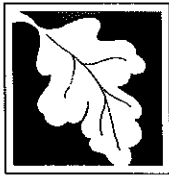

Massachusetts Department of Environmental Protection  
Bureau of Resource Protection - Wetlands

**WPA Form 3 – Notice of Intent**

Massachusetts Wetlands Protection Act M.G.L. c. 131, §40

Provided by MassDEP:

MassDEP File Number

Document Transaction Number

Leicester

City/Town

**B. Buffer Zone & Resource Area Impacts (temporary & permanent) (cont'd)**

Check all that apply below. Attach narrative and supporting documentation describing how the project will meet all performance standards for each of the resource areas altered, including standards requiring consideration of alternative project design or location.

Online Users:  
Include your document transaction number (provided on your receipt page) with all supplementary information you submit to the Department.

<u>Resource Area</u>	<u>Size of Proposed Alteration</u>	<u>Proposed Replacement (if any)</u>
a. <input type="checkbox"/> Designated Port Areas	Indicate size under Land Under the Ocean, below	
b. <input type="checkbox"/> Land Under the Ocean	1. square feet	
	2. cubic yards dredged	
c. <input type="checkbox"/> Barrier Beach	Indicate size under Coastal Beaches and/or Coastal Dunes below	
d. <input type="checkbox"/> Coastal Beaches	1. square feet	2. cubic yards beach nourishment
e. <input type="checkbox"/> Coastal Dunes	1. square feet	2. cubic yards dune nourishment
	<u>Size of Proposed Alteration</u>	<u>Proposed Replacement (if any)</u>
f. <input type="checkbox"/> Coastal Banks	1. linear feet	
g. <input type="checkbox"/> Rocky Intertidal Shores	1. square feet	
h. <input type="checkbox"/> Salt Marshes	1. square feet	2. sq ft restoration, rehab., creation
i. <input type="checkbox"/> Land Under Salt Ponds	1. square feet	
	2. cubic yards dredged	
j. <input type="checkbox"/> Land Containing Shellfish	1. square feet	
k. <input type="checkbox"/> Fish Runs	Indicate size under Coastal Banks, inland Bank, Land Under the Ocean, and/or inland Land Under Waterbodies and Waterways, above	
	1. cubic yards dredged	
l. <input type="checkbox"/> Land Subject to Coastal Storm Flowage	1. square feet	
4. <input type="checkbox"/> Restoration/Enhancement	If the project is for the purpose of restoring or enhancing a wetland resource area in addition to the square footage that has been entered in Section B.2.b or B.3.h above, please enter the additional amount here.	
	a. square feet of BVW	b. square feet of Salt Marsh
5. <input type="checkbox"/> Project Involves Stream Crossings		
	a. number of new stream crossings	b. number of replacement stream crossings



Massachusetts Department of Environmental Protection  
Bureau of Resource Protection - Wetlands

**WPA Form 3 – Notice of Intent**

Massachusetts Wetlands Protection Act M.G.L. c. 131, §40

Provided by MassDEP:

MassDEP File Number

Document Transaction Number

Leicester

City/Town

**C. Other Applicable Standards and Requirements**

- ☐ This is a proposal for an Ecological Restoration Limited Project. Skip Section C and complete Appendix A: Ecological Restoration Limited Project Checklists – Required Actions (310 CMR 10.11).

**Streamlined Massachusetts Endangered Species Act/Wetlands Protection Act Review**

1. Is any portion of the proposed project located in **Estimated Habitat of Rare Wildlife** as indicated on the most recent Estimated Habitat Map of State-Listed Rare Wetland Wildlife published by the Natural Heritage and Endangered Species Program (NHESP)? To view habitat maps, see the *Massachusetts Natural Heritage Atlas* or go to [http://maps.massgis.state.ma.us/PRI\\_EST\\_HAB/viewer.htm](http://maps.massgis.state.ma.us/PRI_EST_HAB/viewer.htm).

a. ☐ Yes ☒ No

If yes, include proof of mailing or hand delivery of NOI to:

Natural Heritage and Endangered Species Program  
Division of Fisheries and Wildlife  
1 Rabbit Hill Road  
Westborough, MA 01581

2008

b. Date of map

If yes, the project is also subject to Massachusetts Endangered Species Act (MESA) review (321 CMR 10.18). To qualify for a streamlined, 30-day, MESA/Wetlands Protection Act review, please complete Section C.1.c, and include requested materials with this Notice of Intent (NOI); OR complete Section C.2.f, if applicable. *If MESA supplemental information is not included with the NOI, by completing Section 1 of this form, the NHESP will require a separate MESA filing which may take up to 90 days to review (unless noted exceptions in Section 2 apply, see below).*

- c. Submit Supplemental Information for Endangered Species Review\*

1. ☐ Percentage/acreage of property to be altered:

(a) within wetland Resource Area

percentage/acreage

(b) outside Resource Area

percentage/acreage

2. ☐ Assessor's Map or right-of-way plan of site

2. ☐ Project plans for entire project site, including wetland resource areas and areas outside of wetlands jurisdiction, showing existing and proposed conditions, existing and proposed tree/vegetation clearing line, and clearly demarcated limits of work \*\*

(a) ☐ Project description (including description of impacts outside of wetland resource area & buffer zone)

(b) ☐ Photographs representative of the site

\* Some projects **not** in Estimated Habitat may be located in Priority Habitat, and require NHESP review (see <http://www.mass.gov/eea/agencies/dfg/dfw/natural-heritage/regulatory-review/>). Priority Habitat includes habitat for state-listed plants and strictly upland species not protected by the Wetlands Protection Act.

\*\* MESA projects may not be segmented (321 CMR 10.16). The applicant must disclose full development plans even if such plans are not required as part of the Notice of Intent process.

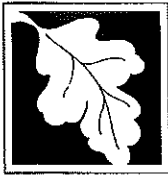

Massachusetts Department of Environmental Protection  
Bureau of Resource Protection - Wetlands

**WPA Form 3 – Notice of Intent**

Massachusetts Wetlands Protection Act M.G.L. c. 131, §40

Provided by MassDEP

MassDEP File Number

Document Transaction Number

Leicester

City/Town

**C. Other Applicable Standards and Requirements (cont'd)**

- (c) ☐ MESA filing fee (fee information available at [http://www.mass.gov/dfwele/dfw/nhosp/regulatory\\_review/mesa/mesa\\_fee\\_schedule.htm](http://www.mass.gov/dfwele/dfw/nhosp/regulatory_review/mesa/mesa_fee_schedule.htm)). Make check payable to "Commonwealth of Massachusetts - NHESP" and **mail to NHESP** at above address

*Projects altering 10 or more acres of land, also submit:*

- (d) ☐ Vegetation cover type map of site
- (e) ☐ Project plans showing Priority & Estimated Habitat boundaries
- (f) OR Check One of the Following
1. ☐ Project is exempt from MESA review.  
Attach applicant letter indicating which MESA exemption applies. (See 321 CMR 10.14, [http://www.mass.gov/dfwele/dfw/nhosp/regulatory\\_review/mesa/mesa\\_exemptions.htm](http://www.mass.gov/dfwele/dfw/nhosp/regulatory_review/mesa/mesa_exemptions.htm); the NOI must still be sent to NHESP if the project is within estimated habitat pursuant to 310 CMR 10.37 and 10.59.)
2. ☐ Separate MESA review ongoing. a. NHESP Tracking # \_\_\_\_\_ b. Date submitted to NHESP \_\_\_\_\_
3. ☐ Separate MESA review completed.  
Include copy of NHESP "no Take" determination or valid Conservation & Management Permit with approved plan.
3. For coastal projects only, is any portion of the proposed project located below the mean high water line or in a fish run?
- a. ☐ Not applicable – project is in inland resource area only      b. ☐ Yes    ☐ No

If yes, include proof of mailing, hand delivery, or electronic delivery of NOI to either:

South Shore - Cohasset to Rhode Island border, and the Cape & Islands:

Division of Marine Fisheries -  
Southeast Marine Fisheries Station  
Attn: Environmental Reviewer  
1213 Purchase Street – 3rd Floor  
New Bedford, MA 02740-6694  
Email: [DMF.EnvReview-South@state.ma.us](mailto:DMF.EnvReview-South@state.ma.us)

North Shore - Hull to New Hampshire border:

Division of Marine Fisheries -  
North Shore Office  
Attn: Environmental Reviewer  
30 Emerson Avenue  
Gloucester, MA 01930  
Email: [DMF.EnvReview-North@state.ma.us](mailto:DMF.EnvReview-North@state.ma.us)

Also if yes, the project may require a Chapter 91 license. For coastal towns in the Northeast Region, please contact MassDEP's Boston Office. For coastal towns in the Southeast Region, please contact MassDEP's Southeast Regional Office.

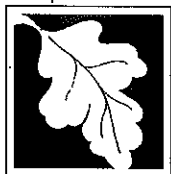

Massachusetts Department of Environmental Protection  
Bureau of Resource Protection - Wetlands

## WPA Form 3 – Notice of Intent

Massachusetts Wetlands Protection Act M.G.L. c. 131, §40

Provided by MassDEP

MassDEP File Number

Document Transaction Number

Leicester

City/Town

### C. Other Applicable Standards and Requirements (cont'd)

**Online Users:**  
Include your document transaction number (provided on your receipt page) with all supplementary information you submit to the Department.

4. Is any portion of the proposed project within an Area of Critical Environmental Concern (ACEC)?
- a. ☐ Yes ☒ No If yes, provide name of ACEC (see instructions to WPA Form 3 or MassDEP Website for ACEC locations). **Note:** electronic filers click on Website.
- b. ACEC
5. Is any portion of the proposed project within an area designated as an Outstanding Resource Water (ORW) as designated in the Massachusetts Surface Water Quality Standards, 314 CMR 4.00?
- a. ☐ Yes ☒ No
6. Is any portion of the site subject to a Wetlands Restriction Order under the Inland Wetlands Restriction Act (M.G.L. c. 131, § 40A) or the Coastal Wetlands Restriction Act (M.G.L. c. 130, § 105)?
- a. ☐ Yes ☒ No
7. Is this project subject to provisions of the MassDEP Stormwater Management Standards?
- a. ☐ Yes. Attach a copy of the Stormwater Report as required by the Stormwater Management Standards per 310 CMR 10.05(6)(k)-(q) and check if:
1. ☐ Applying for Low Impact Development (LID) site design credits (as described in Stormwater Management Handbook Vol. 2, Chapter 3)
  2. ☐ A portion of the site constitutes redevelopment
  3. ☐ Proprietary BMPs are included in the Stormwater Management System.
- b. ☒ No. Check why the project is exempt:
1. ☐ Single-family house
  2. ☐ Emergency road repair
  3. ☐ Small Residential Subdivision (less than or equal to 4 single-family houses or less than or equal to 4 units in multi-family housing project) with no discharge to Critical Areas.

### D. Additional Information

- ☐ This is a proposal for an Ecological Restoration Limited Project. Skip Section D and complete Appendix A: Ecological Restoration Notice of Intent – Minimum Required Documents (310 CMR 10.12).

Applicants must include the following with this Notice of Intent (NOI). See instructions for details.

**Online Users:** Attach the document transaction number (provided on your receipt page) for any of the following information you submit to the Department.

1. ☐ USGS or other map of the area (along with a narrative description, if necessary) containing sufficient information for the Conservation Commission and the Department to locate the site. (Electronic filers may omit this item.)
2. ☐ Plans identifying the location of proposed activities (including activities proposed to serve as a Bordering Vegetated Wetland [BVW] replication area or other mitigating measure) relative to the boundaries of each affected resource area.

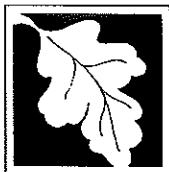

Massachusetts Department of Environmental Protection  
Bureau of Resource Protection - Wetlands

**WPA Form 3 – Notice of Intent**

Massachusetts Wetlands Protection Act M.G.L. c. 131, §40

Provided by MassDEP:

MassDEP File Number

Document Transaction Number

Leicester

City/Town

**D. Additional Information (cont'd)**

3. ☒ Identify the method for BVW and other resource area boundary delineations (MassDEP BVW Field Data Form(s), Determination of Applicability, Order of Resource Area Delineation, etc.), and attach documentation of the methodology.

4. ☒ List the titles and dates for all plans and other materials submitted with this NOI.

Existing/Proposed Site Plan

a. Plan Title

DC Engineering & Survey, Inc.

Jason Dubois

b. Prepared By

c. Signed and Stamped by

TBD

1"=20'

d. Final Revision Date

e. Scale

f. Additional Plan or Document Title

g. Date

5. ☐ If there is more than one property owner, please attach a list of these property owners not listed on this form.
6. ☐ Attach proof of mailing for Natural Heritage and Endangered Species Program, if needed.
7. ☐ Attach proof of mailing for Massachusetts Division of Marine Fisheries, if needed.
8. ☒ Attach NOI Wetland Fee Transmittal Form
9. ☐ Attach Stormwater Report, if needed.

**E. Fees**

1. ☐ Fee Exempt: No filing fee shall be assessed for projects of any city, town, county, or district of the Commonwealth, federally recognized Indian tribe housing authority, municipal housing authority, or the Massachusetts Bay Transportation Authority.

Applicants must submit the following information (in addition to pages 1 and 2 of the NOI Wetland Fee Transmittal Form) to confirm fee payment:

9293

2. Municipal Check Number

12-28-2016

3. Check date

9295

4. State Check Number

12-28-2016

5. Check date

William

Keyes

6. Payor name on check: First Name

7. Payor name on check: Last Name





Massachusetts Department of Environmental Protection  
Bureau of Resource Protection - Wetlands

## WPA Form 3 – Notice of Intent

Massachusetts Wetlands Protection Act M.G.L. c. 131, §40

Provided by MassDEP

MassDEP File Number

Document Transaction Number

Leicester

City/Town

### F. Signatures and Submittal Requirements

I hereby certify under the penalties of perjury that the foregoing Notice of Intent and accompanying plans, documents, and supporting data are true and complete to the best of my knowledge. I understand that the Conservation Commission will place notification of this Notice in a local newspaper at the expense of the applicant in accordance with the wetlands regulations, 310 CMR 10.05(5)(a).

I further certify under penalties of perjury that all abutters were notified of this application, pursuant to the requirements of M.G.L. c. 131, § 40. Notice must be made by Certificate of Mailing or in writing by hand delivery or certified mail (return receipt requested) to all abutters within 100 feet of the property line of the project location.

1. Signature of Applicant

2. Date

3. Signature of Property Owner (if different)

4. Date

5. Signature of Representative (if any)

6. Date

#### For Conservation Commission:

Two copies of the completed Notice of Intent (Form 3), including supporting plans and documents, two copies of the NOI Wetland Fee Transmittal Form, and the city/town fee payment, to the Conservation Commission by certified mail or hand delivery.

#### For MassDEP:

One copy of the completed Notice of Intent (Form 3), including supporting plans and documents, one copy of the NOI Wetland Fee Transmittal Form, and a **copy** of the state fee payment to the MassDEP Regional Office (see Instructions) by certified mail or hand delivery.

#### Other:

If the applicant has checked the "yes" box in any part of Section C, Item 3, above, refer to that section and the Instructions for additional submittal requirements.

The original and copies must be sent simultaneously. Failure by the applicant to send copies in a timely manner may result in dismissal of the Notice of Intent.

## Abutters List

ParcelID	Location	Owner	Co-Owner	Mailing Address	City	State	Zip
28 A12 0	CHARLES ST	CEDAR MEADOW LAKE	WATERSHED DISTRICT	PO BOX 320	LEICESTER	MA	01524
28B A15 0	37 LAKE VIEW DR	FRISINGER THOMAS E	FRISINGER MARTA	37 LAKEVIEW DRIVE	LEICESTER	MA	01524
28B A16 0	35 LAKE VIEW DR	CAVANAUGH JOHN W	CAVANAUGH CAROL A	41 OLDE COLONY DRIVE	SHREWSBURY	MA	01545
28B A17 0	33 LAKE VIEW DR	LAWTON GEORGE R JR		19 MAYFLOWER CIR	LEICESTER	MA	01524
28B A18 0	31 LAKE VIEW DR	LAWTON GARY R		15 WAYCROSS ST	WORCESTER	MA	01605
28B A19 0	29 LAKE VIEW DR	WATERMAN BRIAN P		29 LAKE VIEW DR	LEICESTER	MA	01524
28B A21 0	21 LAKE VIEW DR	FORSBERG THOMAS A		66 HILL STREET	AUBURN	MA	01501
28B A22 0	17 LAKE VIEW DR	ROSE MICHAEL P	ROSE ERICA L	17 LAKE VIEW DR	LEICESTER	MA	01524
28B A23 0	13 LAKE VIEW DR	COMMUNITY BEACH + PARK		LAKEVIEW DR	LEICESTER	MA	01524
28B A24 0	11 LAKE VIEW DR	CARPENTER GEORGE V	CARPENTER LISA M	127 CHARLES ST	LEICESTER	MA	01524
28B F1 0	LAKE VIEW DR	LAWTON GARY R		15 WAYCROSS ST	WORCESTER	MA	01605
28B G1 0	24 LAKE VIEW DR	KEYES WILLIAM JR	KEYES PAMELA	8 SHERRY LN	SPENCER	MA	01562
28B G2 0	5 HEMLOCK LN	PRINCE AMY M		5 HEMLOCK LANE	LEICESTER	MA	01524
28B G8 0	BIRCH LN	POWERS DEBRA ESTATE OF	C/O CASALE SANDRA	27 ROBINSON RD	LITTLETON	MA	01460
28B G9 0	20 LAKE VIEW DR	POWERS DEBRA ESTATE OF	C/O CASALE SANDRA	27 ROBINSON RD	LITTLETON	MA	01460
28B H1 0	18 LAKE VIEW DR	CARIDO LISA J		18 LAKE VIEW DR	LEICESTER	MA	01524

*End of Report*

Above is a certified list of abutters and abutters to abutters within 300 feet of subject.  
 Subject property: 25 Lakeview Drive, Assessors Map 28B-A20-0, Deed Ref. 51460/372  
 Subject owner(s): William & Pamela Keyes

John Prescott, Principal Assessor

Prepared by: Kathleen Asquith, Assistant

## NOTIFICATION TO ABUTTERS UNDER THE MASSACHUSETTS WETLAND PROTECTION ACT

In accordance with the second paragraph of Massachusetts General Laws, Chapter 131, 40, you are hereby notified of the following work within the 100' buffer zone of a wetland:

- A. The name of the applicant is: William & Pamela Keyes
- B. The address of the lot where the activity is proposed is: 25 Lakeview Drive
- C. The applicant has filed a X Notice of Intent or a      Request of Determination with the Leicester Conservation Commission seeking permission to remove, fill, dredge or alter an Area Subject to Protection under the Wetland Protection Act (MGL c. 131, 40).
- D. Copies of the application may be examined at the office of the Leicester Conservation Commission, Town Hall, between the hours of 8:00 a.m and 3:00 p.m. Monday through Thursday. Telephone is (508) 892-7008. Additional times are available by appointment.
- E. Copies of the application may be obtained from either the      applicant, or X the applicant's representative, by calling this telephone number (508) 769-6659 on Monday – Friday between the hours of 8:00 a.m. and 4:00 p.m. There is a \$5.00 fee for copies.
- F. Information regarding the date, time and place of the public hearing may be obtained from the Leicester Conservation Commission. If available from the applicant, check here X and see the information available in # E. By calling (508) 892-7008

NOTE: At least five days in advance, notice of the Public hearing will be published in a newspaper of general circulation. The notice will include the hearing date, time and place, Notice of the Public Hearing will be posted in the Town Hall not less than forty-eight (48) hours in advance.

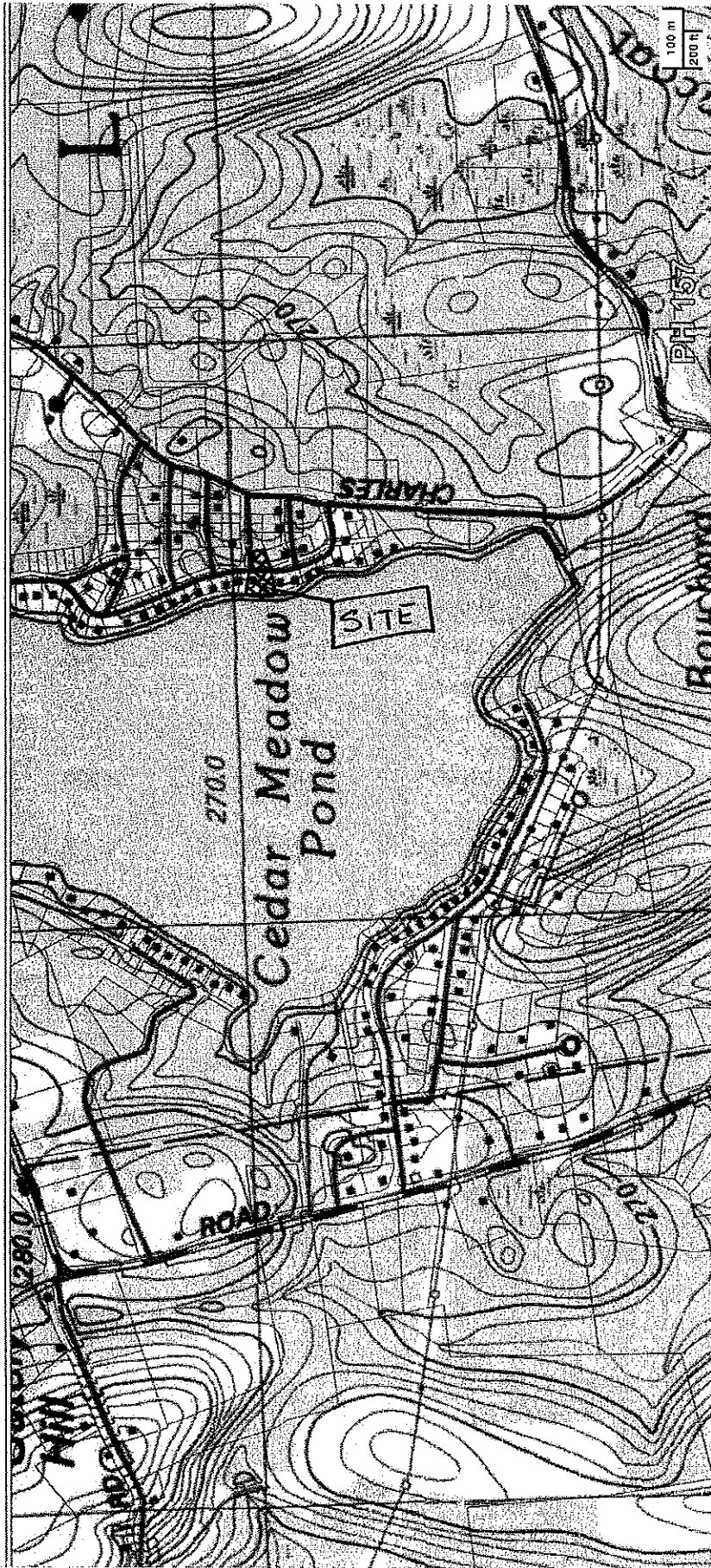



Massachusetts Department of Environmental Protection  
Bureau of Resource Protection - Wetlands  
**NOI Wetland Fee Transmittal Form**  
Massachusetts Wetlands Protection Act M.G.L. c. 131, §40

**Important:** When filling out forms on the computer, use only the tab key to move your cursor - do not use the return key.



## A. Applicant Information

### 1. Location of Project:

25 Lakeview Drive

a. Street Address

Leicester

b. City/Town

c. Check number

d. Fee amount

### 2. Applicant Mailing Address:

William & Pamela

a. First Name

Keyes

b. Last Name

c. Organization

8 Sherry Lane

d. Mailing Address

Spencer

e. City/Town

MA

f. State

01562

g. Zip Code

508.864.9708

h. Phone Number

i. Fax Number

pavekb@charter.net

j. Email Address

### 3. Property Owner (if different):

a. First Name

b. Last Name

c. Organization

d. Mailing Address

e. City/Town

f. State

g. Zip Code

h. Phone Number

i. Fax Number

j. Email Address

## B. Fees

To calculate filing fees, refer to the category fee list and examples in the instructions for filling out WPA Form 3 (Notice of Intent).

Fee should be calculated using the following process & worksheet. ***Please see Instructions before filling out worksheet.***

**Step 1/Type of Activity:** Describe each type of activity that will occur in wetland resource area and buffer zone.

**Step 2/Number of Activities:** Identify the number of each type of activity.

**Step 3/Individual Activity Fee:** Identify each activity fee from the six project categories listed in the instructions.

**Step 4/Subtotal Activity Fee:** Multiply the number of activities (identified in Step 2) times the fee per category (identified in Step 3) to reach a subtotal fee amount. Note: If any of these activities are in a Riverfront Area in addition to another Resource Area or the Buffer Zone, the fee per activity should be multiplied by 1.5 and then added to the subtotal amount.

**Step 5/Total Project Fee:** Determine the total project fee by adding the subtotal amounts from Step 4.

**Step 6/Fee Payments:** To calculate the state share of the fee, divide the total fee in half and subtract \$12.50. To calculate the city/town share of the fee, divide the total fee in half and add \$12.50.



Massachusetts Department of Environmental Protection  
Bureau of Resource Protection - Wetlands  
**NOI Wetland Fee Transmittal Form**  
Massachusetts Wetlands Protection Act M.G.L. c. 131, §40

**B. Fees** (continued)

Step 1/Type of Activity	Step 2/Number of Activities	Step 3/Individual Activity Fee	Step 4/Subtotal Activity Fee
Cat 1	2	\$220.00	\$220.00

**Step 5/Total Project Fee:** \$220.00

**Step 6/Fee Payments:**

Total Project Fee:	<u>\$220.00</u>
	a. Total Fee from Step 5
State share of filing Fee:	<u>\$97.50</u>
	b. 1/2 Total Fee less \$12.50
City/Town share of filing Fee:	<u>\$122.50</u>
	c. 1/2 Total Fee plus \$12.50

**C. Submittal Requirements**

- a.) Complete pages 1 and 2 and send with a check or money order for the state share of the fee, payable to the Commonwealth of Massachusetts.

Department of Environmental Protection  
Box 4062  
Boston, MA 02211

- b.) **To the Conservation Commission:** Send the Notice of Intent or Abbreviated Notice of Intent; a **copy** of this form; and the city/town fee payment.

**To MassDEP Regional Office** (see Instructions): Send a copy of the Notice of Intent or Abbreviated Notice of Intent; a **copy** of this form; and a **copy** of the state fee payment. (E-filers of Notices of Intent may submit these electronically.)

RECEIVED  
2010 DEC 29 AM 11:02  
TOWN ENGINEERING  
LEICESTER, MASS

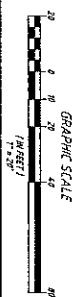
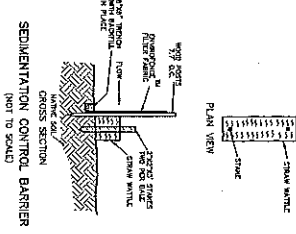
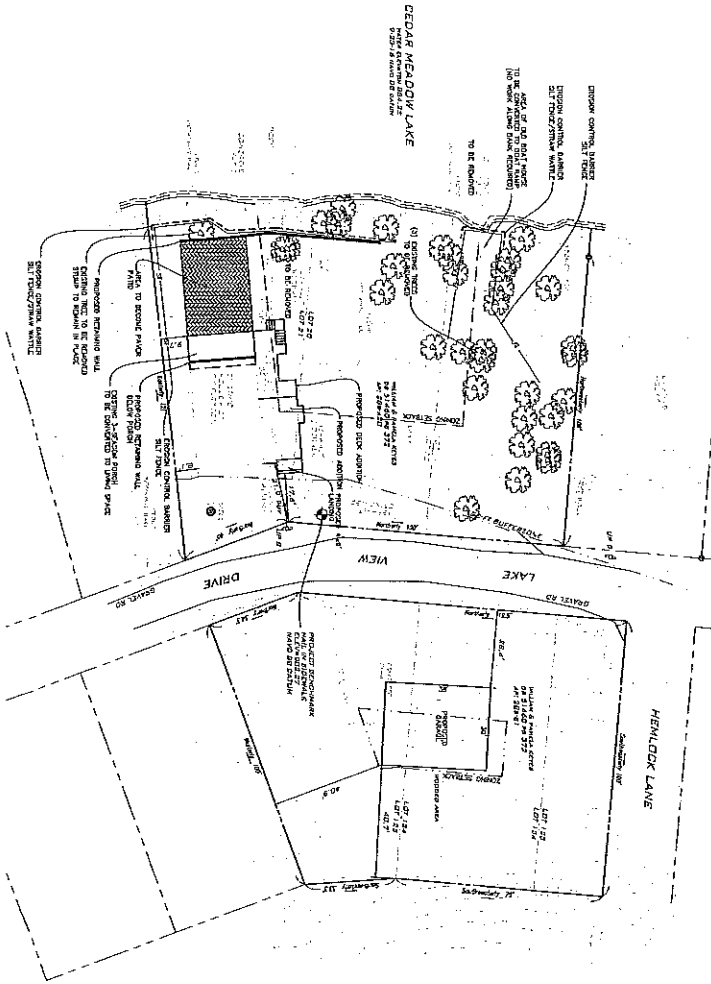
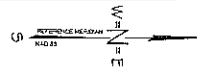

CLIENT: <b>WILLIAM &amp; PAMELA KEYES</b> 1 SHERRY LANE SPENCER, MASSACHUSETTS 01562				NO. 799-8888 508-541-2127		JEREMY & CROTEAU, P.L.C. PROFESSIONAL LANDSCAPE ARCHITECT MALE 000-0000		
PROJECT: <b>PROPOSED SITE PLAN</b> SITE ADDRESS: 25 LAKEVIEW DRIVE LEICESTER, MASSACHUSETTS		NORTH		NO. DATE		REVISION		
SCALE: 1"=20' DATE: 12-27-10 DRAWN BY: J.C.		REV. # 0		NO. DATE		REVISION		

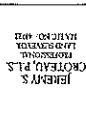

REVISOR

NORTH		NO.	DATE

1

[illegible]

	N
KEYES	

1 & PANEL  
2  
3  
4  
5  
6  
7  
8  
9  
10  
11  
12  
13  
14  
15  
16  
17  
18  
19  
20  
21  
22  
23  
24  
25  
26  
27  
28  
29  
30  
31  
32  
33  
34  
35  
36  
37  
38  
39  
40  
41  
42  
43  
44  
45  
46  
47  
48  
49  
50  
51  
52  
53  
54  
55  
56  
57  
58  
59  
60  
61  
62  
63  
64  
65  
66  
67  
68  
69  
70  
71  
72  
73  
74  
75  
76  
77  
78  
79  
80  
81  
82  
83  
84  
85  
86  
87  
88  
89  
90  
91  
92  
93  
94  
95  
96  
97  
98  
99  
100  
101  
102  
103  
104  
105  
106  
107  
108  
109  
110  
111  
112  
113  
114  
115  
116  
117  
118  
119  
120  
121  
122  
123  
124  
125  
126  
127  
128  
129  
130  
131  
132  
133  
134  
135  
136  
137  
138  
139  
140  
141  
142  
143  
144  
145  
146  
147  
148  
149  
150  
151  
152  
153  
154  
155  
156  
157  
158  
159  
160  
161  
162  
163  
164  
165  
166  
167  
168  
169  
170  
171  
172  
173  
174  
175  
176  
177  
178  
179  
180  
181  
182  
183  
184  
185  
186  
187  
188  
189  
190  
191  
192  
193  
194  
195  
196  
197  
198  
199  
200  
201  
202  
203  
204  
205  
206  
207  
208  
209  
210  
211  
212  
213  
214  
215  
216  
217  
218  
219  
220  
221  
222  
223  
224  
225  
226  
227  
228  
229  
230  
231  
232  
233  
234  
235  
236  
237  
238  
239  
240  
241  
242  
243  
244  
245  
246  
247  
248  
249  
250  
251  
252  
253  
254  
255  
256  
257  
258  
259  
260  
261  
262  
263  
264  
265  
266  
267  
268  
269  
270  
271  
272  
273  
274  
275  
276  
277  
278  
279  
280  
281  
282  
283  
284  
285  
286  
287  
288  
289  
290  
291  
292  
293  
294  
295  
296  
297  
298  
299  
300  
301  
302  
303  
304  
305  
306  
307  
308  
309  
310  
311  
312  
313  
314  
315  
316  
317  
318  
319  
320  
321  
322  
323  
324  
325  
326  
327  
328  
329  
330  
331  
332  
333  
334  
335  
336  
337  
338  
339  
340  
341  
342  
343  
344  
345  
346  
347  
348  
349  
350  
351  
352  
353  
354  
355  
356  
357  
358  
359  
360  
361  
362  
363  
364  
365  
366  
367  
368  
369  
370  
371  
372  
373  
374  
375  
376  
377  
378  
379  
380  
381  
382  
383  
384  
385  
386  
387  
388  
389  
390  
391  
392  
393  
394  
395  
396  
397  
398  
399  
400  
401  
402  
403  
404  
405  
406  
407  
408  
409  
410  
411  
412  
413  
414  
415  
416  
417  
418  
419  
420  
421  
422  
423  
424  
425  
426  
427  
428  
429  
430  
431  
432  
433  
434  
435  
436  
437  
438  
439  
440  
441  
442  
443  
444  
445  
446  
447  
448  
449  
450  
451  
452  
453  
454  
455  
456  
457  
458  
459  
460  
461  
462  
463  
464  
465  
466  
467  
468  
469  
470  
471  
472  
473  
474  
475  
476  
477  
478  
479  
480  
481  
482  
483  
484  
485  
486  
487  
488  
489  
490  
491  
492  
493  
494  
495  
496  
497  
498  
499  
500  
501  
502  
503  
504  
505  
506  
507  
508  
509  
510  
511  
512  
513  
514  
515  
516  
517  
518  
519  
520  
521  
522  
523  
524  
525  
526  
527  
528  
529  
530  
531  
532  
533  
534  
535  
536  
537  
538  
539  
540  
541  
542  
543  
544  
545  
546  
547  
548  
549  
550  
551  
552  
553  
554  
555  
556  
557  
558  
559  
560  
561  
562  
563  
564  
565  
566  
567  
568  
569  
570  
571  
572  
573  
574  
575  
576  
577  
578  
579  
580  
581  
582  
583  
584  
585  
586  
587  
588  
589  
590  
591  
592  
593  
594  
595  
596  
597  
598  
599  
600  
601  
602  
603  
604  
605  
606  
607  
608  
609  
610  
611  
612  
613  
614  
615  
616  
617  
618  
619  
620  
621  
622  
623  
624  
625  
626  
627  
628  
629  
630  
631  
632  
633  
634  
635  
636  
637  
638  
639  
640  
641  
642  
643  
644  
645  
646  
647  
648  
649  
650  
651  
652  
653  
654  
655  
656  
657  
658  
659  
660  
661  
662  
663  
664  
665  
666  
667  
668  
669  
670  
671  
672  
673  
674  
675  
676  
677  
678  
679  
680  
681  
682  
683  
684  
685  
686  
687  
688  
689  
690  
691  
692  
693  
694  
695  
696  
697  
698  
699  
700  
701  
702  
703  
704  
705  
706  
707  
708  
709  
710  
711  
712  
713  
714  
715  
716  
717  
718  
719  
720  
721  
722  
723  
724  
725  
726  
727  
728  
729  
730  
731  
732  
733  
734  
735  
736  
737  
738  
739  
740  
741  
742  
743  
744  
745  
746  
747  
748  
749  
750  
751  
752  
753  
754  
755  
756  
757  
758  
759  
760  
761  
762  
763  
764  
765  
766  
767  
768  
769  
770  
771  
772  
773  
774  
775  
776  
777  
778  
779  
780  
781  
782  
783  
784  
785  
786  
787  
788  
789  
790  
791  
792  
793  
794  
795  
796  
797  
798  
799  
800  
801  
802  
803  
804  
805  
806  
807  
808  
809  
810  
811  
812  
813  
814  
815  
816  
817  
818  
819  
820  
821  
822  
823  
824  
825  
826  
827  
828  
829  
830  
831  
832  
833  
834  
835  
836  
837  
838  
839  
840

WILLIAM  
8 SHEARY LANE  
SPENCER, MA 01061  
EXISTING SITE ADDRESS  
25 LAKEVIEW  
LODGE, W. MA 01061

JDD	SCALE: 1"=20'	0
DATE: 12-27-16	PROJECT #: 16-157	EX

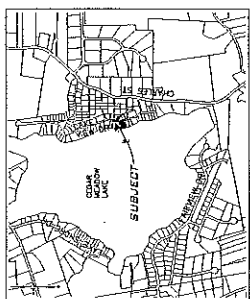

SCALE: 1"=100'

TAX MAP REFERENCES:  
LOCATION: \_\_\_\_\_  
LOCATION ASSIGNMENT: \_\_\_\_\_  
TAX MAP 288-420

RECORD OWNERS  
OWNER: \_\_\_\_\_  
DB 51463 PG 372

REL: \_\_\_\_\_

PLAN REFERENCES  
WHOLECOT COUNTY (CITY OF DETROIT)  
PLAN BOOK 113 PLAN 71

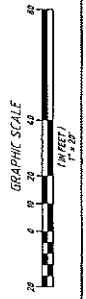
[illegible]

RECEIVED  
2016 DEC 29 AM 11:02  
FBI - NEW YORK  
COMMUNICATIONS SECTION

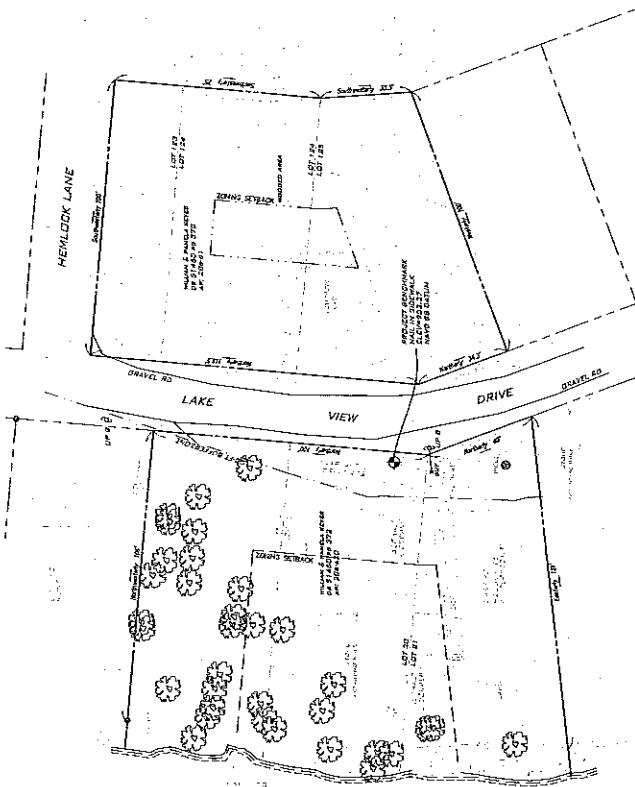

CEDAR MEADOW LAKE  
WATER QUALITY DATA, 1984  
8-22-86 NADROD DRYUM

DISTRICT DIMENSIONAL REGULATIONS	
District	SA
Min. Lot Area	\$0,000 sq.ft.
Min. Lot Frontage	200'
Min. Front Setback	40'
Min. Side Setback	40'
Min. Rear Setback	40'

SYMBOL KEY		SYMBOL KEY	
1	CHART LINE FORCE	1	CHART LINE FORCE
2	NOSE / STOMACH FORCE	2	NOSE / STOMACH FORCE
3	HEAD FORCE	3	HEAD FORCE
4	NECK FORCE	4	NECK FORCE
5	SHOULDER FORCE	5	SHOULDER FORCE
6	ELBOW FORCE	6	ELBOW FORCE
7	Wrist Force	7	Wrist Force
8	Forearm Force	8	Forearm Force
9	Upper Arm Force	9	Upper Arm Force
10	Lower Arm Force	10	Lower Arm Force
11	Hand Force	11	Hand Force
12	Finger Force	12	Finger Force
13	Thumb Force	13	Thumb Force
14	Index Force	14	Index Force
15	Middle Force	15	Middle Force
16	Ring Force	16	Ring Force
17	Pinky Force	17	Pinky Force
18	Wrist Flexion	18	Wrist Flexion
19	Wrist Extension	19	Wrist Extension
20	Forearm Flexion	20	Forearm Flexion
21	Forearm Extension	21	Forearm Extension
22	Upper Arm Flexion	22	Upper Arm Flexion
23	Upper Arm Extension	23	Upper Arm Extension
24	Lower Arm Flexion	24	Lower Arm Flexion
25	Lower Arm Extension	25	Lower Arm Extension
26	Hand Flexion	26	Hand Flexion
27	Hand Extension	27	Hand Extension
28	Finger Flexion	28	Finger Flexion
29	Finger Extension	29	Finger Extension
30	Thumb Flexion	30	Thumb Flexion
31	Thumb Extension	31	Thumb Extension
32	Index Flexion	32	Index Flexion
33	Index Extension	33	Index Extension
34	Middle Flexion	34	Middle Flexion
35	Middle Extension	35	Middle Extension
36	Ring Flexion	36	Ring Flexion
37	Ring Extension	37	Ring Extension
38	Pinky Flexion	38	Pinky Flexion
39	Pinky Extension	39	Pinky Extension
40	Wrist Flexion	40	Wrist Flexion
41	Wrist Extension	41	Wrist Extension
42	Forearm Flexion	42	Forearm Flexion
43	Forearm Extension	43	Forearm Extension
44	Upper Arm Flexion	44	Upper Arm Flexion
45	Upper Arm Extension	45	Upper Arm Extension
46	Lower Arm Flexion	46	Lower Arm Flexion
47	Lower Arm Extension	47	Lower Arm Extension
48	Hand Flexion	48	Hand Flexion
49	Hand Extension	49	Hand Extension
50	Finger Flexion	50	Finger Flexion
51	Finger Extension	51	Finger Extension
52	Thumb Flexion	52	Thumb Flexion
53	Thumb Extension	53	Thumb Extension
54	Index Flexion	54	Index Flexion
55	Index Extension	55	Index Extension
56	Middle Flexion	56	Middle Flexion
57	Middle Extension	57	Middle Extension
58	Ring Flexion	58	Ring Flexion
59	Ring Extension	59	Ring Extension
60	Pinky Flexion	60	Pinky Flexion
61	Pinky Extension	61	Pinky Extension
62	Wrist Flexion	62	Wrist Flexion
63	Wrist Extension	63	Wrist Extension
64	Forearm Flexion	64	Forearm Flexion
65	Forearm Extension	65	Forearm Extension
66	Upper Arm Flexion	66	Upper Arm Flexion
67	Upper Arm Extension	67	Upper Arm Extension
68	Lower Arm Flexion	68	Lower Arm Flexion
69	Lower Arm Extension	69	Lower Arm Extension
70	Hand Flexion	70	Hand Flexion
71	Hand Extension	71	Hand Extension
72	Finger Flexion	72	Finger Flexion
73	Finger Extension	73	Finger Extension
74	Thumb Flexion	74	Thumb Flexion
75	Thumb Extension	75	Thumb Extension
76	Index Flexion	76	Index Flexion
77	Index Extension	77	Index Extension
78	Middle Flexion	78	Middle Flexion
79	Middle Extension	79	Middle Extension
80	Ring Flexion	80	Ring Flexion
81	Ring Extension	81	Ring Extension
82	Pinky Flexion	82	Pinky Flexion
83	Pinky Extension	83	Pinky Extension
84	Wrist Flexion	84	Wrist Flexion
85	Wrist Extension	85	Wrist Extension
86	Forearm Flexion	86	Forearm Flexion
87	Forearm Extension	87	Forearm Extension
88	Upper Arm Flexion	88	Upper Arm Flexion
89	Upper Arm Extension	89	Upper Arm Extension
90	Lower Arm Flexion	90	Lower Arm Flexion
91	Lower Arm Extension	91	Lower Arm Extension
92	Hand Flexion	92	Hand Flexion
93	Hand Extension	93	Hand Extension
94	Finger Flexion	94	Finger Flexion
95	Finger Extension	95	Finger Extension
96	Thumb Flexion	96	Thumb Flexion
97	Thumb Extension	97	Thumb Extension
98	Index Flexion	98	Index Flexion
99	Index Extension	99	Index Extension
100	Middle Flexion	100	Middle Flexion